

Base from U.S. Geological Survey, 1963

SCALE 1:250000

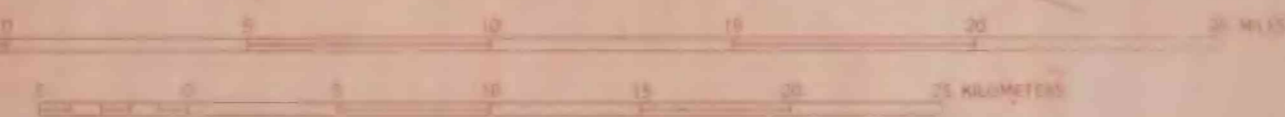

CONTOUR INTERVAL 200 FEET
DOTTER LINES REPRESENT 100-FOOT CONTOURS
DATUM IS MEAN SEA LEVEL
DEPTH CURVES AND SOUNDINGS IN FEET - DATUM IS MEAN LOWER LOW WATER
SHORING SHOWS APPROXIMATE THE APPROXIMATE LINE OF HIGH TIDE WATER
1964 MAGNETIC DECLINATION AT SOUTH EDGE OF SHEET VARIES FROM 18°30' TO 19°30' EAST

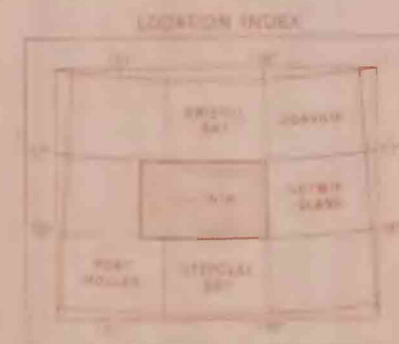

Geochemical samples collected during
the 1977 and 1978 field seasons by
D.E. Detra, C.D. Halloway, D.R. Jefferis,
and M.E. Yount

Plate 1.- Map showing stream-sediment and heavy-mineral-concentrate sample sites, Chignik quadrangle, Alaska