

EXPLANATION

 NON-FEDERAL COAL LAND—Coal tonnages not evaluated.

RB (Measured)
1.42 (Indicated)
3.34 (Inferred)
0.76

IDENTIFIED RESOURCES OF COAL BED—In millions of short tons. Dash indicates no resources in that category. Reserve Base (RB) x the recovery factor (95%) = Reserves (R).

To convert short tons to metric tonnes, multiply short tons by 0.9072.

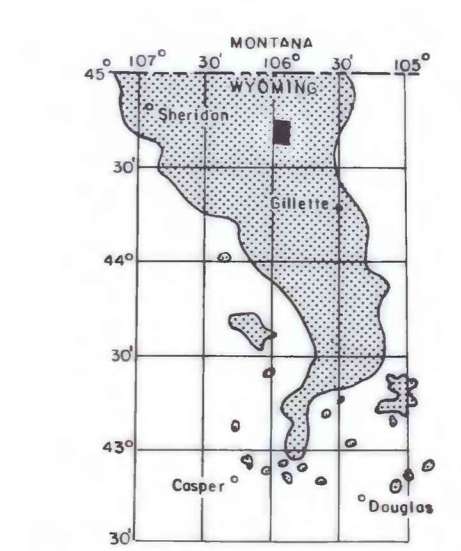
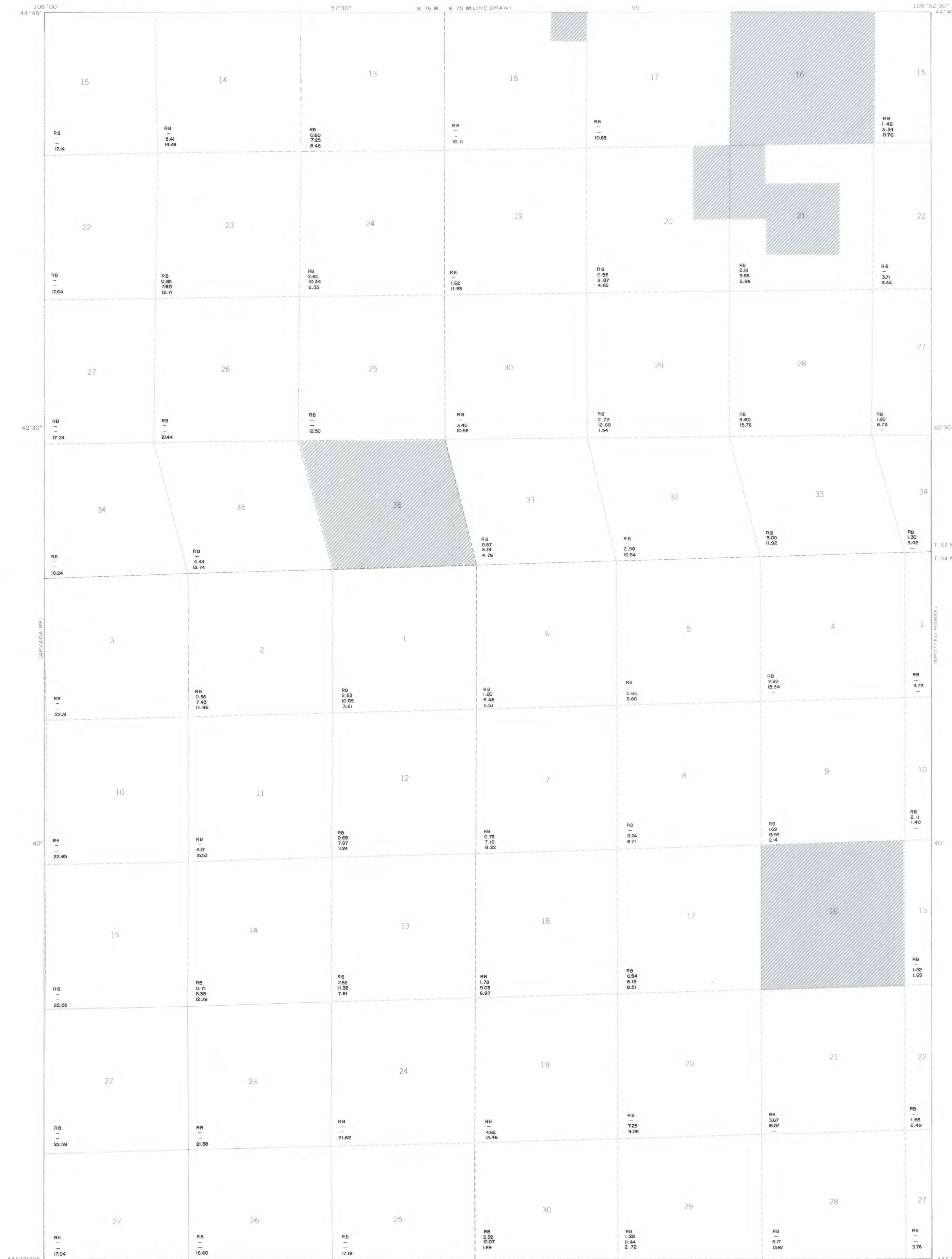

This report has not been edited for conformity with U.S. Geological Survey editorial standards or stratigraphic nomenclature.

Compiled in 1978

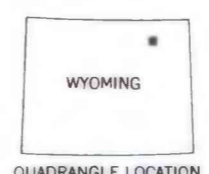
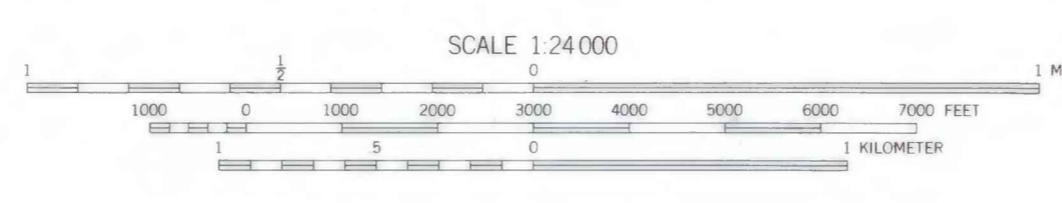
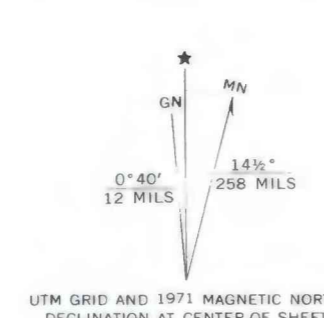

COAL RESOURCE OCCURRENCE MAP OF THE LAREY DRAW QUADRANGLE, CAMPBELL COUNTY, WYOMING

BY
IntraSearch
1978