

RESERVOIR CREEK
44°37'30" N
105°37'30" W

UNITED STATES
DEPARTMENT OF THE INTERIOR
GEOLOGICAL SURVEY

RECLUSE QUADRANGLE
WYOMING—CAMPBELL CO.
7.5 MINUTE SERIES (TOPOGRAPHIC)

OPEN FILE REPORT 79-025
PLATE 44 OF 44

EXPLANATION



NON-FEDERAL COAL LAND—Coal
development potential is
not rated.

AREA OF HIGH COAL DEVELOPMENT
POTENTIAL FOR SURFACE MINING
METHODS—Area has mining ratio
values ranging from 0 to 10.

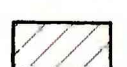

AREA OF MODERATE COAL DEVELOPMENT
POTENTIAL FOR SURFACE MINING
METHODS—Area has mining ratio
values ranging from 10 to 15.

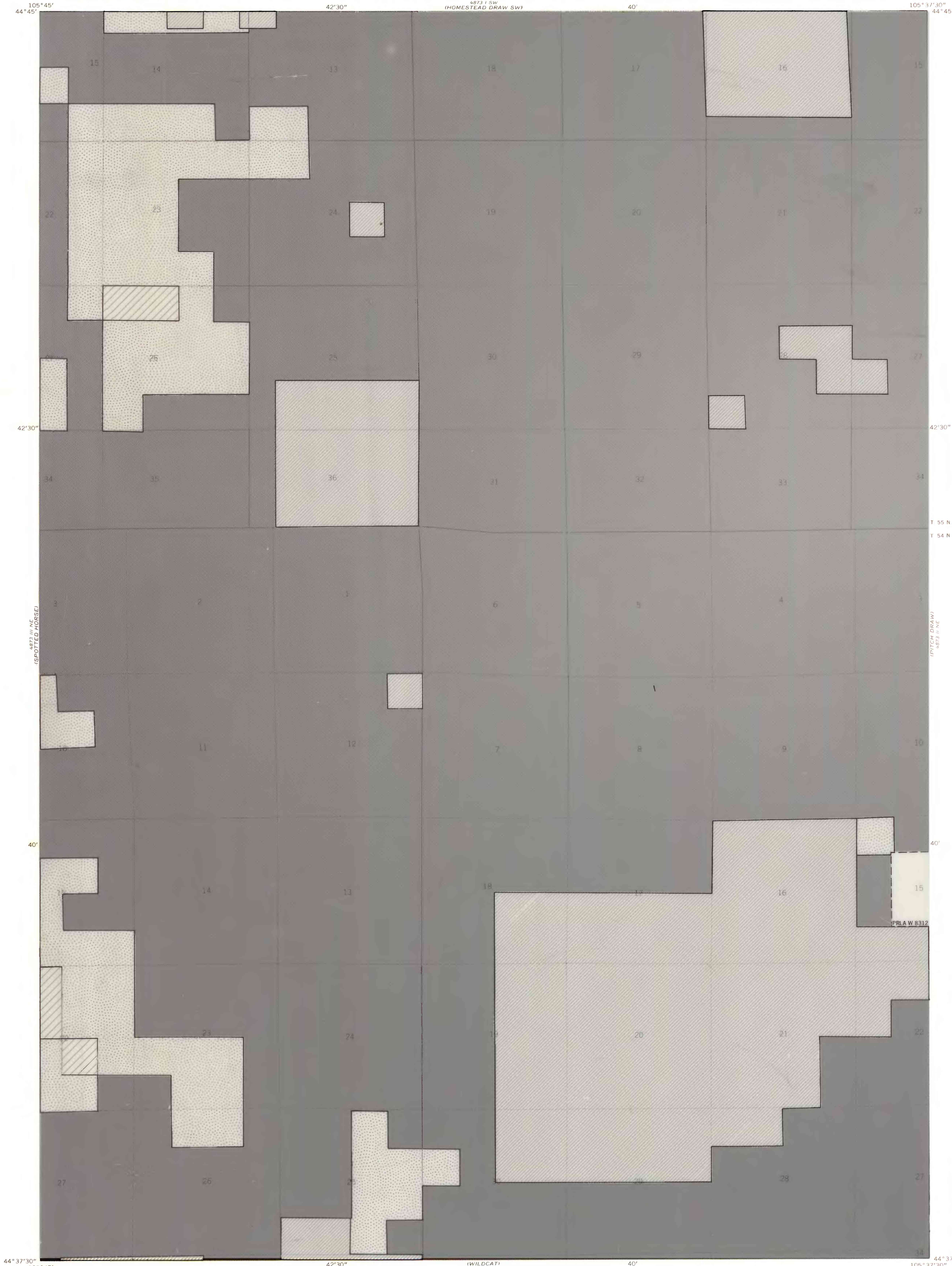
AREA OF LOW COAL DEVELOPMENT
POTENTIAL FOR SURFACE MINING
METHODS—Area has mining ratio
values greater than 15

PREFERENCE RIGHT LEASE
APPLICATION—PRLA

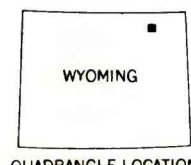
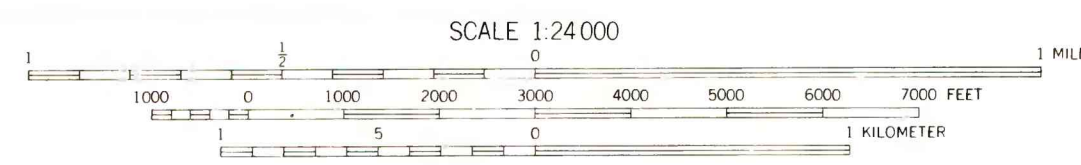
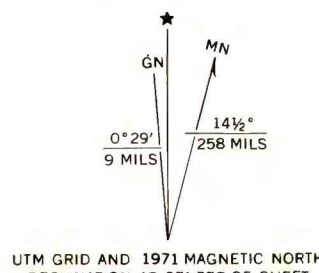

TRUMAN DRAW
44°37'30" N
105°37'30" W



COAL CREEK
44°37'30" N
105°37'30" W

This report has not been edited
for conformity with U.S. Geological
Survey editorial standards or
stratigraphic nomenclature.

COAL DEVELOPMENT POTENTIAL MAP OF THE RECLUSE
QUADRANGLE, CAMPBELL COUNTY, WYOMING

BY
IntraSearch
1978

PLATE 44
COAL DEVELOPMENT POTENTIAL
FOR SURFACE MINING METHODS