

EXPLANATION

 NON-FEDERAL COAL LAND-Coal tonnages not evaluated.

 KRCRA
KNOWN RECOVERABLE COAL RESOURCE AREA-KRCRA

RB
14.98 (Measured)
38.87 (Indicated)
11.04 (Inferred)

IDENTIFIED RESOURCES OF COAL BED-
In millions of short tons. Dash indicates no resources in that category.

To convert short tons to metric tons multiply short tons by 0.9072.

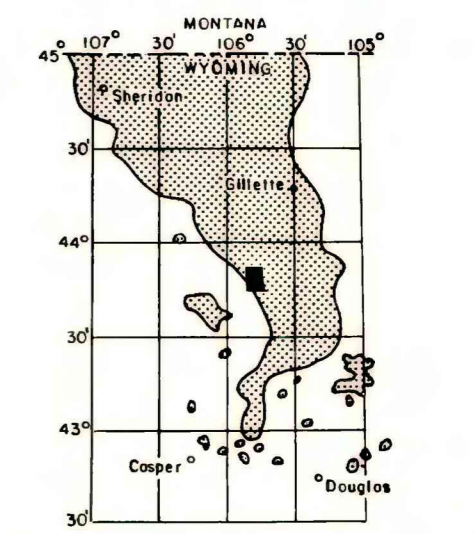
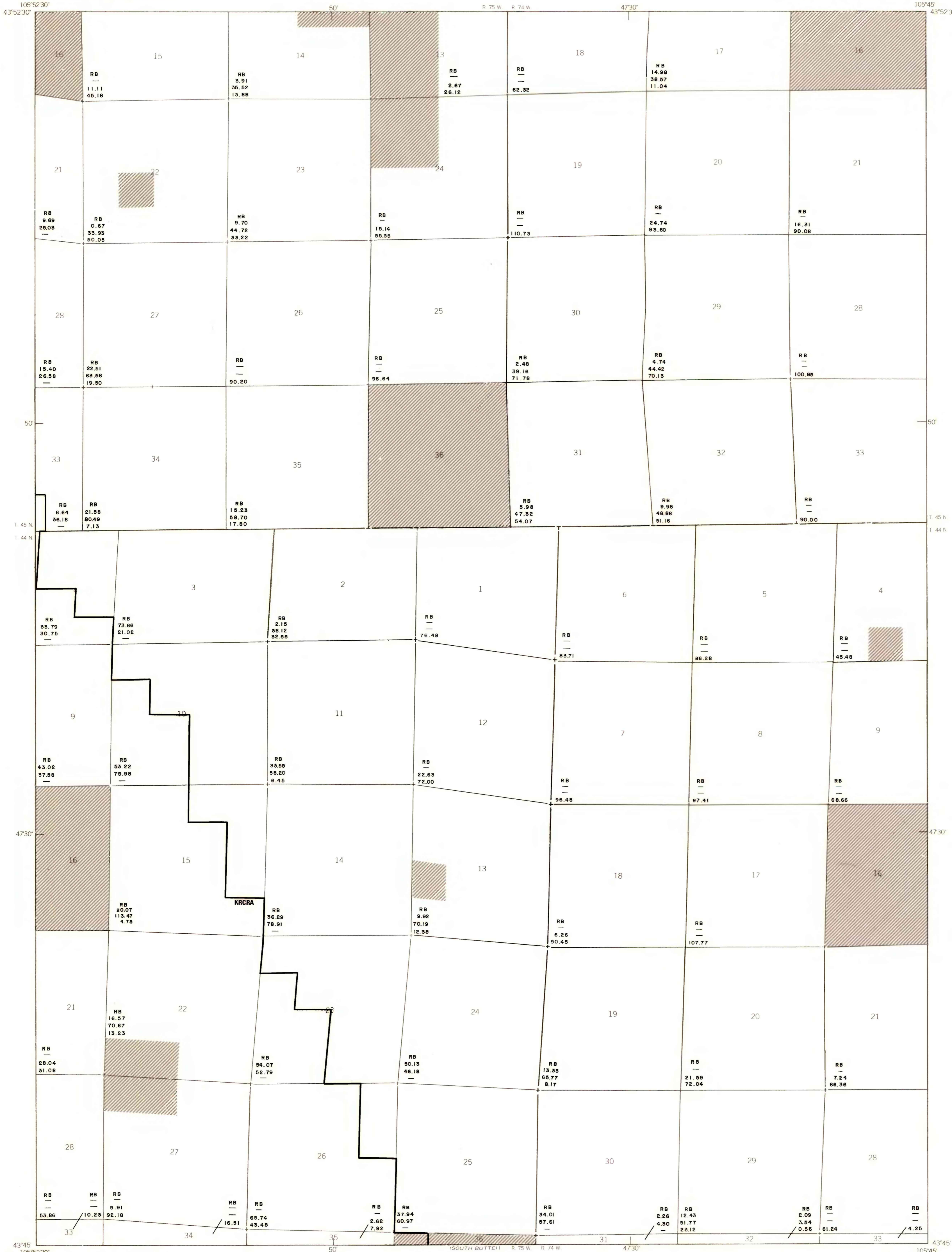

MAP SHOWING LOCATION OF THE SAVAGETON 7 1/2 QUADRANGLE AND THE POWDER RIVER BASIN KNOWN RECOVERABLE COAL RESOURCE AREA (STIPPLED), WYOMING

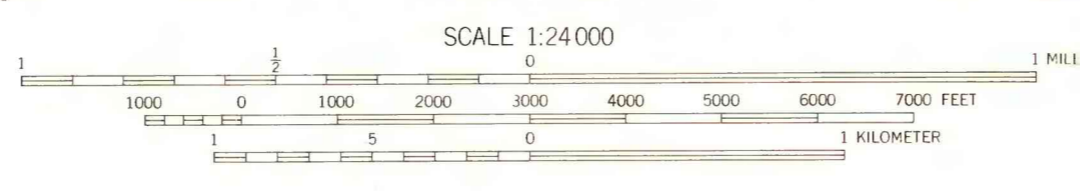

COAL RESOURCE OCCURRENCE MAP OF THE SAVAGETON 7 1/2 QUADRANGLE, CAMPBELL COUNTY, WYOMING

BY
IntraSearch
1979

PLATE 18
IDENTIFIED RESOURCES OF
WYODAK COAL ZONE

This report has not been edited for conformity with U.S. Geological Survey editorial standards or cartographic nomenclature.

ROLLING PIN RANCH

Base from U.S. Geological Survey, 1953

Compiled in 1979