

EXPLANATION

—2000—
OVERBURDEN ISOPACH—Showing thick-
ness of overburden, in feet,
from the surface to the top of
the coal bed. Isopach interval
250 feet.

● 1805
● 377
DRILL HOLE—Showing thickness of
overburden, in feet, from the
surface to top of coal bed.
Lower number indicates interburden
thickness, in feet, between upper
and lower splits of coal bed.

To convert feet to meters
multiply feet by 0.3048

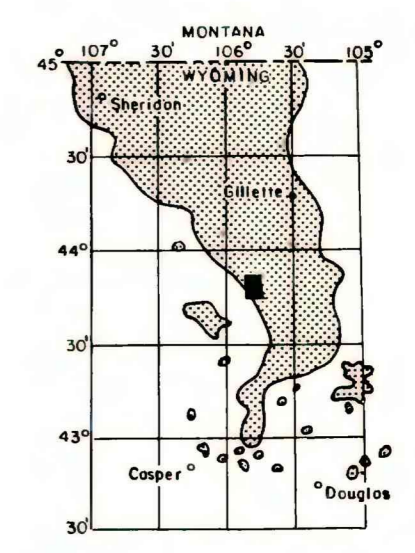
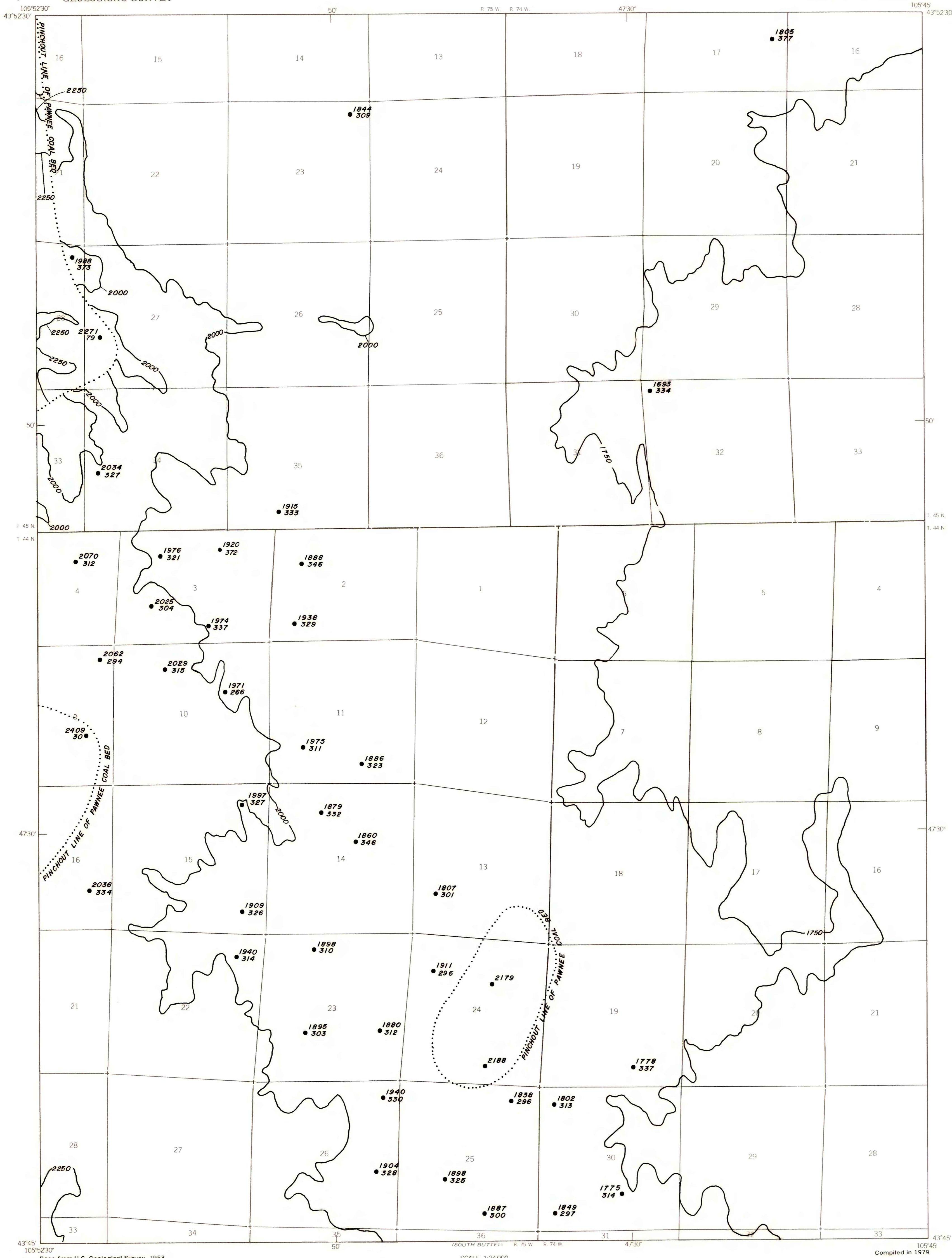

MAP SHOWING LOCATION OF THE
SAVAGETON 7 1/2' QUADRANGLE AND
THE POWDER RIVER BASIN KNOWN
RECOVERABLE COAL RESOURCE
AREA (STIPPLED), WYOMING

This report has not been edited
for conformity with U.S. Geological
Survey editorial standards or
cartographic nomenclature.

**COAL RESOURCE OCCURRENCE MAP OF THE SAVAGETON 7 1/2'
QUADRANGLE, CAMPBELL COUNTY, WYOMING**

BY
IntraSearch
1979

PLATE 21
ISOPACH MAP OF
OVERBURDEN OF
PAWNEE-WILDCAT-MOYER
COAL ZONE

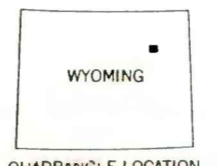
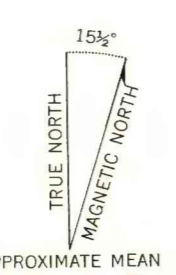
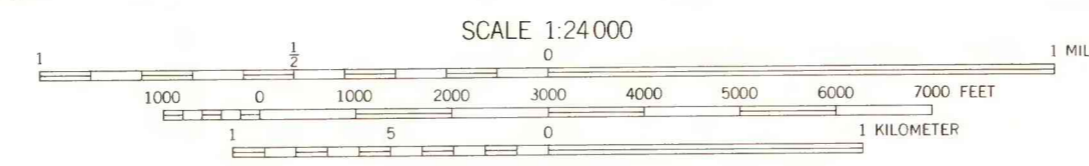

Base from U.S. Geological Survey, 1953

Compiled in 1979