

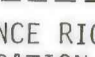

EXPLANATION

 NON-FEDERAL COAL LAND-Coal tonnages not evaluated.

 PREFERENCE RIGHT LEASE APPLICATION-PRLA

 KNOWN RECOVERABLE COAL RESOURCE AREA-KRCRA

IDENTIFIED RESOURCES OF COAL BED- In millions of short tons. Dash indicates no resources in that category. Reserve Base (RB) X the recovery factor (95%) = Reserves (R).

RB	R(95%)	
0.27	0.25	(Measured)
3.04	2.88	(Indicated)
0.88	0.83	(Inferred)

To convert short tons to metric tons multiply short tons by 0.9072.

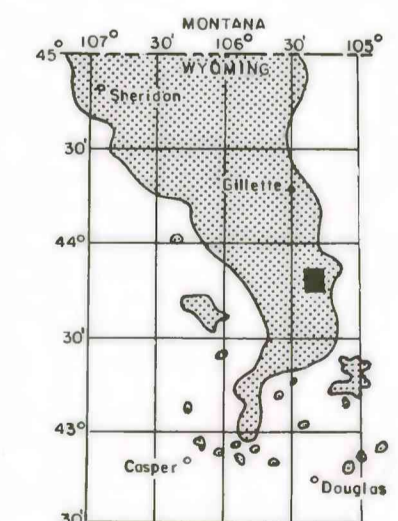
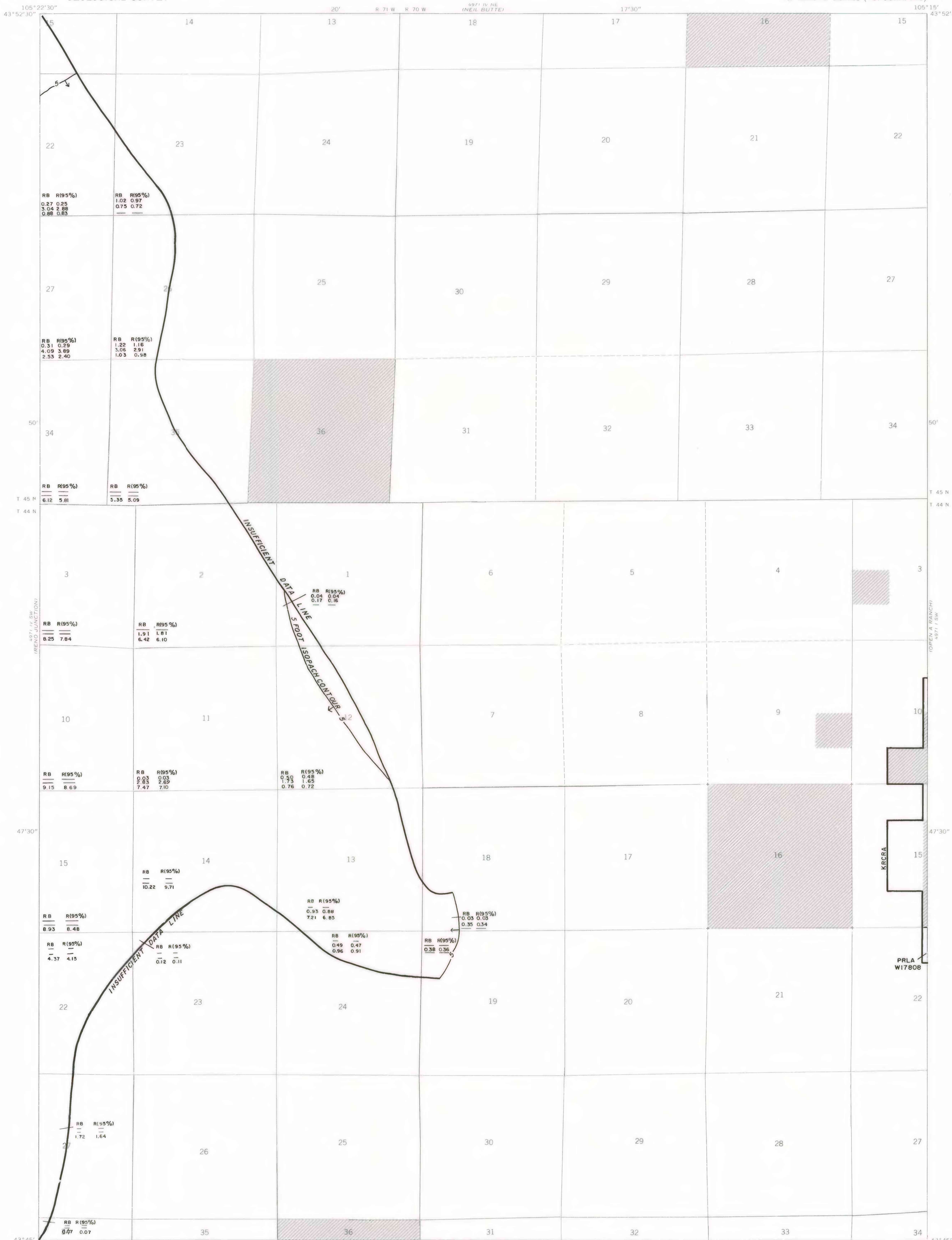

MAP SHOWING LOCATION OF THE HILIGHT QUADRANGLE AND THE POWDER RIVER BASIN KNOWN RECOVERABLE COAL RESOURCE AREA (STIPPLED), WYOMING

LITTLE TRAILER RESERVOIR

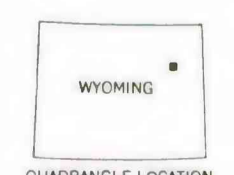
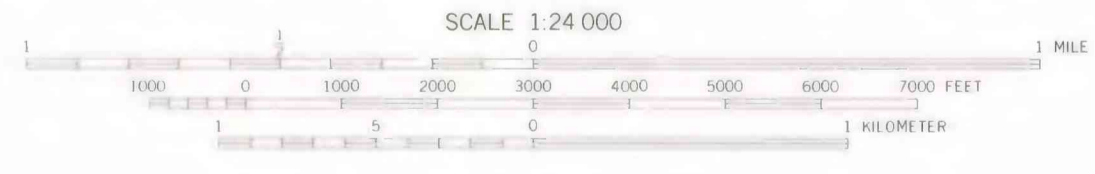
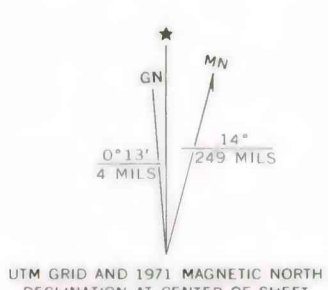

COAL RESOURCE OCCURRENCE MAP OF THE HILIGHT QUADRANGLE, CAMPBELL COUNTY, WYOMING

BY  
IntraSearch  
1979

PLATE 8  
IDENTIFIED RESOURCES OF  
SMITH COAL BED

This report has not been edited for conformity with U.S. Geological Survey editorial standards or stratigraphic nomenclature.