

This report has not been edited for conformity with U.S. Geological Survey editorial standards or stratigraphic nomenclature.

EXPLANATION

ISOPACHS OF THE COAL BED—Showing thickness, in feet. Dashed where projected beyond boundary of coal. Isopach interval 1 foot.

STRUCTURE CONTOURS—Drawn on the top of the coal bed. Dashed where projected beyond boundary of coal. Hachures indicate a closed depression. Contour interval 20 feet (6.1 m). Datum is mean sea level.

BOUNDARY OF COAL DEPOSIT—Drawn along the outcrop of coal bed and/or the contact between burned and unburned coal (dashed where inferred by present author beyond the limits of original data). Arrows point toward coal-bearing area. Numbers at triangle are coal bed thickness and altitude at the top of the coal bed, measured in feet.

To convert feet to meters, multiply feet by 0.3048.

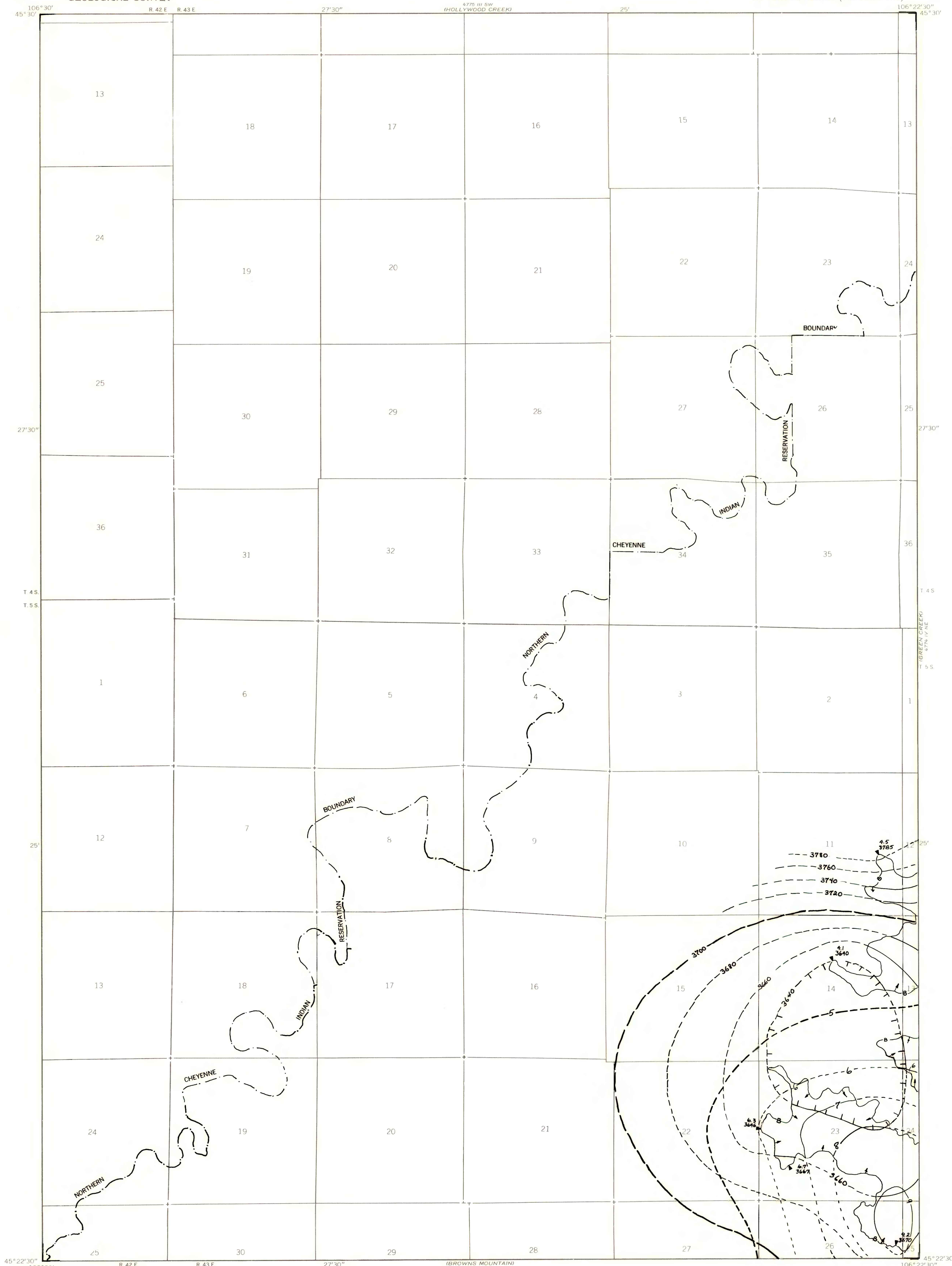

Base map from U.S. Geological Survey, 1966

Compiled in 1977

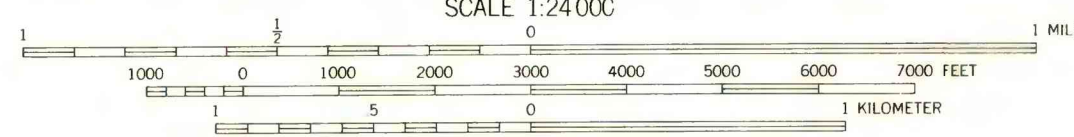
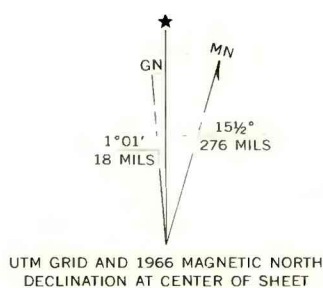

**COAL RESOURCE OCCURRENCE MAP OF THE BIRNEY DAY SCHOOL  
QUADRANGLE, ROSEBUD COUNTY, MONTANA  
BY  
COLORADO SCHOOL OF MINES RESEARCH INSTITUTE  
1979**