

This report has not been edited for conformity with  
U.S. Geological Survey editorial standards or  
stratigraphic nomenclature.

EXPLANATION

10  
9

ISOPACHS OF THE COAL BED—Showing thickness, in  
feet. Isopach interval 1 foot.

2600  
2580

STRUCTURE CONTOURS—Drawn on the top of the coal  
bed. Contour interval 20 feet (6.1 m). Datum is mean sea  
level.

6  
2593

DRILL HOLE—Showing thickness and altitude at the top of  
the coal bed, in feet.

To convert feet to meters, multiply feet by 0.3048.

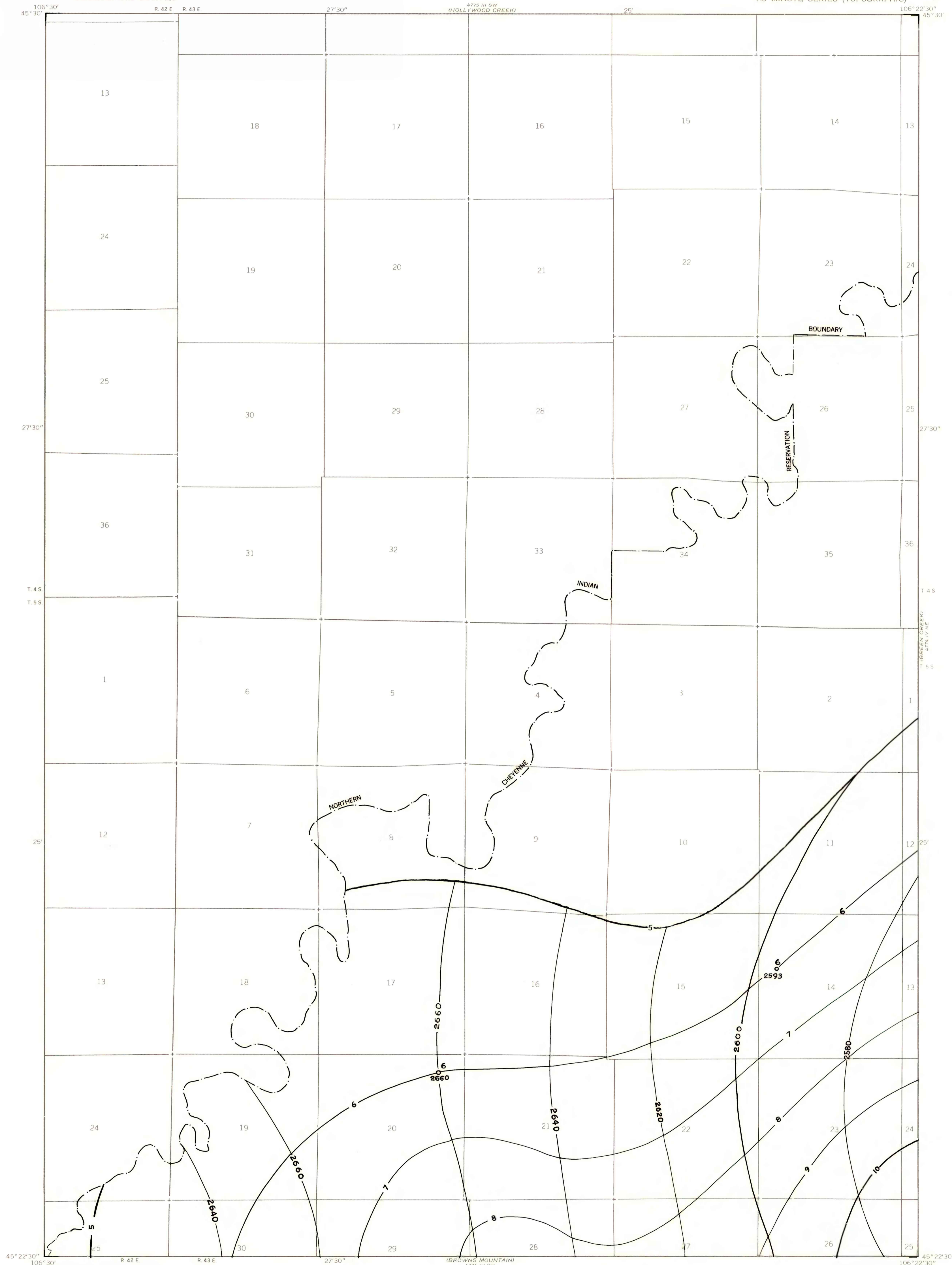

Base map from U.S. Geological Survey, 1966

Compiled in 1977

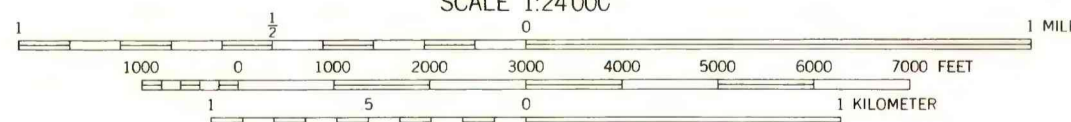
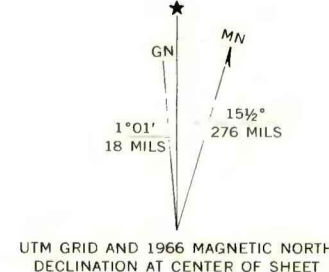

COAL RESOURCE OCCURRENCE MAP OF THE BIRNEY DAY SCHOOL  
QUADRANGLE, ROSEBUD COUNTY, MONTANA

BY  
COLORADO SCHOOL OF MINES RESEARCH INSTITUTE  
1979

PLATE 31  
ISOPACH AND STRUCTURE CONTOUR  
MAP OF THE TERRET COAL BED