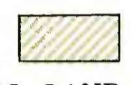
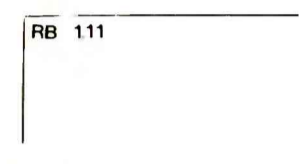

OPEN-FILE REPORT
This report has not been edited for conformity with
U.S. Geological Survey editorial standards or
stratigraphic nomenclature.

EXPLANATION

 **KRCRA**
BOUNDARY OF KNOWN RECOVERABLE COAL
RESOURCE AREA (KRCRA)—Area of KRCRA indi-
cated by label.

 **NON-FEDERAL COAL LAND**—Land for which the
Federal Government does not own the coal rights.

 **SECTION OF LAND**—Showing lots and lot numbers.

TOTAL RESERVE BASE (RB) OF COAL PER
SECTION—In millions of short tons, calculated for
each section of Federal land following the guidelines
given in U.S. Geol. Survey Bull. 1450-B (1976). To
convert short tons to metric tons, multiply short tons by
0.9072.

4	3	2	1
5	6		
6			
7			

SECTION OF LAND—Showing lots and lot numbers.

NOTE: BLM coal plat data indicating areas of coal ownership
current as of August 9, 1977.

REFERENCE

U.S. Bureau of Mines and U.S. Geological Survey, 1976, Coal
resource classification system of the U.S. Bureau of Mines
and U.S. Geological Survey: U.S. Geol. Survey Bull.
1450-B, 7 p.

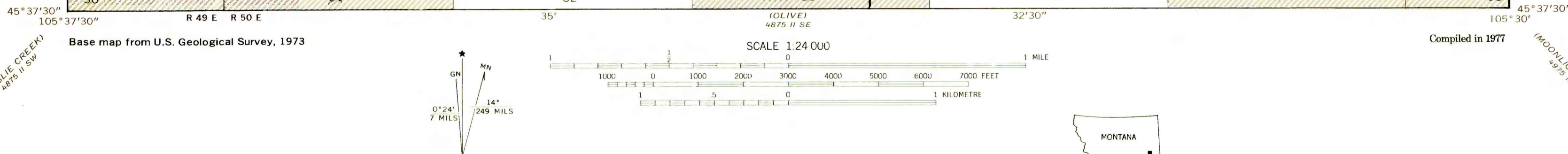
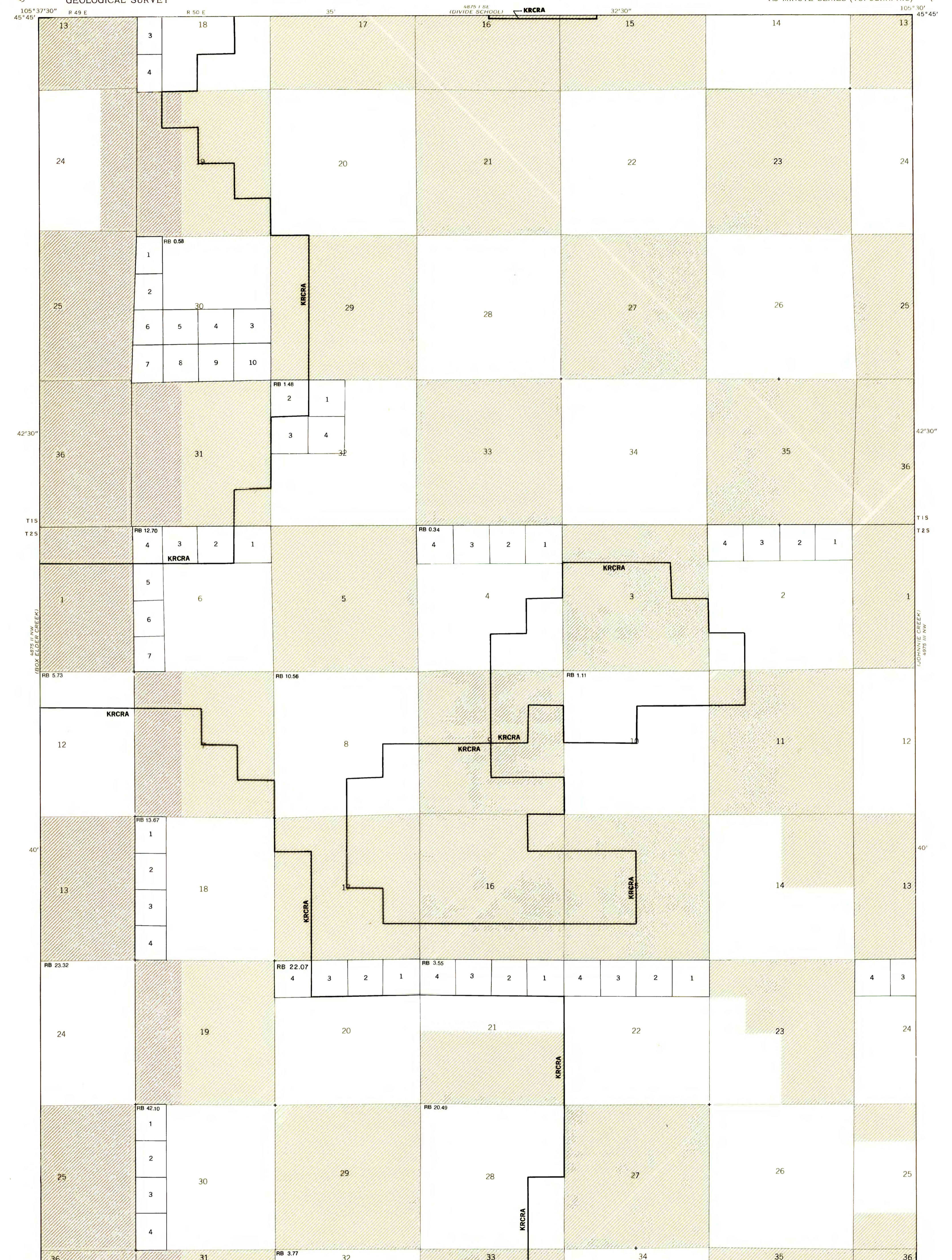

COAL RESOURCE OCCURRENCE MAP OF THE COALWOOD
QUADRANGLE, POWDER RIVER COUNTY, MONTANA
BY
COLORADO SCHOOL OF MINES RESEARCH INSTITUTE
1979