

OPEN-FILE REPORT  
This report has not been edited for conformity with  
U.S. Geological Survey editorial standards or  
stratigraphic nomenclature.

EXPLANATION

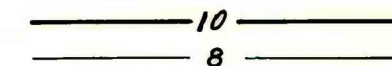

ISOPACHS OF THE COAL BED—Showing thickness, in feet. Isopach interval 2 feet, with an intermediate 5-foot isopach.

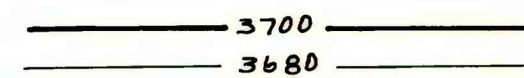

STRUCTURE CONTOURS—Drawn on the top of the coal bed. Dashed where projected beyond boundary of coal. Hachures indicate a closed depression. Contour interval 20 feet (6.1 m). Datum is mean sea level.

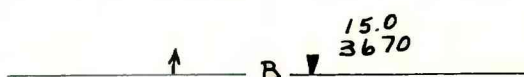

BOUNDARY OF COAL DEPOSIT—Drawn along the outcrop of coal bed and/or the contact between burned and unburned coal (dashed where inferred by present author beyond the limits of original data). Arrows point toward coal-bearing area. Numbers at triangle are coal bed thickness and altitude at the top of the coal bed, measured in feet.

To convert feet to meters, multiply feet by 0.3048.

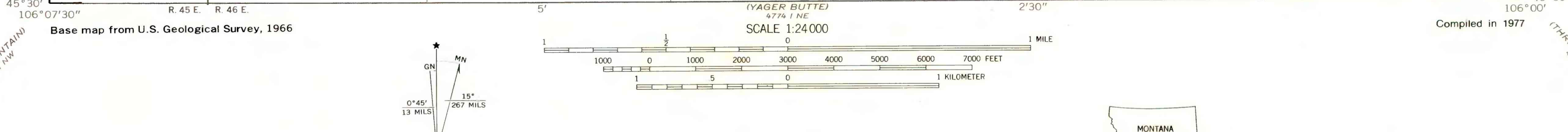
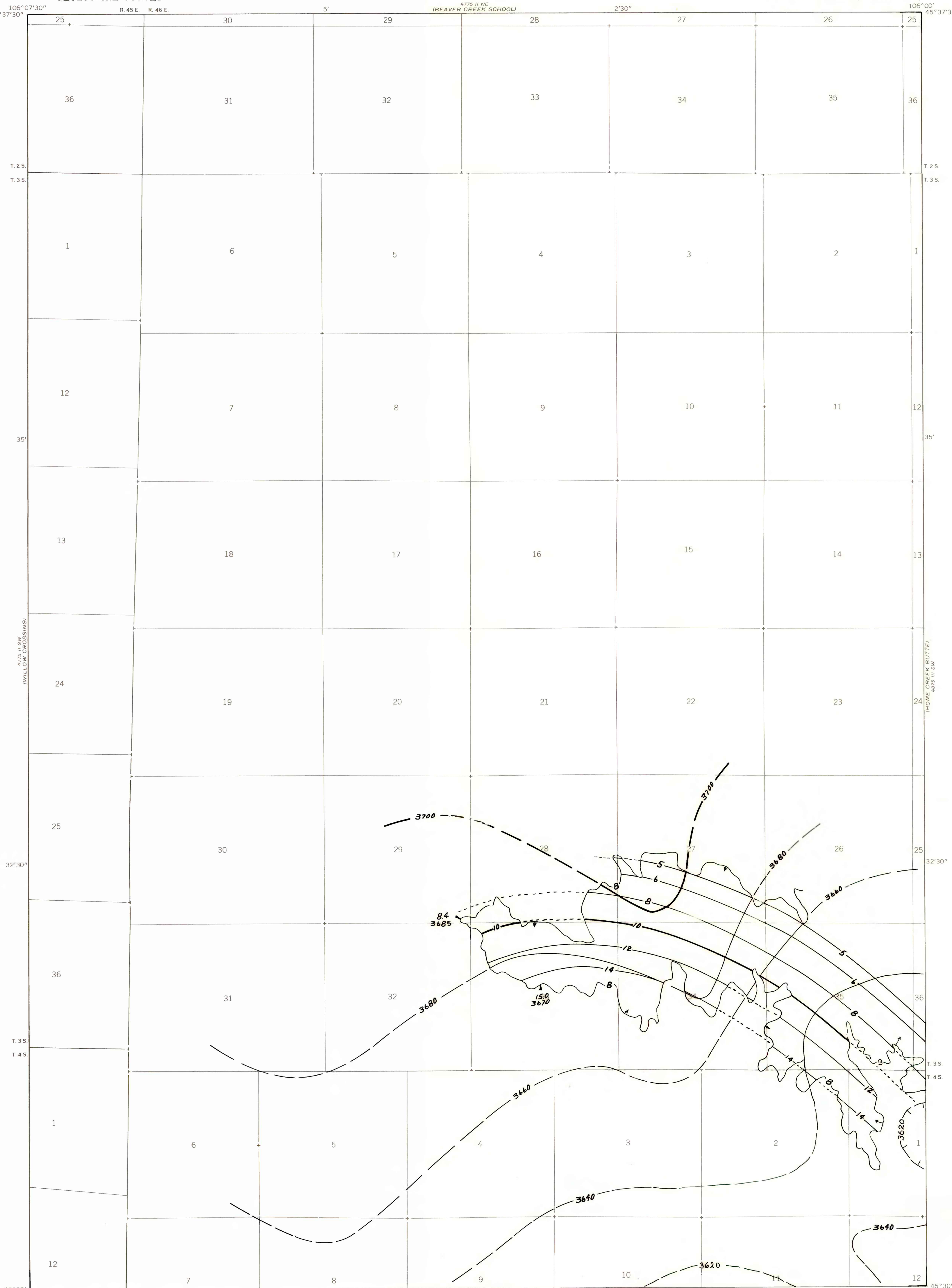

**COAL RESOURCE OCCURRENCE MAP OF THE COLEMAN DRAW QUADRANGLE,  
POWDER RIVER COUNTY, MONTANA  
BY  
COLORADO SCHOOL OF MINES RESEARCH INSTITUTE  
1979**