

4775 II NW
(COOPER CREEK
RESERVOIR)

OPEN-FILE REPORT
This report has not been edited for conformity with
U.S. Geological Survey editorial standards or
stratigraphic nomenclature.

EXPLANATION

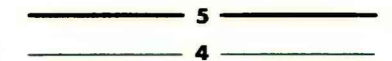

ISOPACHS OF THE COAL BED—Showing thickness, in
feet. Isopach interval 1 foot.

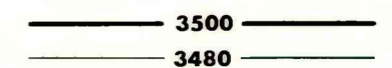

STRUCTURE CONTOURS—Drawn on the top of the coal
bed. Dashed where projected beyond boundary of coal.
Contour interval 20 feet (6.1 m). Datum is mean sea
level.

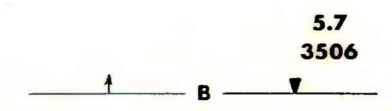

BOUNDARY OF COAL DEPOSIT—Drawn along the
outcrop of coal bed and/or the contact between burned
and unburned coal (dashed where inferred by present
author beyond the limits of original data). Arrows point
toward coal-bearing area. Numbers at triangle are coal
bed thickness and altitude at the top of the coal bed,
measured in feet.

To convert feet to meters, multiply feet by 0.3048.

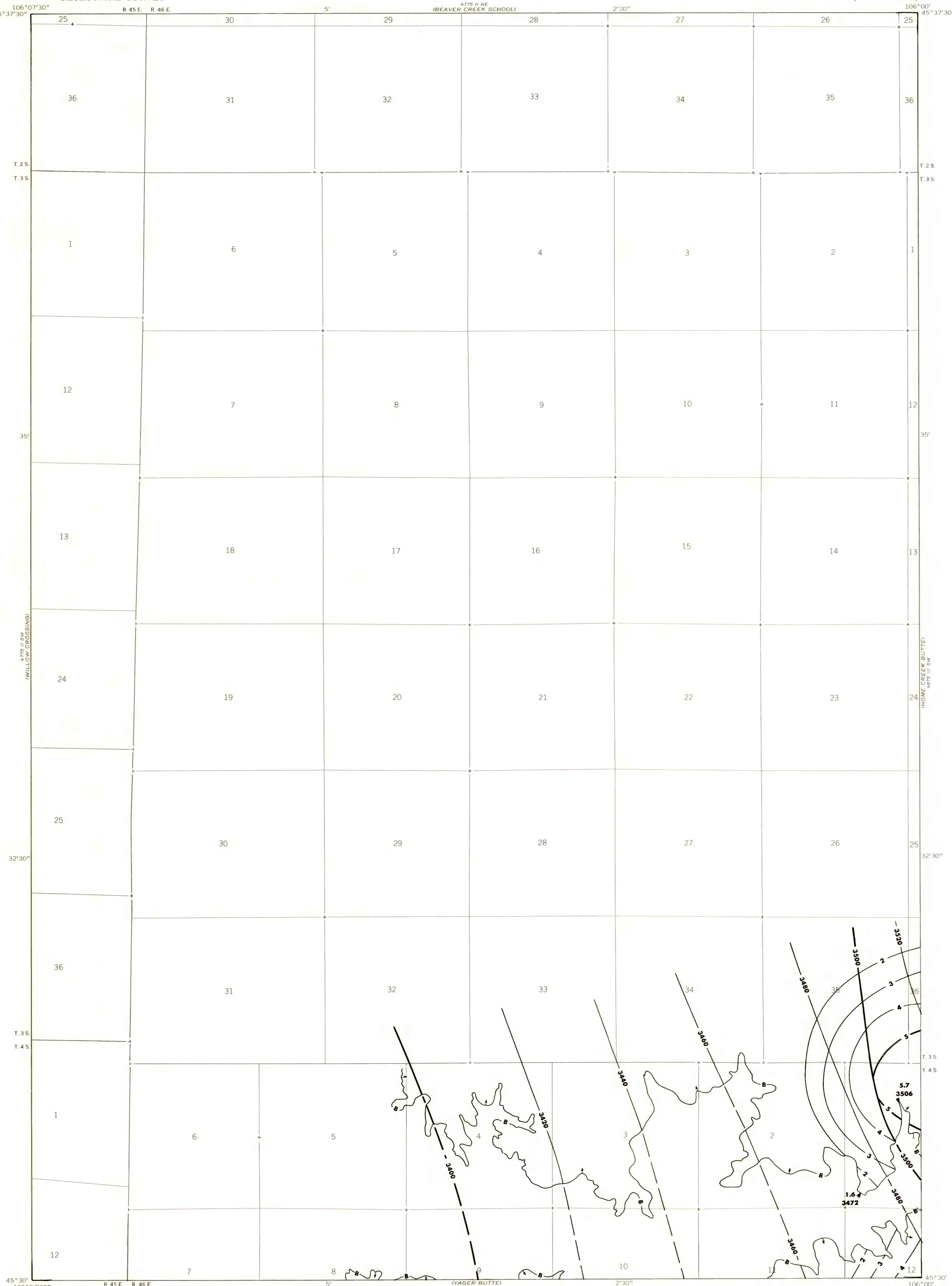

4775 II SW
(WILLOW CROSSING)

Base map from U.S. Geological Survey, 1966

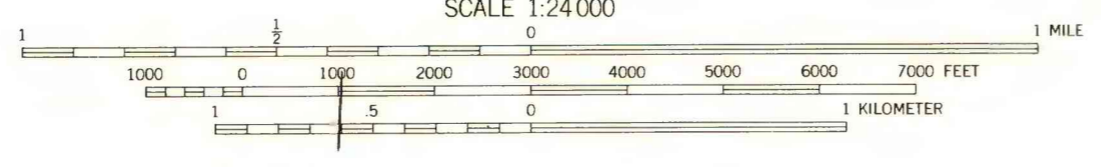
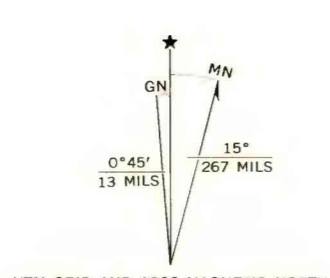

Compiled in 1977
(THREEMILE BUTTES)
4775 III SW

COAL RESOURCE OCCURRENCE MAP OF THE COLEMAN DRAW QUADRANGLE,
POWDER RIVER COUNTY, MONTANA

BY
COLORADO SCHOOL OF MINES RESEARCH INSTITUTE
1979