

OPEN-FILE REPORT
This report has not been edited for conformity with U.S. Geological Survey editorial standards or stratigraphic nomenclature.

UNITED STATES
DEPARTMENT OF THE INTERIOR
GEOLOGICAL SURVEY

COOK CREEK RESERVOIR QUADRANGLE
MONTANA
7.5 MINUTE SERIES (TOPOGRAPHIC)

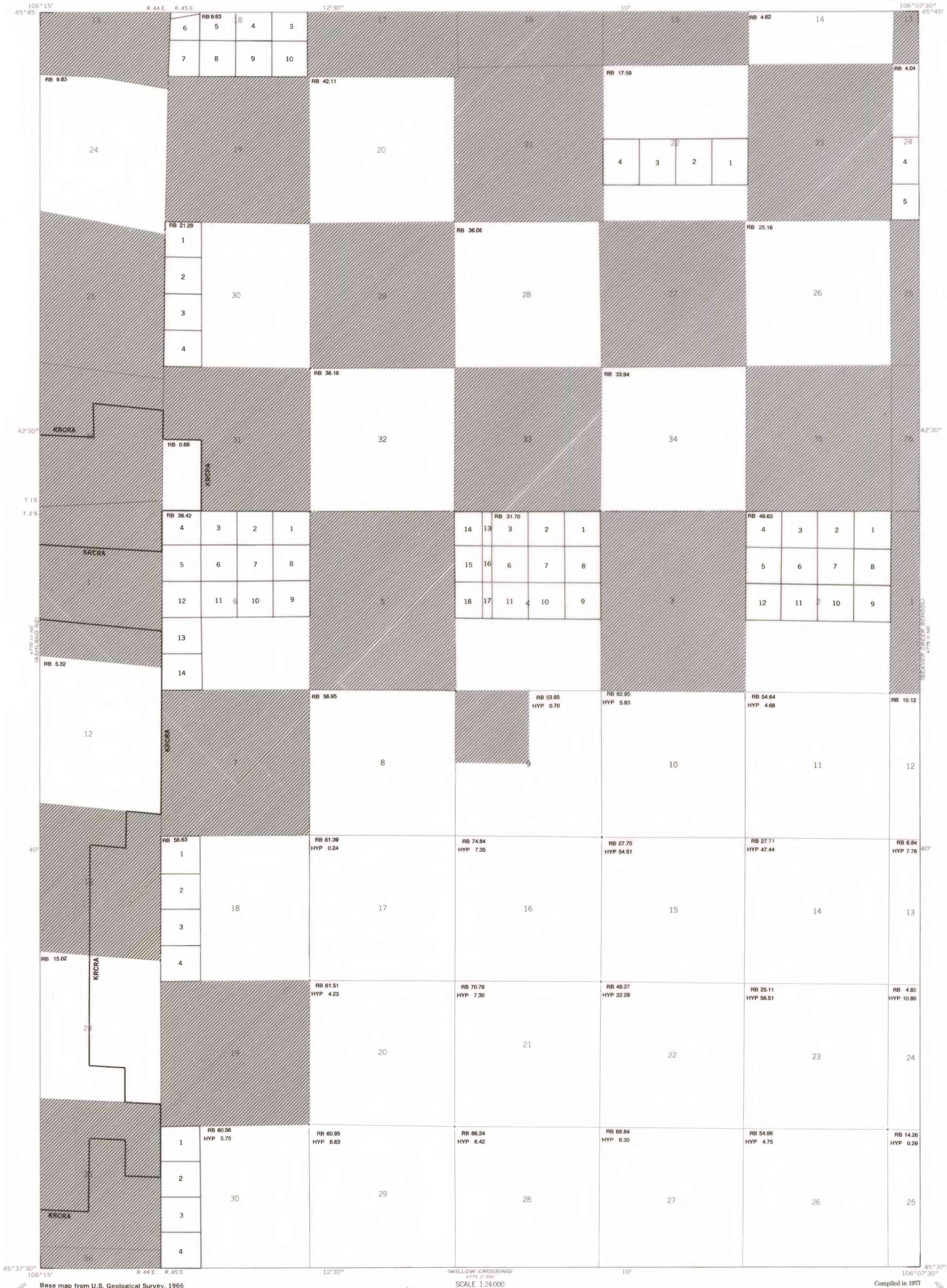

EXPLANATION

KRCRA

BOUNDARY OF KNOWN RECOVERABLE COAL RESOURCE AREA (KRCRA)—Area of KRCRA indicated by label.

NON-FEDERAL COAL LAND—Land for which the Federal Government does not own the coal rights.

RB 54.64
HYP 4.68

TOTAL RESERVE BASE (RB) AND HYPOTHETICAL RESOURCES (HYP) OF COAL PER SECTION—In millions of short tons, calculated for each section of Federal land following the guidelines given in U.S. Geol. Survey Bull. 1450-B (1976). To convert short tons to metric tons, multiply short tons by 0.9072.

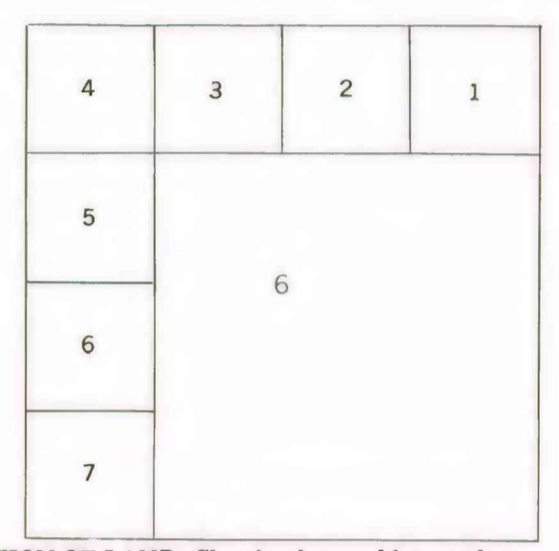

NOTE. BLM coal plat data indicating areas of coal ownership current as of August 9, 1977.

REFERENCE

U.S. Bureau of Mines and U.S. Geological Survey, 1976, Coal resource classification system of the U.S. Bureau of Mines and U.S. Geological Survey: U.S. Geol. Survey Bull. 1450-B, 7 p.

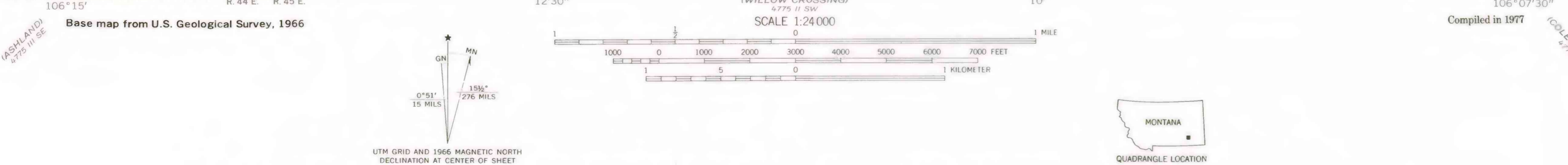

COAL RESOURCE OCCURRENCE MAP OF THE COOK CREEK RESERVOIR
QUADRANGLE, POWDER RIVER AND ROSEBUD COUNTIES, MONTANA
BY
COLORADO SCHOOL OF MINES RESEARCH INSTITUTE
1979