





OPEN-FILE REPORT
This report has not been edited for conformity with
U.S. Geological Survey editorial standards or
stratigraphic nomenclature.

EXPLANATION

-  10
 8
ISOPACHS OF THE COAL BED—Showing thickness, in feet. Isopach interval 2 feet, with an intermediate 5-foot isopach.
 -  3960
 3940
STRUCTURE CONTOURS—Drawn on the top of the coal bed. Dashed where projected beyond boundary of coal. Contour interval 20 feet (6.1 m). Datum is mean sea level.
 -  35
BOUNDARY OF COAL DEPOSIT—Drawn along the outcrop of coal bed and/or the contact between burned and unburned coal (dashed where inferred by present author beyond the limits of original data). Arrows point toward coal-bearing areas. Numbers at triangle are coal bed thickness and altitude at the top of the coal bed, measured in feet.
 -  16
 3968
DRILL HOLE—Showing thickness and altitude at the top of the coal bed, in feet.
- To convert feet to meters, multiply feet by 0.3048.

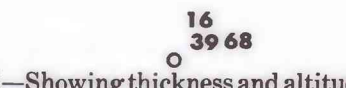
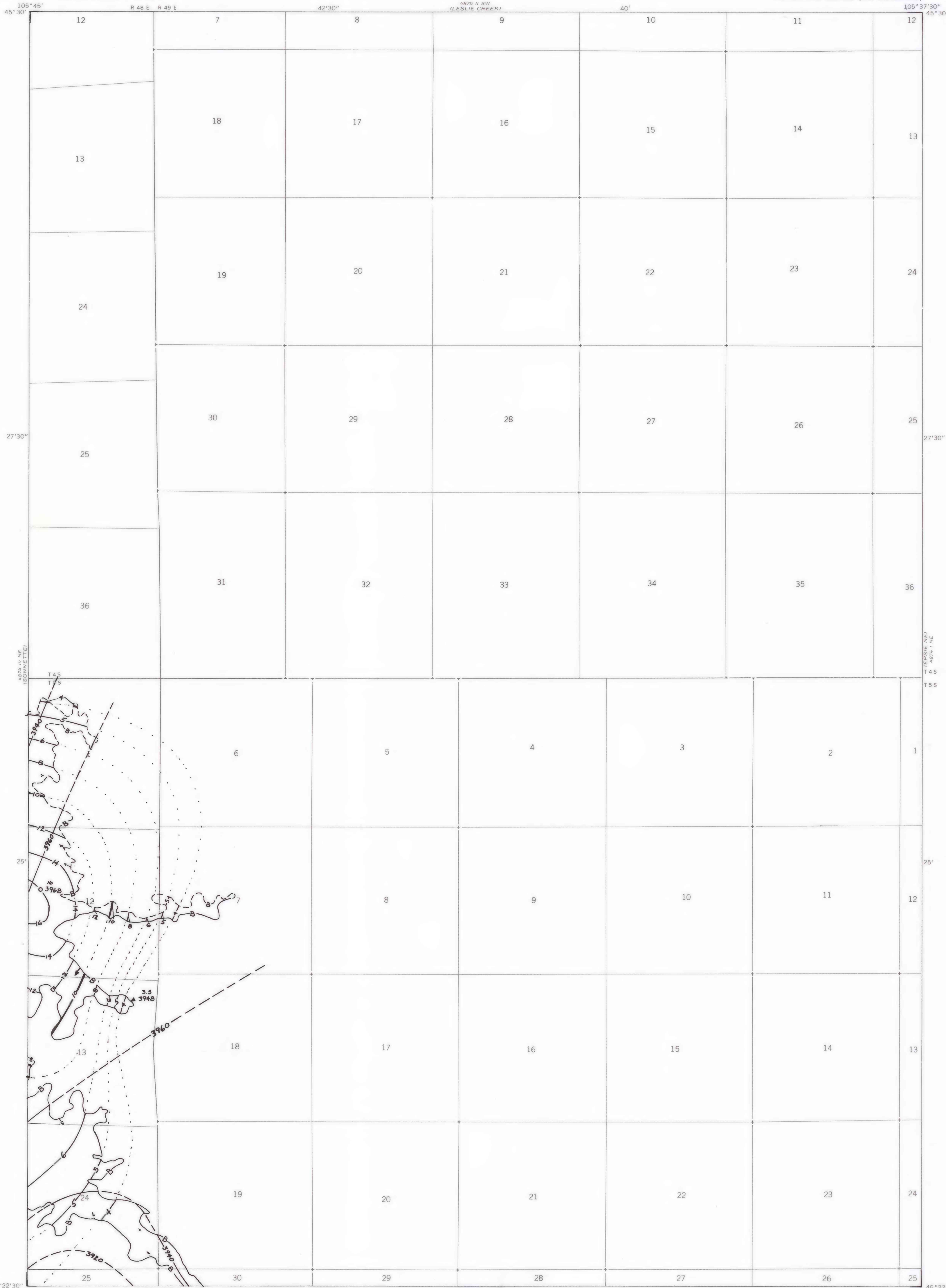

COAL RESOURCE OCCURRENCE MAP OF THE EPSIE QUADRANGLE,
POWDER RIVER COUNTY, MONTANA
BY
COLORADO SCHOOL OF MINES RESEARCH INSTITUTE
1979