

OPEN-FILE REPORT
This report has not been edited for conformity with
U.S. Geological Survey editorial standards or
stratigraphic nomenclature.

EXPLANATION

- 10 —
— 8 —
ISOPACHS OF THE COAL BED—Showing thickness, in feet. Isopach interval 2 feet, with an intermediate 5-foot isopach.
 - 3200 —
— 3180 —
STRUCTURE CONTOURS—Drawn on the top of the coal bed. Contour interval 20 feet (6.1m). Datum is mean sea level.
 - 6
3225
O
DRILL HOLE—Showing thickness and altitude at the top of the coal bed, in feet.
- To convert feet to meters, multiply feet by 0.3048.

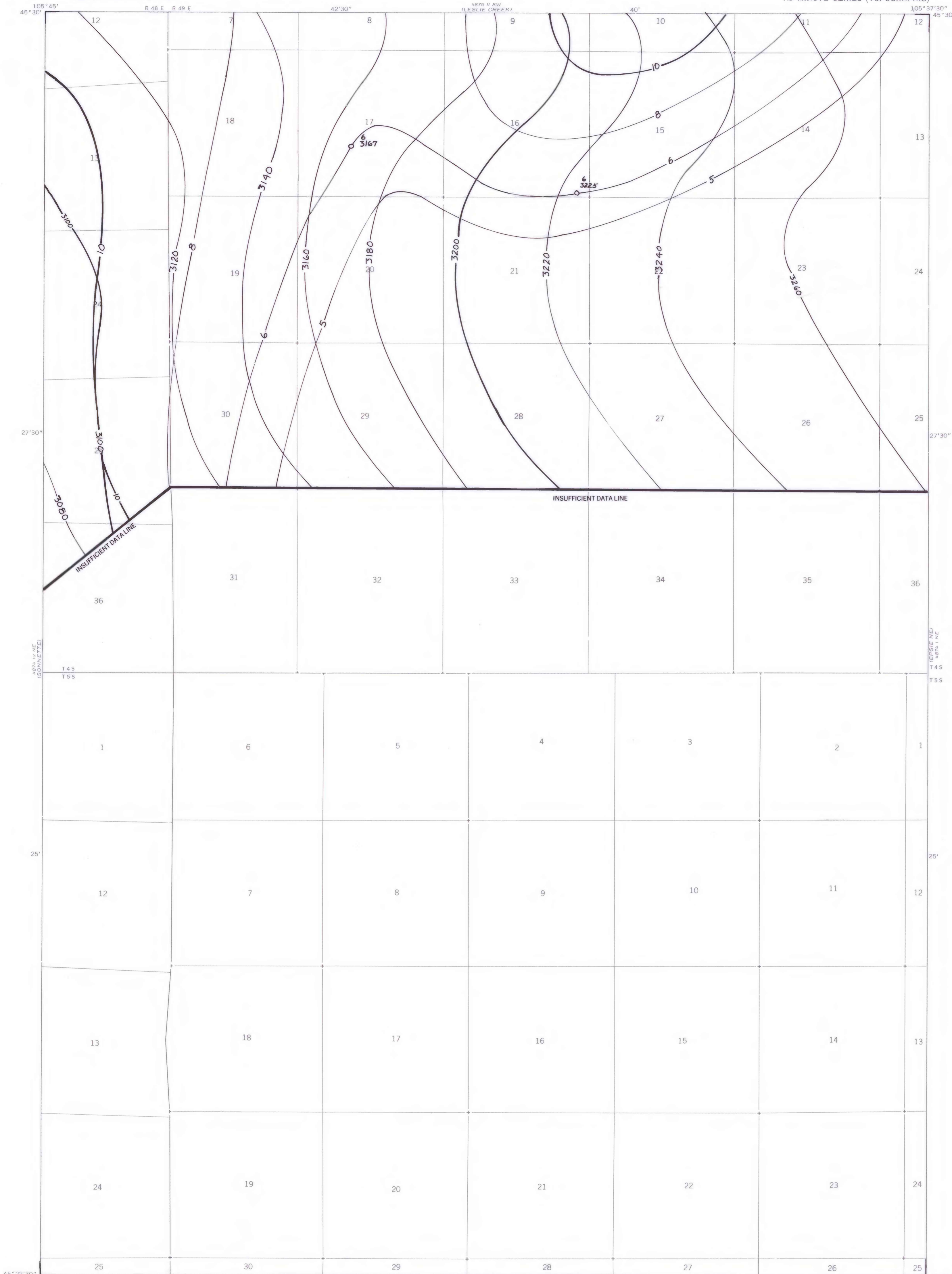

Base map from U.S. Geological Survey, 1973

Compiled in 1977

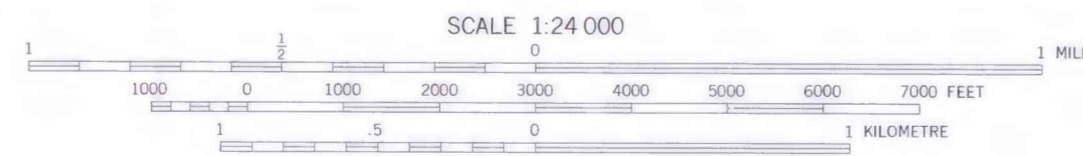
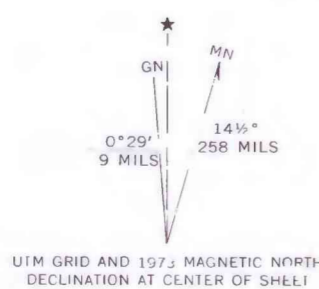

**COAL RESOURCE OCCURRENCE MAP OF THE EPSIE QUADRANGLE,
POWDER RIVER COUNTY, MONTANA
BY
COLORADO SCHOOL OF MINES RESEARCH INSTITUTE
1979**