

OPEN-FILE REPORT  
This report has not been edited for conformity with  
U.S. Geological Survey editorial standards or  
stratigraphic nomenclature.

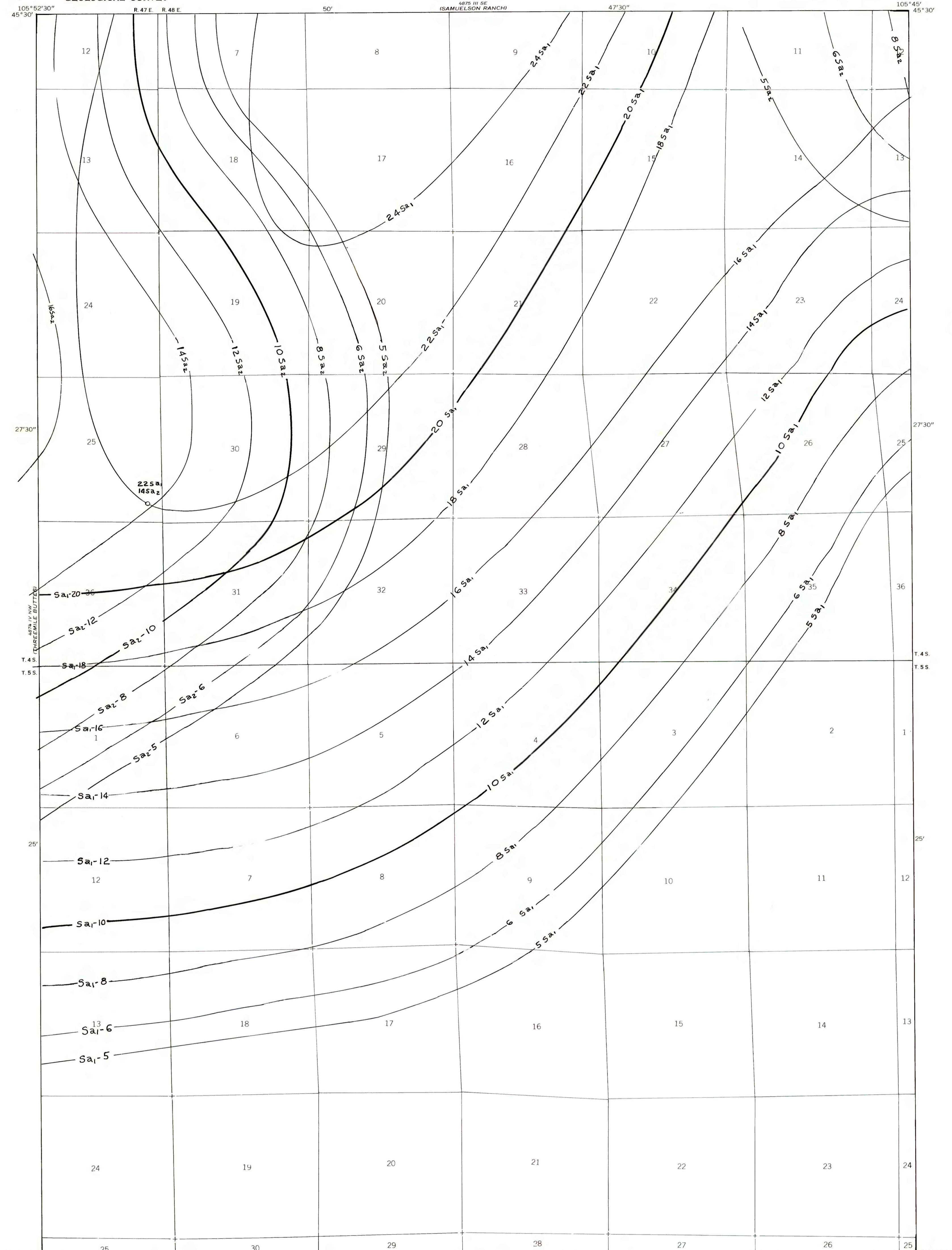

EXPLANATION

— 20 Sa<sub>1</sub> —  
— 18 Sa<sub>1</sub> —

ISOPACHS OF THE UPPER SAWYER SPLIT OF THE  
SAWYER COAL BED—Showing thickness, in feet.  
Isopach interval 2 feet, with an intermediate 5-foot  
isopach.

— 10 Sa<sub>2</sub> —  
— 8 Sa<sub>2</sub> —

ISOPACHS OF THE LOWER SAWYER SPLIT OF THE  
SAWYER COAL BED—Isopach interval 2 feet, with  
an intermediate 5-foot isopach.

○ 22 Sa<sub>1</sub>  
○ 14 Sa<sub>2</sub>

DRILL HOLE—Showing thickness of the coal bed, in feet.  
To convert feet to meters, multiply feet by 0.3048.

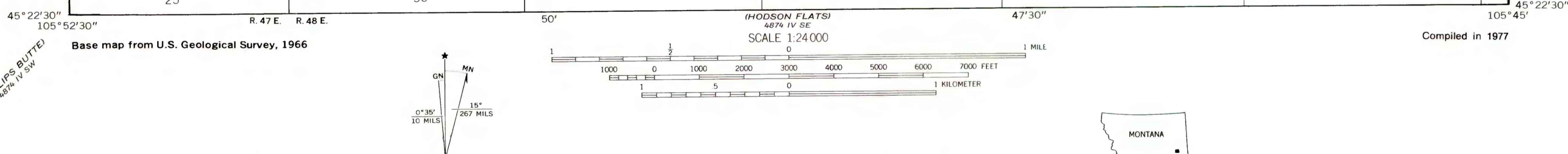

**COAL RESOURCE OCCURRENCE MAP OF THE SONNETTE QUADRANGLE,  
POWDER RIVER COUNTY, MONTANA**

**BY  
COLORADO SCHOOL OF MINES RESEARCH INSTITUTE  
1979**