

OPEN-FILE REPORT
This report has not been edited for conformity with
U.S. Geological Survey editorial standards or
stratigraphic nomenclature.

EXPLANATION

— 5 —
— 10 —

ISOPACHS OF THE COAL BED—Showing thickness, in
feet. Isopach interval 5 feet.

— 2800 —
— 2840 —

STRUCTURE CONTOURS—Drawn on the top of the coal
bed. Contour interval 40 feet (12.2 m). Datum is mean
sea level.

15
○ 2904

DRILL HOLE—Showing thickness and altitude at the top of
the coal bed, in feet.

To convert feet to meters, multiply feet by 0.3048.

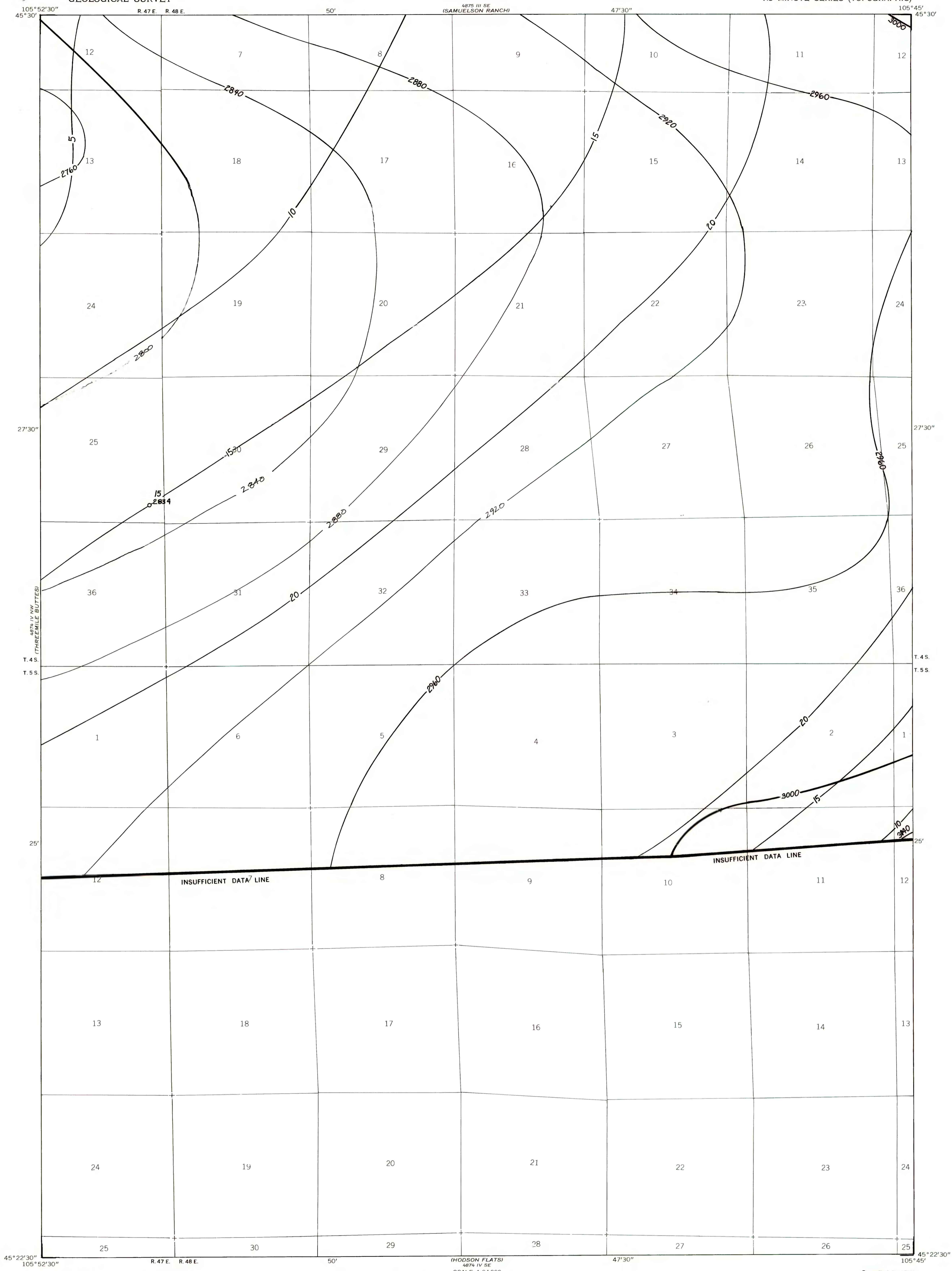

Base map from U.S. Geological Survey, 1966

Compiled in 1977

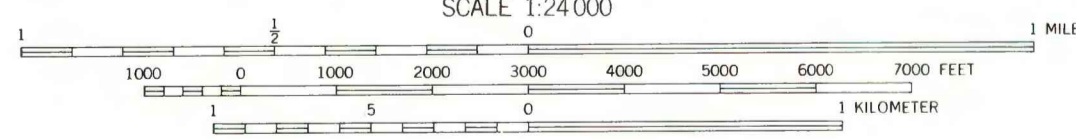
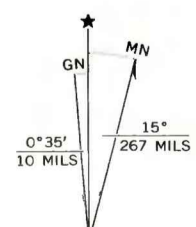

**COAL RESOURCE OCCURRENCE MAP OF THE SONNETTE QUADRANGLE,
POWDER RIVER COUNTY, MONTANA**

**BY
COLORADO SCHOOL OF MINES RESEARCH INSTITUTE
1979**