

OPEN-FILE REPORT
This report has not been edited for conformity with
U.S. Geological Survey editorial standards or
stratigraphic nomenclature.

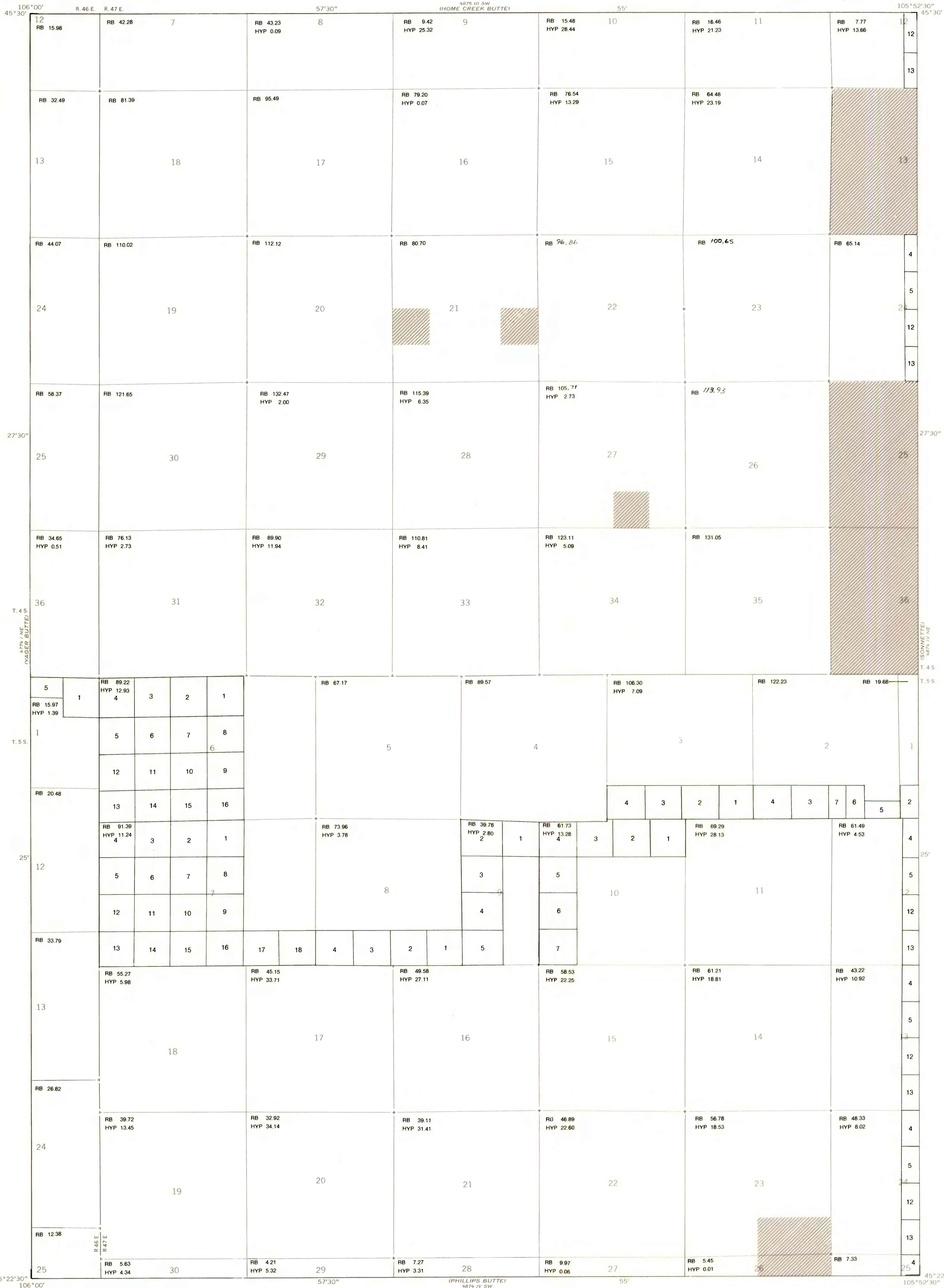

EXPLANATION

 NON-FEDERAL COAL LAND WITHIN THE KRCCA—
Land for which the Federal Government does not own
the coal rights.

RB 73.96
HYP 3.78

TOTAL RESERVE BASE (RB) OF COAL PER SECTION—
In millions of short tons, calculated for each section of
Federal land following the guidelines given in U.S. Geol.
Survey Bulletin 1450-B (1976). To convert short tons to
metric tons, multiply short tons by 0.9072.

4	3	2	1
5	6		
6			
7			

SECTION OF LAND—Showing lots and lot numbers.

Base map from U.S. Geological Survey, 1966

Compiled in 1977

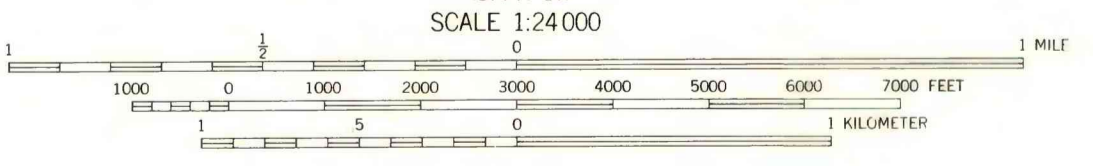
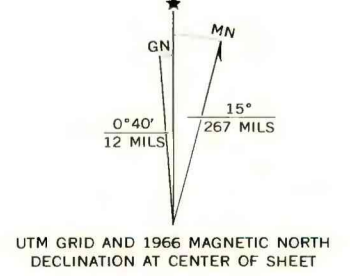

COAL RESOURCE OCCURRENCE MAP OF THE THREEMILE BUTTES QUADRANGLE,
POWDER RIVER COUNTY, MONTANA
BY
COLORADO SCHOOL OF MINES RESEARCH INSTITUTE
1979