

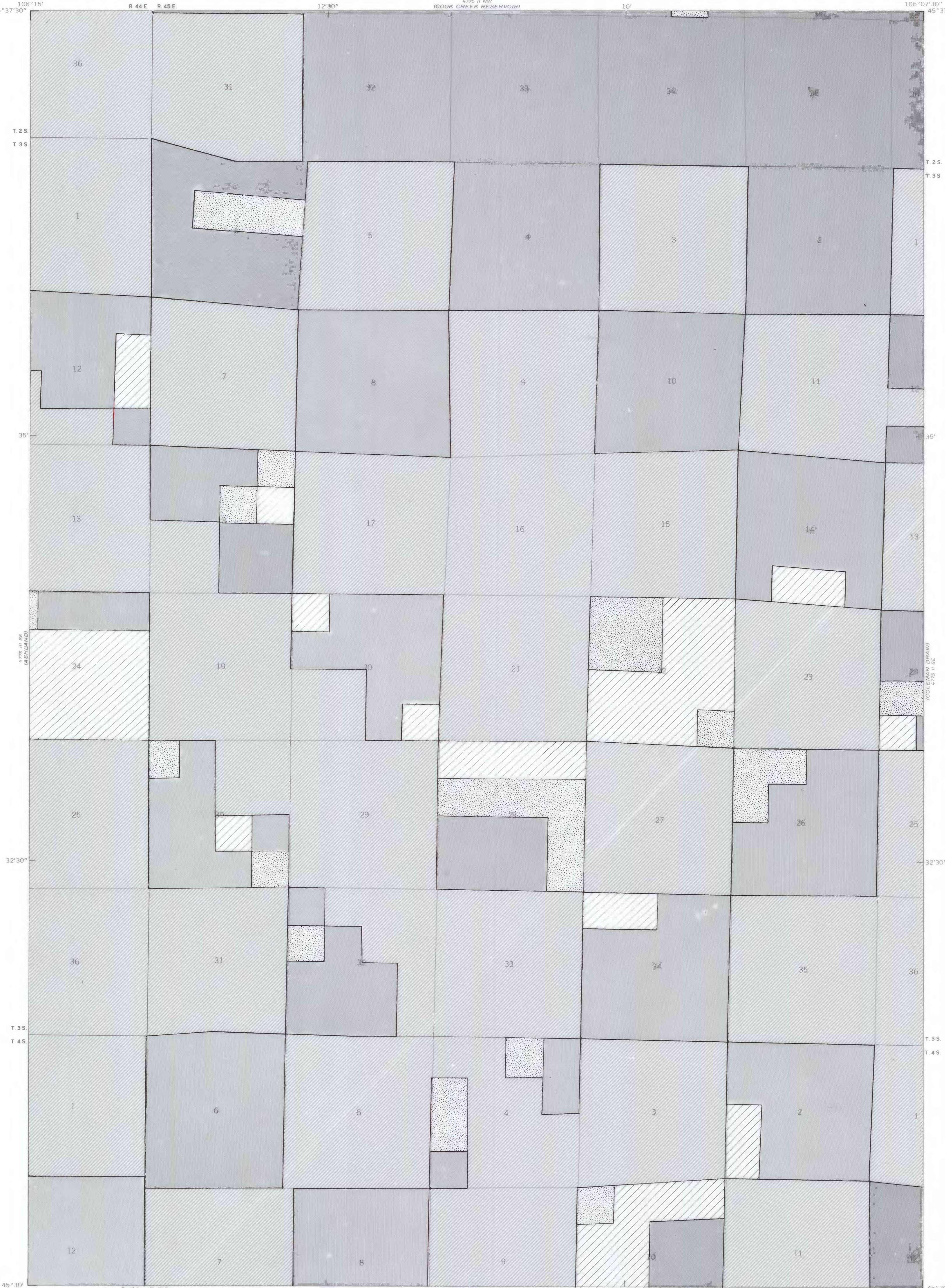



OPEN-FILE REPORT
This report has not been edited for conformity with
U.S. Geological Survey editorial standards or
stratigraphic nomenclature.

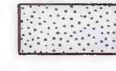

EXPLANATION

-  NON-FEDERAL COAL LAND—Land for which the Federal Government does not own the coal rights and for which the coal-development potential is not rated.
-  AREA OF HIGH COAL-DEVELOPMENT POTENTIAL—Area has mining-ratio values ranging from 0 to 10.
-  AREA OF MODERATE COAL-DEVELOPMENT POTENTIAL—Area has mining-ratio values ranging from 10 to 15.
-  AREA OF LOW COAL-DEVELOPMENT POTENTIAL—Area has mining-ratio values greater than 15.
-  AREA WITH NO COAL-DEVELOPMENT POTENTIAL FOR SURFACE MINING—Area contains no known coal in beds 5 feet (1.5 m) or more thick within 500 feet (152 m) of the surface.

Base map from U.S. Geological Survey, 1966

SCALE 1:24,000

Compiled in 1977

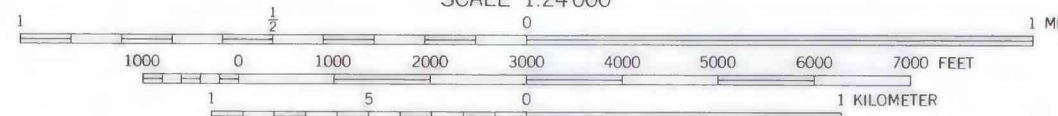
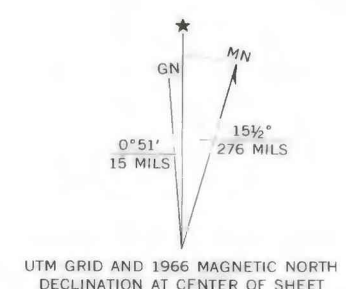

**COAL DEVELOPMENT POTENTIAL MAP OF THE WILLOW CROSSING QUADRANGLE,
POWDER RIVER AND ROSEBUD COUNTIES, MONTANA**
BY
COLORADO SCHOOL OF MINES RESEARCH INSTITUTE
1979