

47° 14' N  
GREEN CREEK

47° 14' N  
ROSEBUD BUTTE

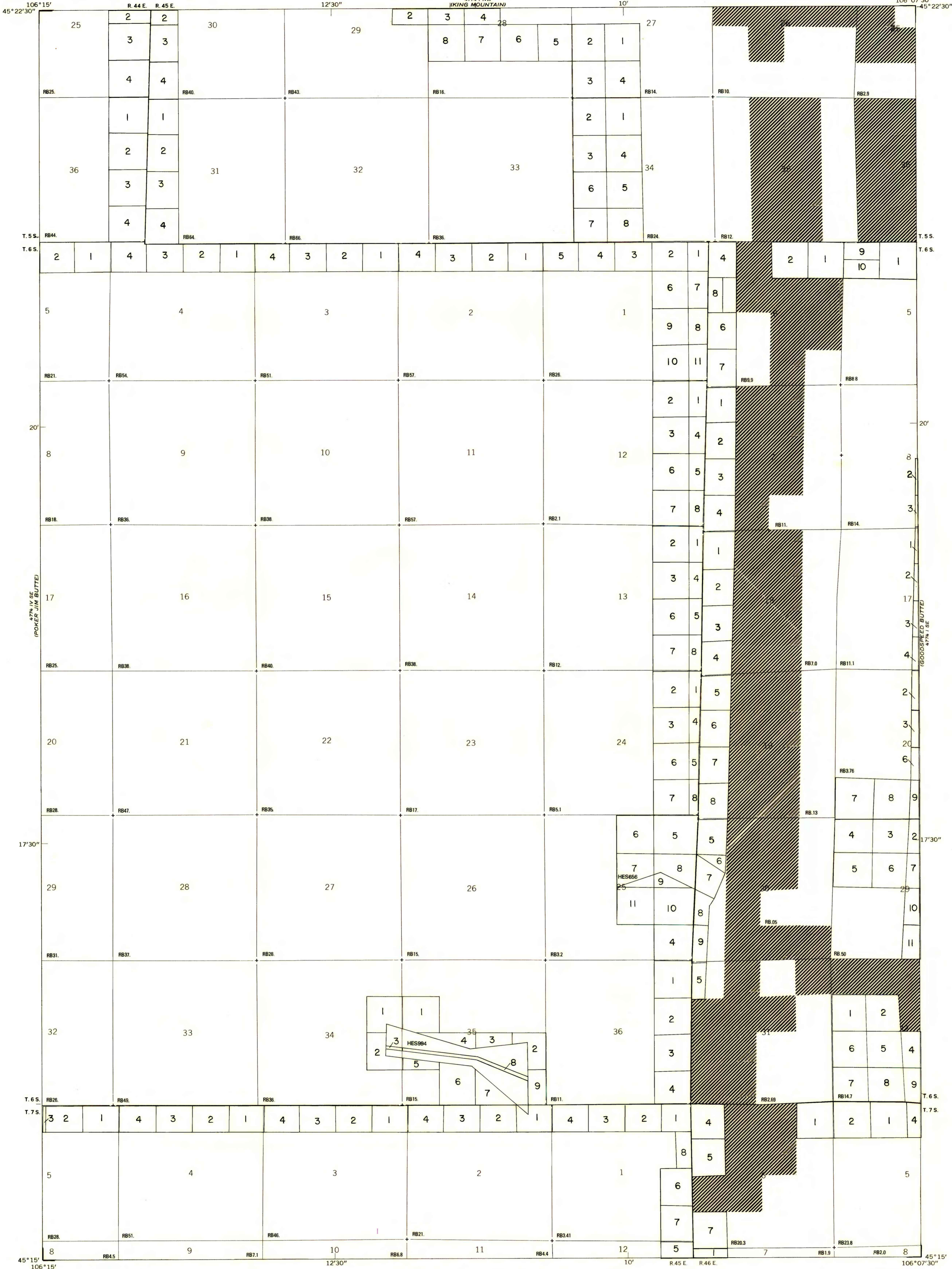

OPEN-FILE REPORT  
This report has not been edited for conformity with U.S. Geological Survey editorial standards or Stratigraphic nomenclature

OPEN FILE REPORT 79-104  
PLATE 2 OF 53

EXPLANATION

NON-FEDERAL COAL LAND--Land for which the Federal Government does not own the coal rights.

<sup>RB</sup> TOTAL RESERVE BASE (RB) OF COAL PER SECTION--In millions of short tons, calculated for each section of Federal land following the guidelines given in U.S. Geol. Survey Bulletin 1450-B (1976). To convert short tons to metric tons, multiply short tons by 0.9072.

4	3	2	1
5	6		
6			
7			

SECTION OF LAND--Showing lots and lot numbers. Boundaries of Homestead Entry Surveys (HES) tracts and their numbers are also shown.

REFERENCE

U.S. Bureau of Mines and U.S. Geological Survey, 1976, Coal resource classification system of the U.S. Bureau of Mines and U.S. Geological Survey: U.S. Geol. Survey Bull. 1450-B, 7p.

Base from U.S. Geological Survey, 1966

Compiled in 1977

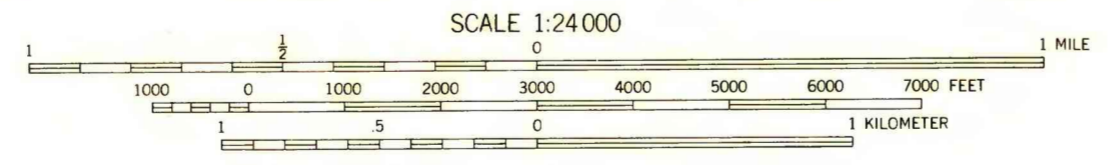
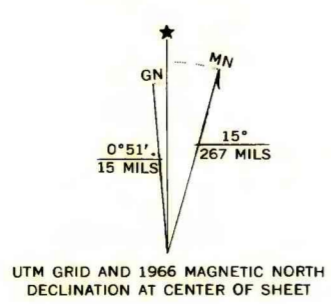

COAL RESOURCE OCCURRENCE AND COAL DEVELOPMENT POTENTIAL MAPS  
OF THE FORT HOWES QUADRANGLE, ROSEBUD AND POWDER RIVER COUNTIES, MONTANA

BY  
E. J. MCKAY AND L. N. ROBINSON  
1979

PLATE 2  
BOUNDARY AND  
COAL DATA MAP