

3867 1:62,500  
1:62,500  
1:62,500

UNITED STATES  
DEPARTMENT OF THE INTERIOR  
GEOLOGICAL SURVEY

WARFIELD CREEK QUADRANGLE  
WYOMING-LINCOLN CO.  
7.5 MINUTE SERIES (TOPOGRAPHIC)

OPEN FILE REPORT 79-123

PLATE 13 OF 18

EXPLANATION

600  
OVERBURDEN ISOPACHS - Showing thickness of overburden, in feet, from surface to top of coal bed. Dashed where vertical accuracy possibly not within 40 feet. Isopach interval is 200 feet (61 m) over strippable coal and 400 feet (122 m) beyond the stripping-limit line.

48  
DRILL HOLE - Showing thickness of overburden, in feet, from surface to top of coal bed.

15  
MINING-RATIO CONTOUR - Number indicates cubic yards of overburden per ton of recoverable coal by surface mining methods. Contours shown only in areas underlain by coal of Reserve Base thickness within the stripping-limit (in this quadrangle, the 200-foot-overburden isonach).

Av-4G - Adaville No. 4G  
COAL BED SYMBOL AND NAME

Av-4G  
TRACE OF COAL BED OUTCROP - Showing symbol of name of coal bed as listed above.

To convert feet to meters, multiply feet by 0.3048.

To convert mining ratio to cubic meters of overburden per metric ton of recoverable coal, multiply mining ratio by 0.8428.

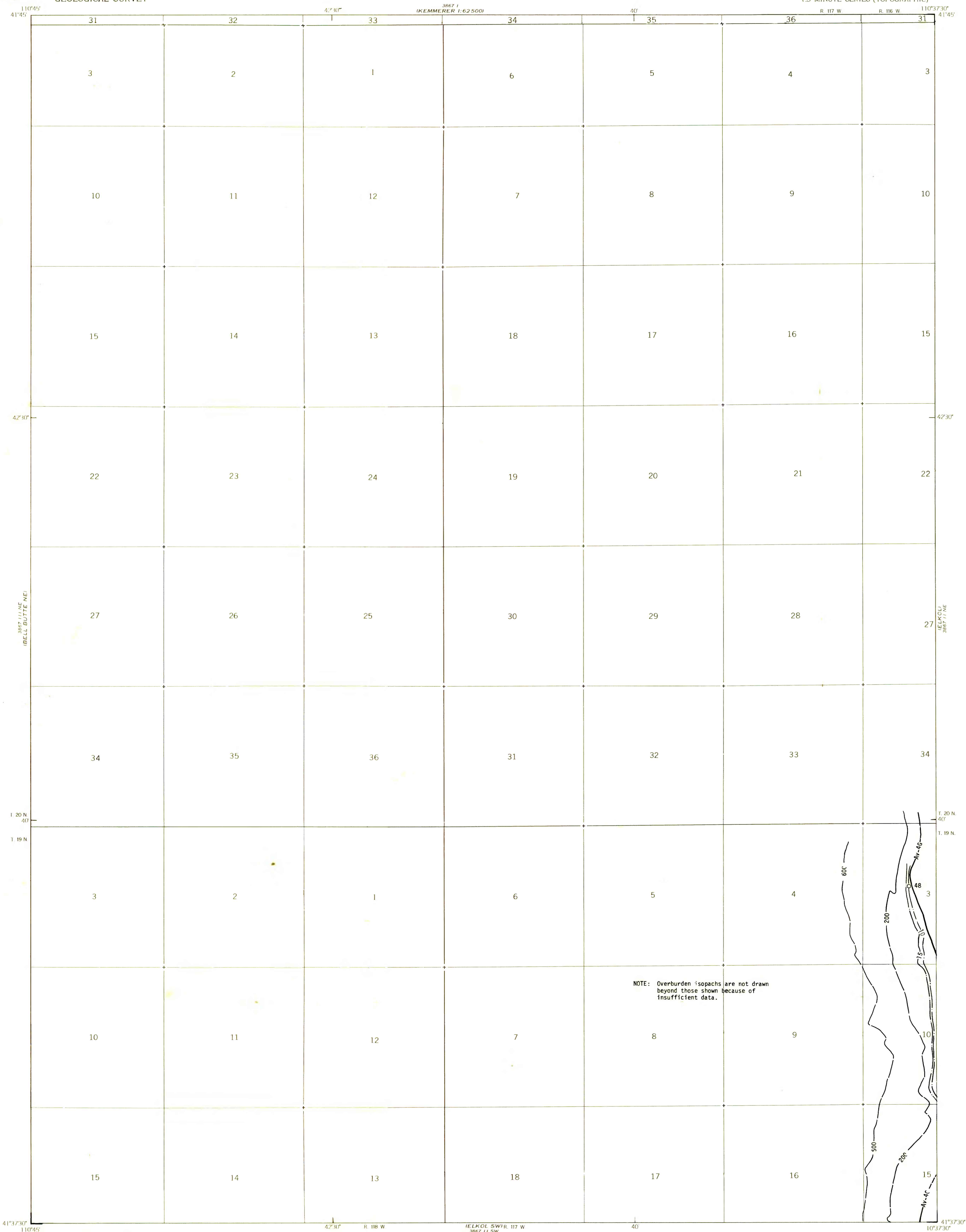

3867 1:62,500  
1:62,500  
1:62,500

Base from U.S. Geological Survey, 1962

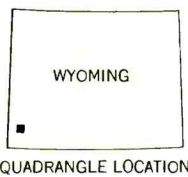
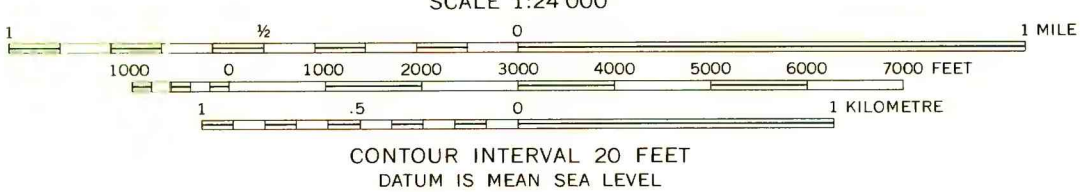
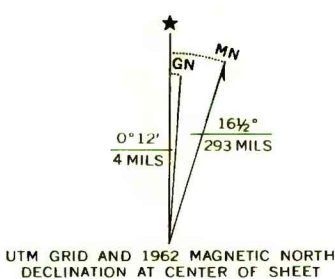

Compiled in 1977/1978

3867 1:62,500  
1:62,500  
1:62,500

This report has not been edited for conformity with U.S. Geological Survey editorial standards or stratigraphic nomenclature.

COAL RESOURCE OCCURRENCE MAP OF THE WARFIELD CREEK  
QUADRANGLE, LINCOLN COUNTY, WYOMING  
BY  
DAMES & MOORE  
1979

PLATE 13  
OVERBURDEN ISOPACH AND  
MINING RATIO MAP OF THE  
ADAVILLE NO. 4G COAL BED