

UNITED STATES  
DEPARTMENT OF THE INTERIOR  
GEOLOGICAL SURVEY

NORTHEAST BOARS TUSK QUADRANGLE  
WYOMING-SWEETWATER CO.  
7.5 MINUTE SERIES (TOPOGRAPHIC)  
R.103 W. R.102 W.

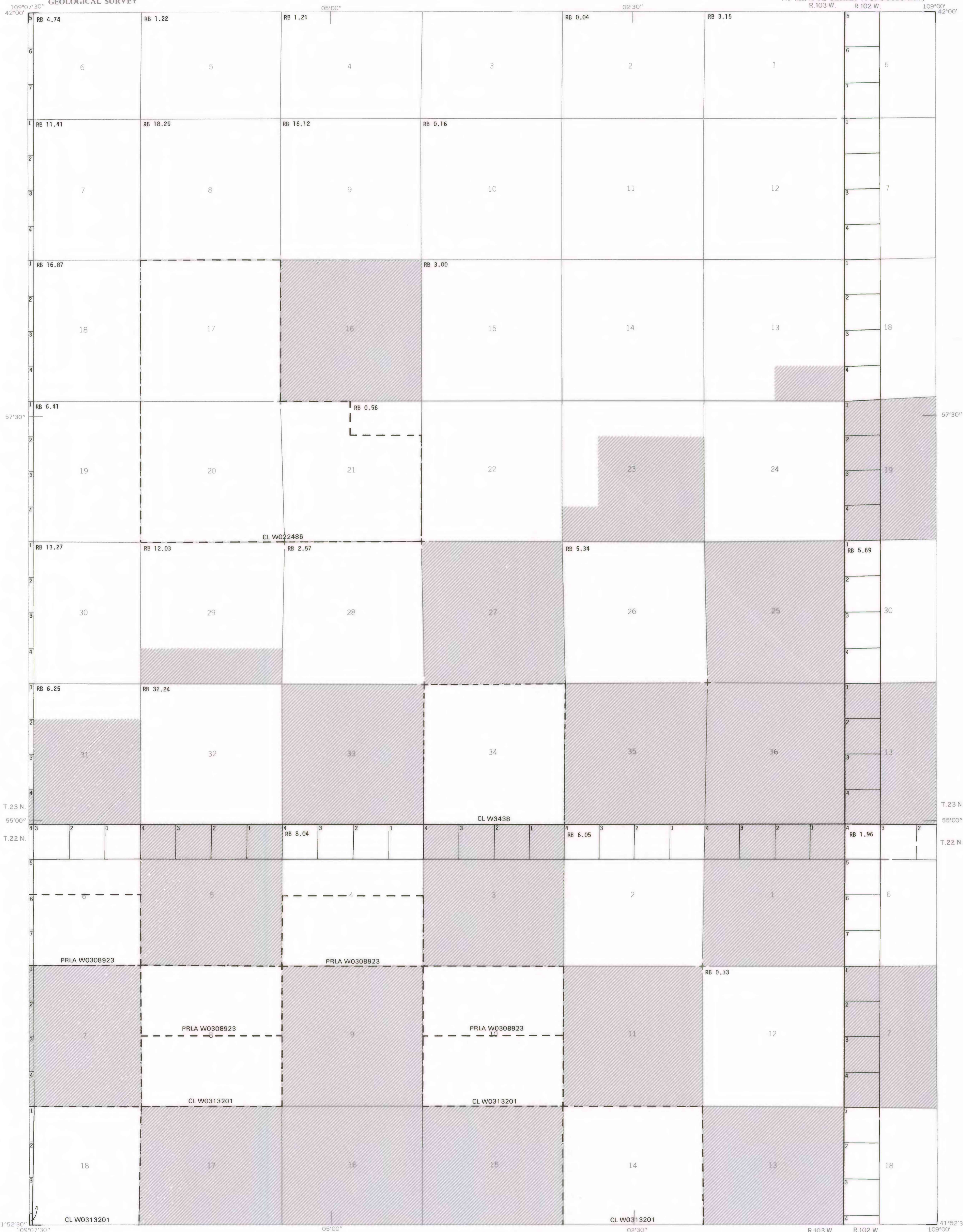

EXPLANATION

The area covered by this quadrangle is entirely within the KRCRA boundary.



NON-FEDERAL COAL LAND—Land within the KRCRA boundary for which the Federal Government does not own the coal rights.

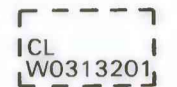

COAL LEASE—Showing lease number.



PREFERENCE RIGHT LEASE APPLICATION (PRLA)—An area of Federal coal lands for which an application for a non-competitive coal lease has been made as a result of exploration done under a coal prospecting permit.

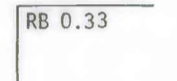

TOTAL RESERVE BASE (RB) OF FEDERAL COAL PER SECTION—In millions of short tons, calculated for each section of Federal land following the guidelines given in U.S. Geol. Survey Bulletin 1450-B. To convert short tons to metric tons, multiply short tons by 0.9072.

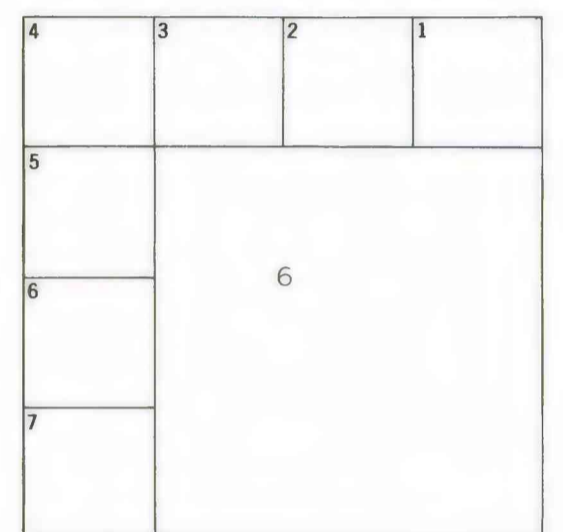

SECTION OF LAND—Showing lots and lot numbers.

NOTE: BLM Coal Ownership Data current as of August 1, 1977.

REFERENCE

U.S. Bureau of Mines and U.S. Geological Survey, 1976, Coal resource classification system of the U.S. Bureau of Mines and U.S. Geological Survey: U.S. Geol. Survey Bull. 1450-B, 7p.

Base from U.S. Geological Survey, 1958

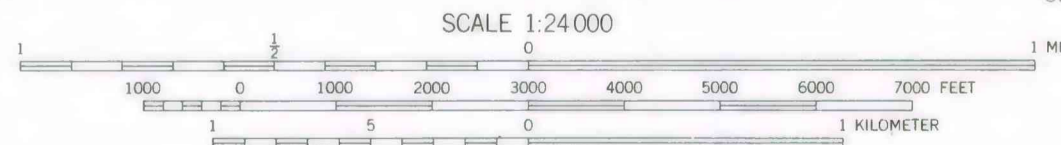

Computed in 1977/1978

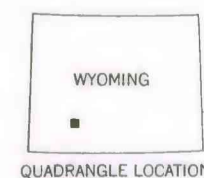
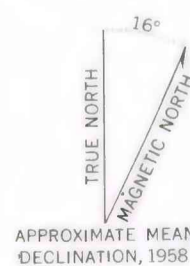

**COAL RESOURCE OCCURRENCE MAP OF THE NORTHEAST QUARTER OF THE BOARS TUSK  
15-MINUTE QUADRANGLE, SWEETWATER COUNTY, WYOMING**  
BY  
**DAMES & MOORE**  
1979

This report has not been edited for conformity with U.S. Geological Survey editorial standards or stratigraphic nomenclature.