

UNITED STATES  
DEPARTMENT OF THE INTERIOR  
GEOLOGICAL SURVEY

SOUTHWEST TWELVEMILE WELL QUADRANGLE  
WYOMING-SWEETWATER CO.  
7.5 MINUTE SERIES (TOPOGRAPHIC)

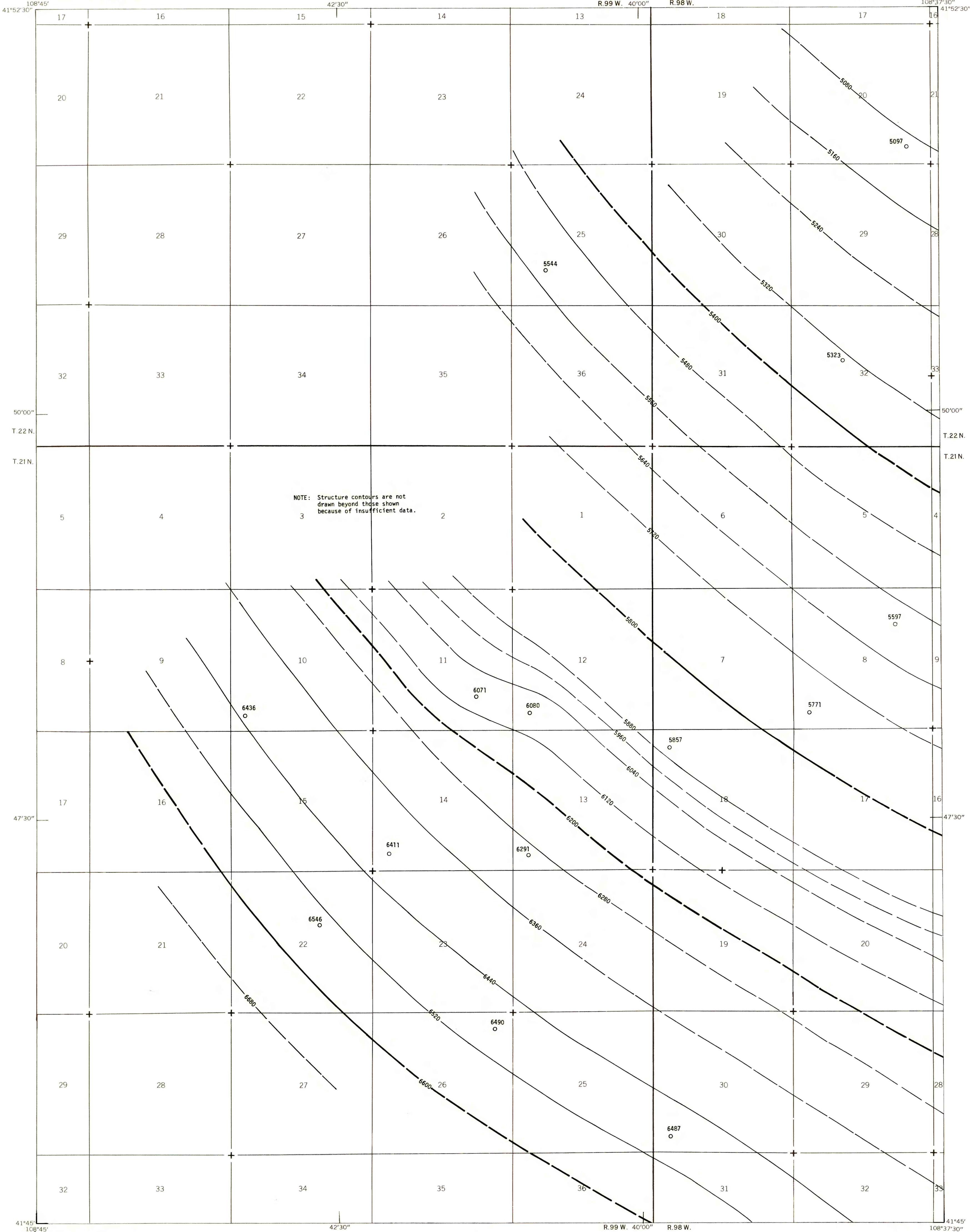

EXPLANATION

- 5800 —
  - - - 5880 - - -
- STRUCTURE CONTOURS - Drawn on top of coal bed. Solid where vertical accuracy within 40 feet; long dashed where vertical accuracy possibly not within 40 feet. Contour interval 80 feet (24 m). Datum is mean sea level.
- 5771
- DRILL HOLE - Showing altitude of top of coal bed, and thickness of coal, in feet.
- To convert feet to meters, multiply feet by 0.3048.

Base from U.S. Geological Survey, 1958

Compiled in 1977/1978

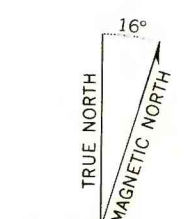
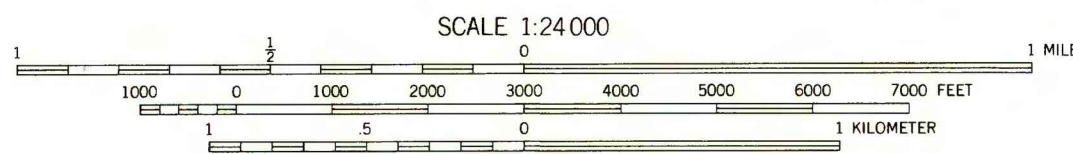

APPROXIMATE MEAN DECLINATION, 1958

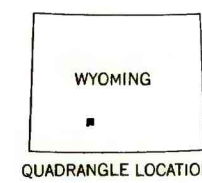

This report has not been edited for conformity with U.S. Geological Survey editorial standards or stratigraphic nomenclature.

# COAL RESOURCE OCCURRENCE MAP OF THE SOUTHWEST QUARTER OF THE TWELVEMILE WELL 15-MINUTE QUADRANGLE, SWEETWATER COUNTY, WYOMING

BY  
**DAMES & MOORE**  
1979

PLATE 29  
STRUCTURE CONTOUR MAP  
OF THE FORT UNION [3]  
COAL BED