

EXPLANATION

KRCRA
KNOWN RECOVERABLE COAL RESOURCES AREA BOUNDARY - Label within KRCRA boundary.

NON-FEDERAL COAL LAND - Land within the KRCRA boundary for which the Federal Government does not own the coal rights.

FEDERAL COAL LEASE BOUNDARY - Lease number within boundary.

TOTAL RESERVE BASE (RB) OF FEDERAL COAL PER SECTION - In millions of short tons, calculated for each section of Federal land following the guidelines given in U.S. Geol. Survey Bulletin 1450-B. To convert short tons to metric tons, multiply short tons by 0.9072.

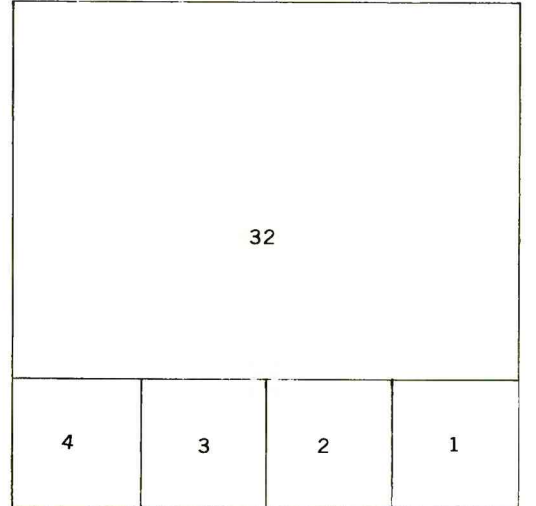

SECTION OF LAND - Showing lots and lot numbers.

NOTE: BLM Coal Ownership Data current as of September 22, 1977.

REFERENCE
U.S. Bureau of Mines and U.S. Geological Survey 1976, Coal resource classification system of the U.S. Bureau of Mines and U.S. Geological Survey: U.S. Geol. Survey Bull. 1450-B, 7p.

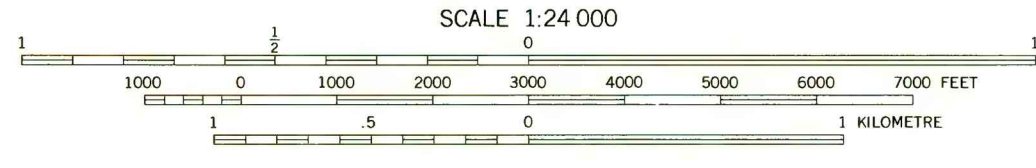
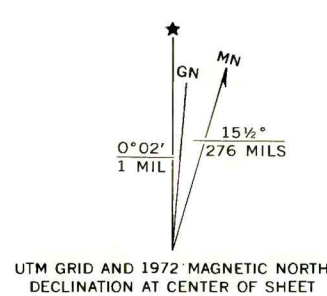
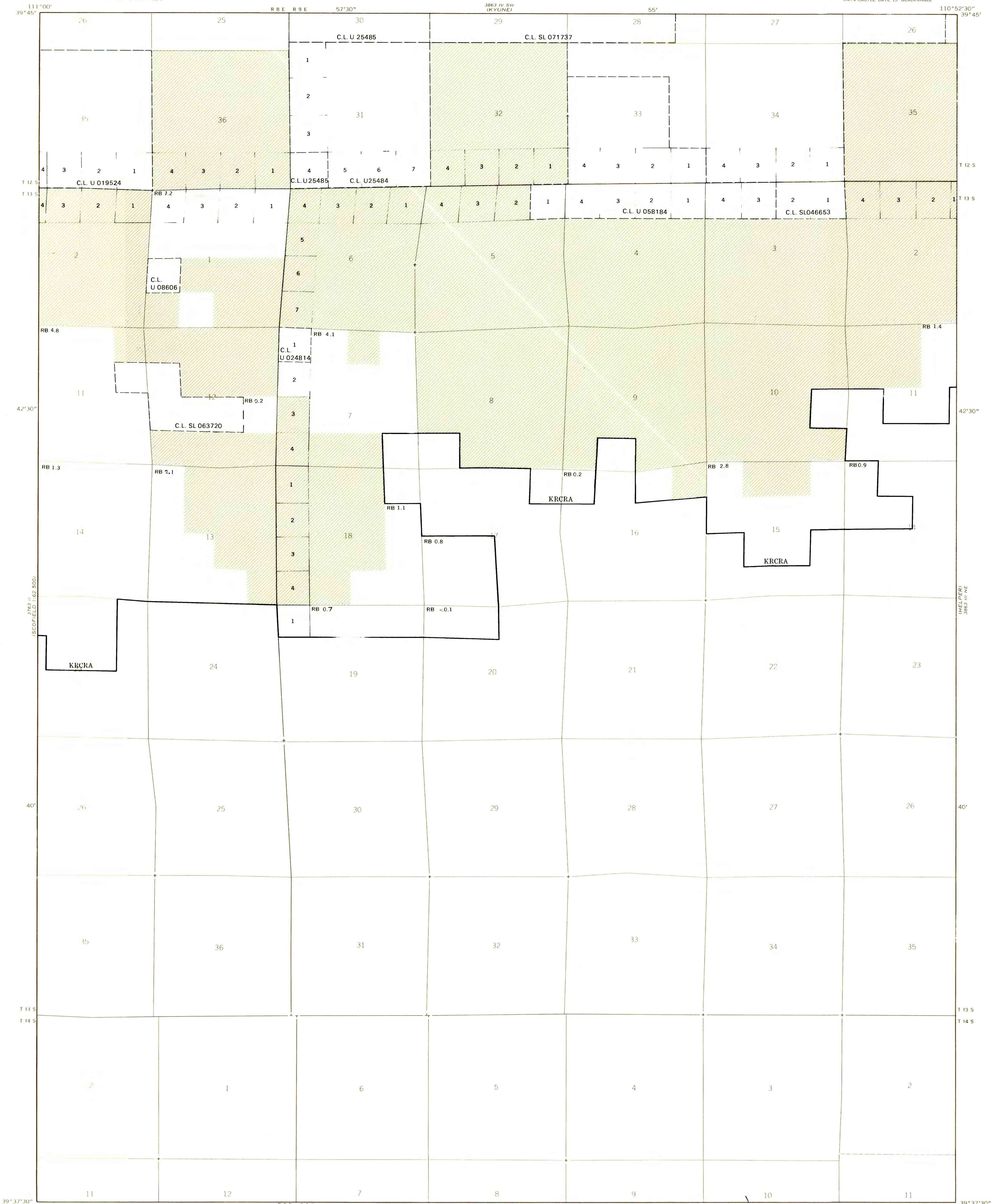

**COAL RESOURCE OCCURRENCE MAP OF THE STANDARDVILLE QUADRANGLE
CARBON COUNTY, UTAH**

**BY
AAA ENGINEERING AND DRAFTING, INC.
1979**