

EXPLANATION

— 25 —
— 30 —
ISOPACHS OF THE MENEFFEE ZONE COAL BEDS —
Showing total coal thickness, in feet.
Isopach interval, 5 feet (1.5 meters).
Isopachs dashed where inferred.

○ 19
DRILL HOLE — Showing total thickness of
Meneffee zone coal beds, in feet.

*The lower part of the Meneffee coal zone
lies below 3,000 feet (914.4 meters)
of overburden. Therefore the value shown
for this drill hole is not representative
of the total zone.

To convert feet to meters, multiply feet
by 0.3048.

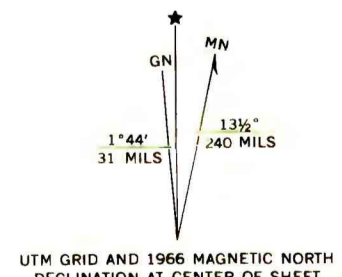
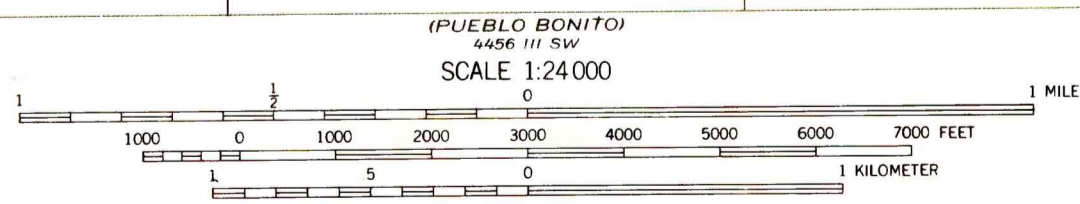
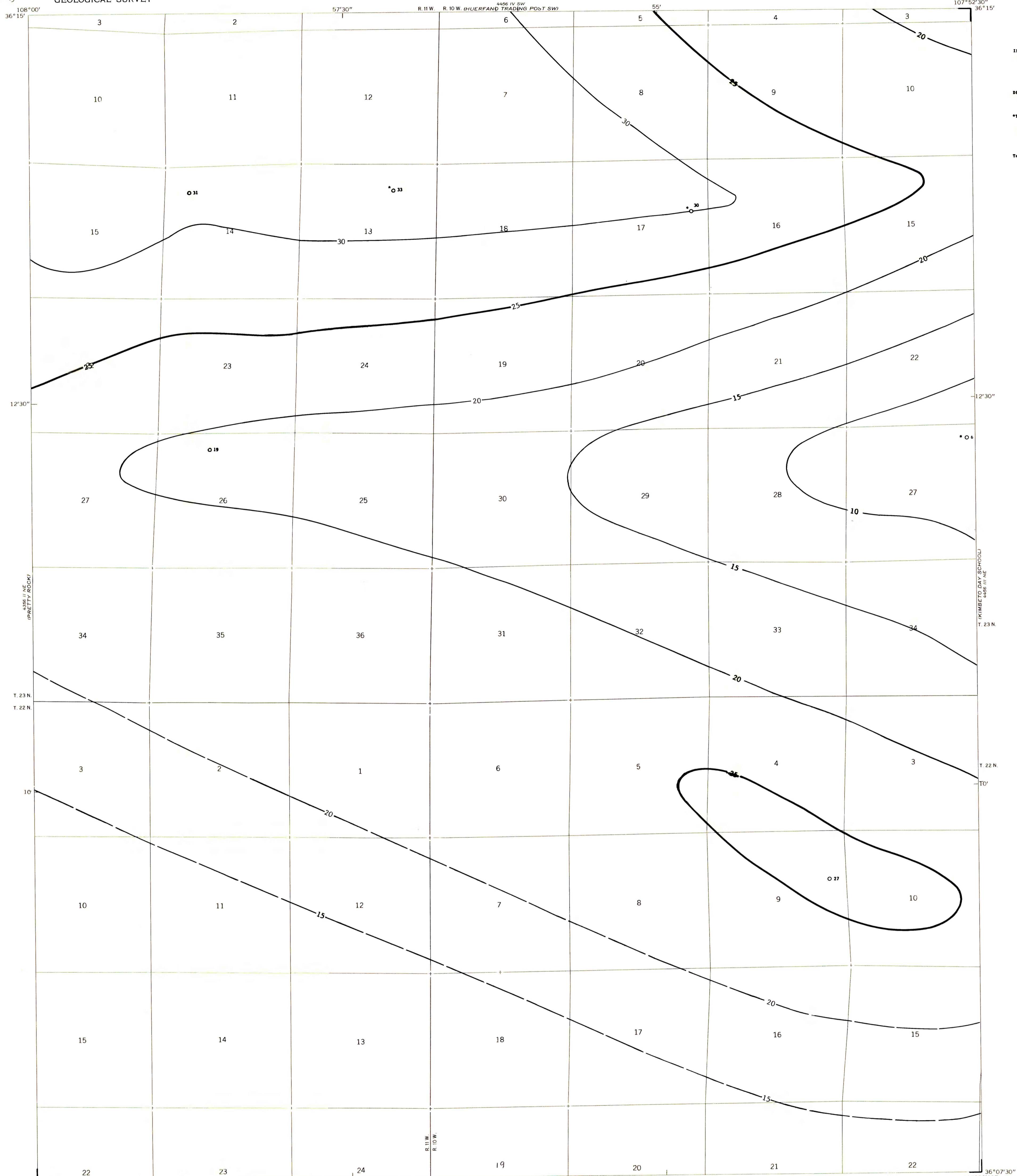

COAL RESOURCE OCCURRENCE MAP OF THE PUEBLO BONITO NW
QUADRANGLE, SAN JUAN COUNTY, NEW MEXICO

BY
DAMES & MOORE
1979

PLATE 4
ISOPACH MAP OF THE TOTAL COAL
OF THE MENEFFEE COAL ZONE

This map was prepared under contract to the U.S. Geological Survey and has not been edited for conformity with Geological Survey editorial standards. Opinions and conclusions expressed herein do not necessarily represent those of the Geological Survey.