

5273 (REV. 11-80)  
(ARVADA DRAWN)

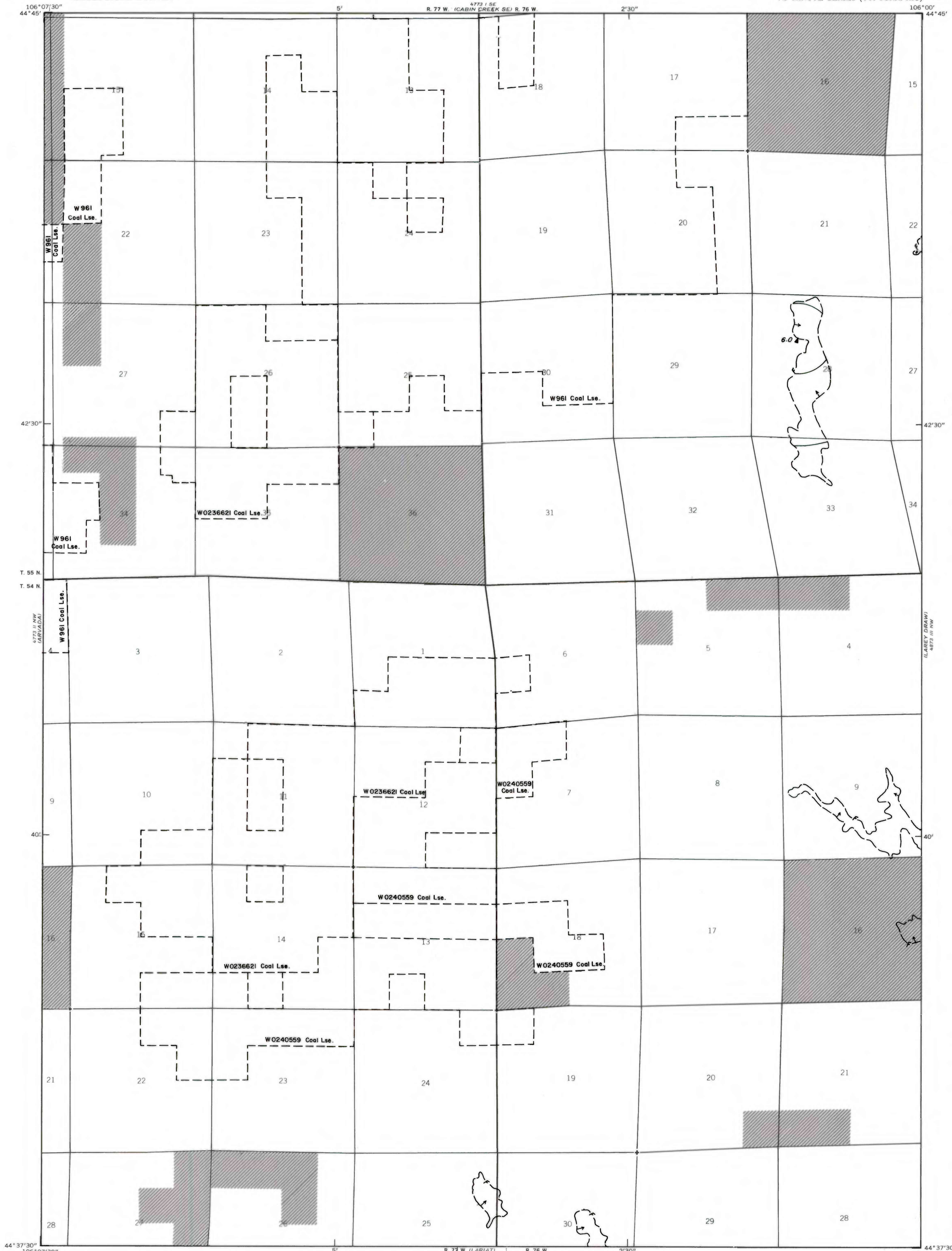

**EXPLANATION**

NON-FEDERAL COAL LAND-Coal tonnages not evaluated.

W961 Coal Lse.  
COAL LEASE-Coal Lse. Coal tonnages not evaluated.

TRACE OF COAL BED OUTCROP-Arrow points toward the coal-bearing area. Coal bed dashed where inferred or projected.

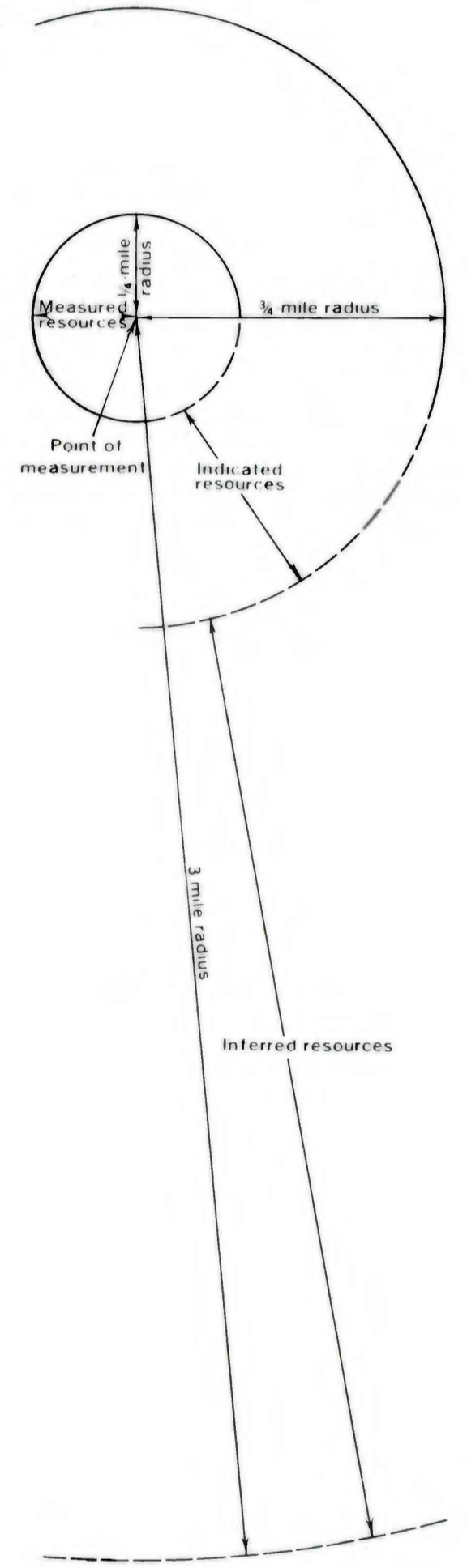

**BOUNDARY LINES**-Enclosing areas of measured, indicated and inferred coal resources of the coal bed. Hypothetical resources beyond 3 miles.

To convert miles to kilometers, multiply miles by 1.609.

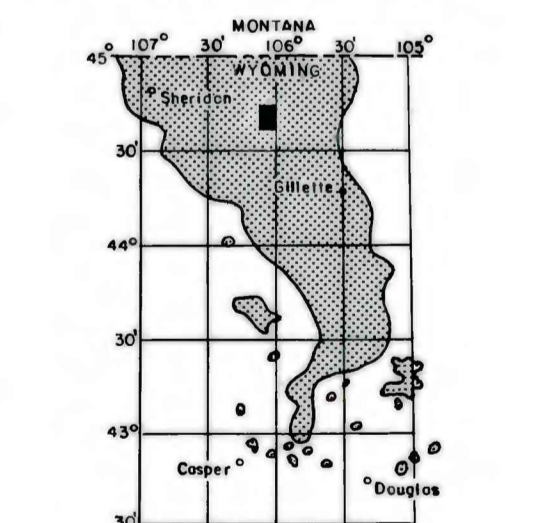

MAP SHOWING LOCATION OF THE ARVADA NE QUADRANGLE AND THE POWDER RIVER BASIN KNOWN RECOVERABLE COAL RESOURCE AREA (STIPPLED), WYOMING

5273 (REV. 11-80)  
(ARVADA DRAWN)

Base from U.S. Geological Survey, 1971

Compiled in 1980

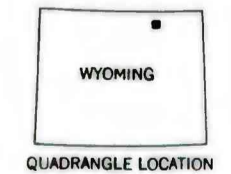
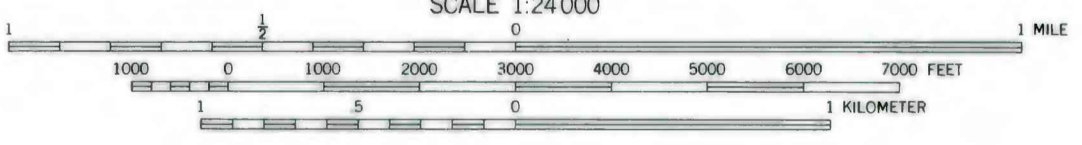
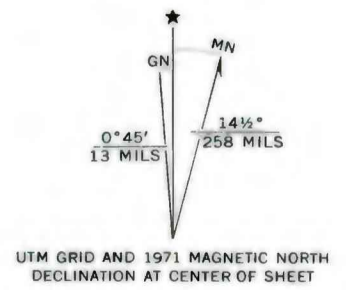

**COAL RESOURCE OCCURRENCE MAP OF THE ARVADA NE QUADRANGLE, SHERIDAN AND CAMPBELL COUNTIES, WYOMING**  
BY  
**intraSearch**  
1980

**PLATE 7**  
**AREAL DISTRIBUTION OF IDENTIFIED RESOURCES OF FELIX COAL BED**

This report has not been edited for conformity with U. S. Geological Survey editorial standards or stratigraphic nomenclature.