

EXPLANATION

● 1172  
● 103

DRILL HOLE—Showing thickness of overburden, in feet, from the surface to top of coal bed. Lower number indicates interburden thickness, in feet, between upper and lower splits of coal bed.

—— 1250 ——

OVERBURDEN ISOPACH—Showing thickness of overburden, in feet, from the surface to the top of the coal bed. Isopach interval 250 feet.

To convert feet to meters, multiply feet by 0.3048.

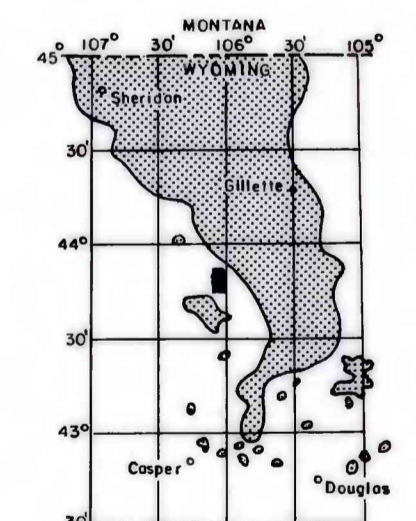

MAP SHOWING LOCATION OF THE FORT RENO SE QUADRANGLE AND THE POWDER RIVER BASIN KNOWN RECOVERABLE COAL RESOURCE AREA (STIPPLED), WYOMING

This report has not been edited for conformity with U. S. Geological Survey editorial standards or stratigraphic nomenclature.

COAL RESOURCE OCCURRENCE MAP OF THE FORT RENO SE QUADRANGLE, JOHNSON AND CAMPBELL COUNTIES, WYOMING

BY  
IntraSearch  
1980

PLATE 11  
ISOPACH MAP OF  
OVERBURDEN OF  
LOCAL "A" COAL BED

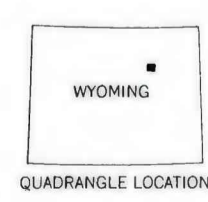
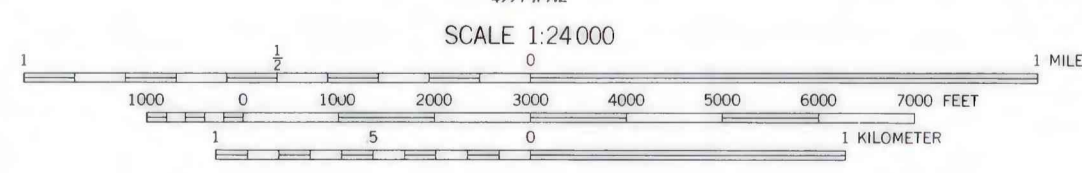
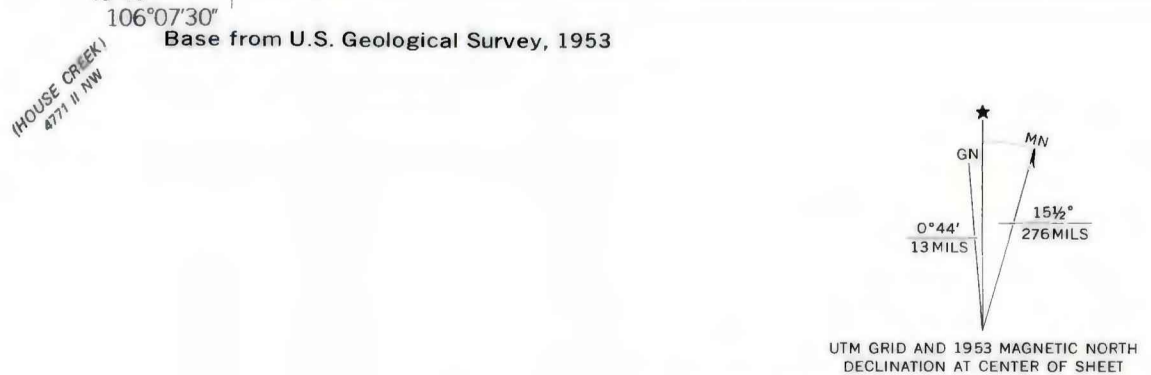

Base from U.S. Geological Survey, 1953

Compiled in 1980