

UNITED STATES
DEPARTMENT OF THE INTERIOR
GEOLOGICAL SURVEY

WILBURTON QUADRANGLE
OKLAHOMA-LATIMER CO.
7.5 MINUTE SERIES (TOPOGRAPHIC)

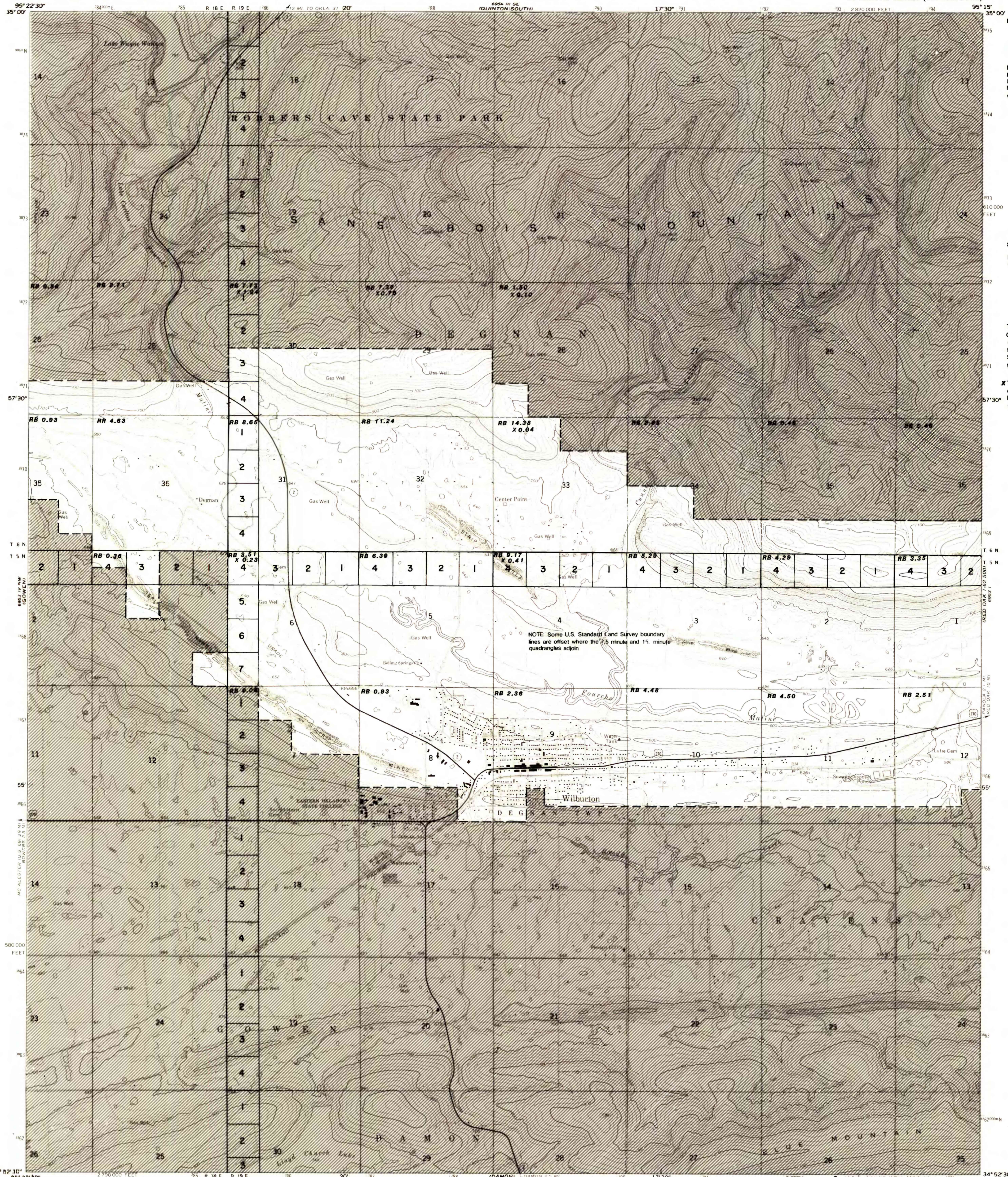

EXPLANATION

NON-FEDERAL COAL LAND - Land for which the Federal Government does not own the coal rights. For all other land area, the Federal Government holds title to the coal mineral rights, without regard to surface ownership.

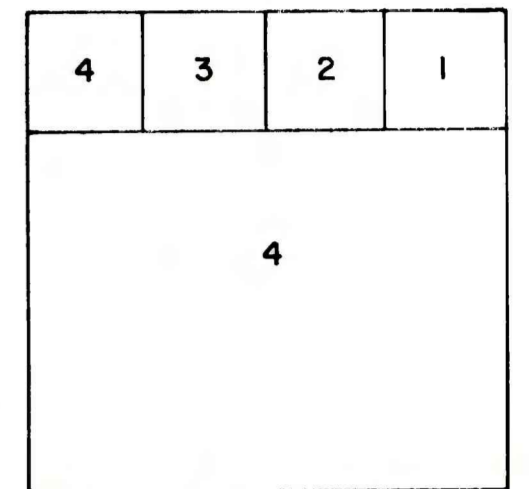

SECTION OF LAND - Showing lots and lot numbers.

NOTE: BLM coal ownership data current as of October 19, 1979.

RB 2.0

TOTAL RESERVE BASE (RB) OF FEDERAL COAL PER SECTION - In millions of short tons, calculated for each section of Federal land following the guidelines given in U.S. Geol. Survey Bulletin 1450-B. To convert short tons to metric tons, multiply short tons by 0.9072.

X This portion of the Reserve Base tonnage was obtained from Areal Distribution and Identified Resources Maps of non-isopached coal beds which were not open-filed.

NOTE: Some U.S. Standard Land Survey boundary lines are offset where the 7.5 minute and 15 minute quadrangles adjoin.

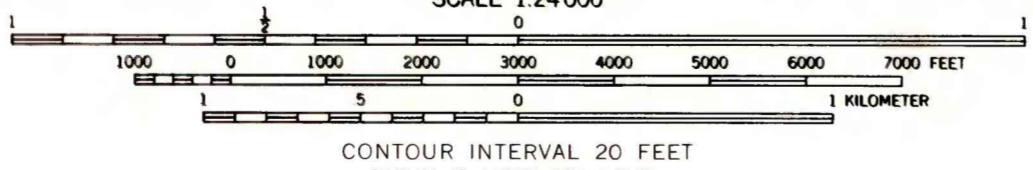
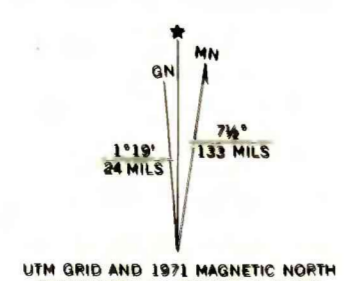

CONTOUR INTERVAL 20 FEET
DATUM IS MEAN SEA LEVEL



THIS MAP COMPLIES WITH NATIONAL MAP ACCURACY STANDARDS
FOR SALE BY U. S. GEOLOGICAL SURVEY, DENVER, COLORADO 80225, OR WASHINGTON, D. C. 20242
AND BY THE OKLAHOMA GEOLOGICAL SURVEY, NORMAN, OKLAHOMA 73069
A FOLDER DESCRIBING TOPOGRAPHIC MAPS AND SYMBOLS IS AVAILABLE ON REQUEST

WILBURTON, OKLA.
N3452.5-W9515/7.5

1971
AMS 6953 IV NE, SERIES V883