

UNITED STATES DEPARTMENT OF THE INTERIOR GEOLOGICAL SURVEY

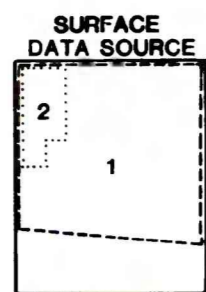

Refer to Appendix I for point by point subsurface data source

- 1. HENDRICKS, T. A., 1939
- 2. RUSSELL, D. T., 1960

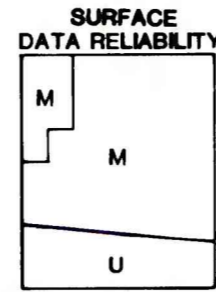

Refer to Appendix I for a point by point subsurface data reliability

- M-MEDIUM, detailed mapping, prior to modern topographic base map.
- U-UNMAPPED

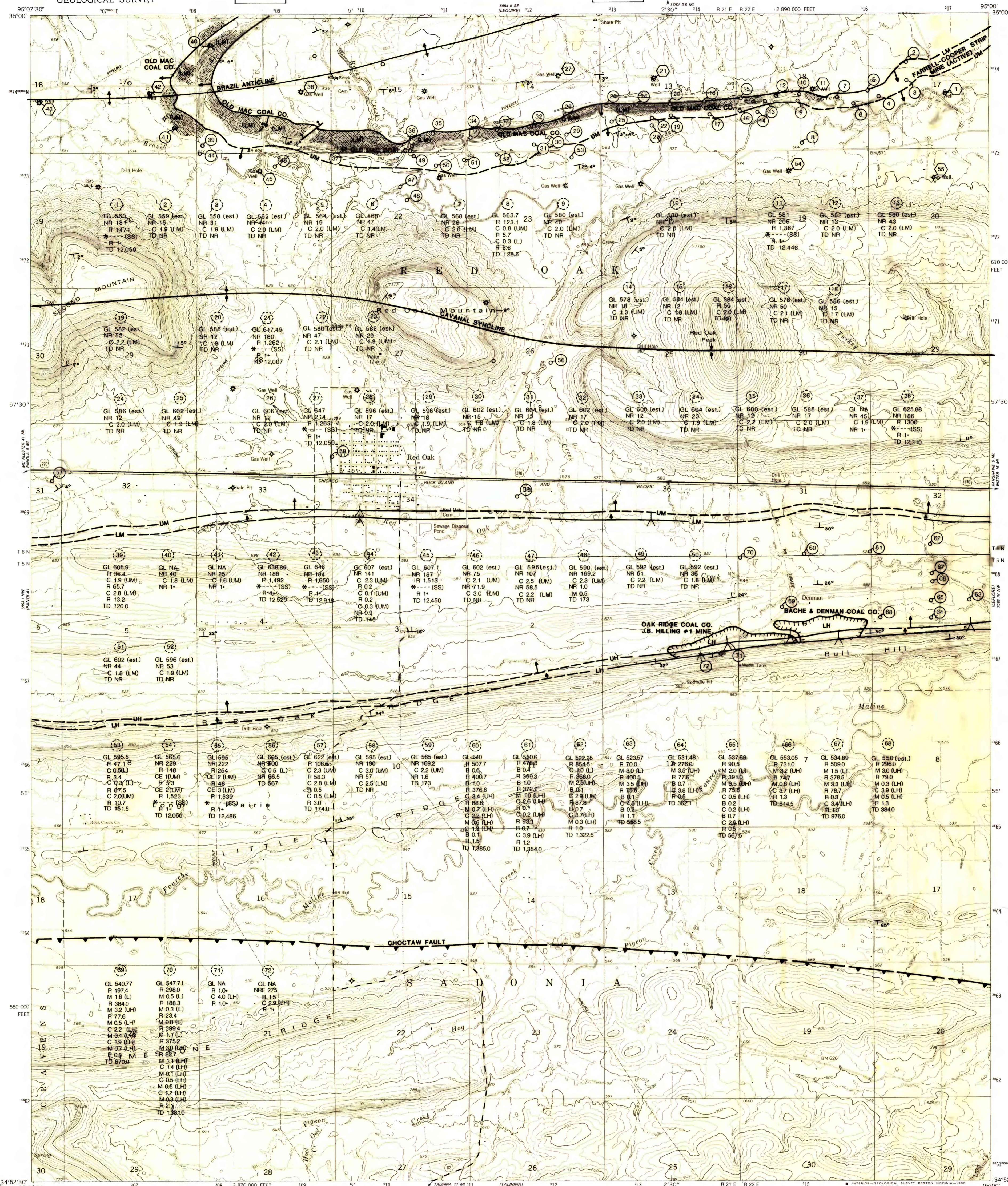

EXPLANATION

- Location or drilling well
- Gas Well
- Dry Hole
- Oil Well
- Oil & Gas Well
- Abandoned Oil Well
- Abandoned Gas Well
- Well Symbols

WELL LOGS - Showing well data in feet. Letters designate either the coal bed name as listed below, or the top of the Hartshorne sandstone formation...

COAL TEST HOLE - Showing drill-hole data in feet. Letters designate name of coal bed as listed below...

COMPOSITE MINE SECTION - Abandoned mine, showing rock interval and thickness of coal, in feet...

LINE OF MEASURED SECTION - Showing coal and rock thickness, in feet. Letters and numbers designate name of coal bed as listed below...

- Dashed index symbols indicate location of record elsewhere
- Ground level elevation
- Rock interval
- Coal interval (measured)
- Gross Coal interval (estimated from well log)
- Mixed Coal & Rock
- Bone Coal
- No record of lithology
- No record of lithology, thickness estimated
- Total depth

NOTE: Thickness reported to tenths of feet only when resolution of data permitted

- Local (unnamed) coal bed
- Secor Coal
- Upper McAlester (Sliger) Coal
- Lower McAlester (Sliger) Coal
- Lower Hartshorne Coal
- Lower Hartshorne Coal
- Hartshorne Coal
- COAL BED SYMBOLS AND NAMES

TRACE OF COAL BED OUTCROP - Showing thickness of coal in feet measured at triangle. Letters designate name of coal bed as listed above...

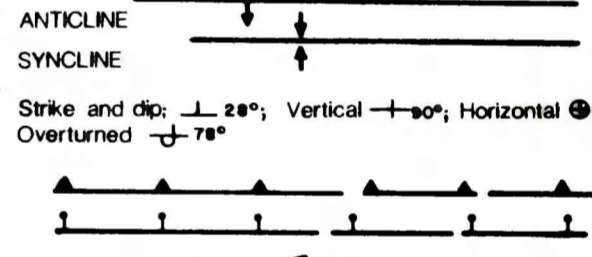

FAULT - Dashed where approximately located. Thrust faults have sawtooth on upthrown or overthrust side...

- Coal mine active
- Coal mine, inactive or abandoned
- Slope entry, inactive or abandoned
- Prospect pit
- Subsurface coal mine showing name of mine and beds removed...
- Surface coal mine showing name of beds removed...

COAL MINE SYMBOLS. To convert feet to meters, multiply feet by 0.3048.

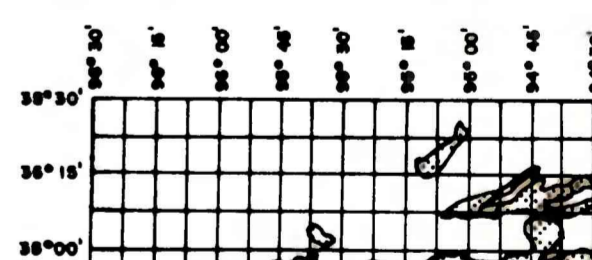

NOTE: This report has not been edited for conformity with Geological Survey editorial standards or stratigraphic nomenclature.

This report was prepared under contract to the U.S. Geological Survey, and has not been edited for conformity with Geological Survey editorial standards or stratigraphic nomenclature.

FEDERAL COAL RESOURCE OCCURRENCE MAP OF THE NORTHEAST QUARTER OF THE RED OAK 15-MINUTE QUADRANGLE, LATIMER COUNTY, OKLAHOMA

COMPILED IN 1980

This map intended for land use planning purposes only.

BY GEOLOGICAL SERVICES OF TULSA, INC., AND B. T. BRADY, USGS

PLATE 1 COAL DATA MAP

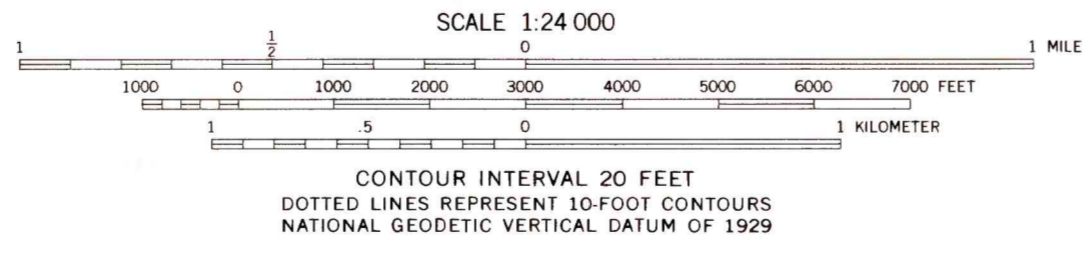

CONTOUR INTERVAL 20 FEET. DOTTED LINES REPRESENT 10-FOOT CONTOURS. NATIONAL GEODETIC VERTICAL DATUM OF 1929

UTM GRID AND 1979 MAGNETIC NORTH DECLINATION AT CENTER OF SHEET