



EXPLANATION

 NON-FEDERAL COAL LAND

 KRCRA
KNOWN RECOVERABLE COAL RESOURCE
AREA-KRCRA

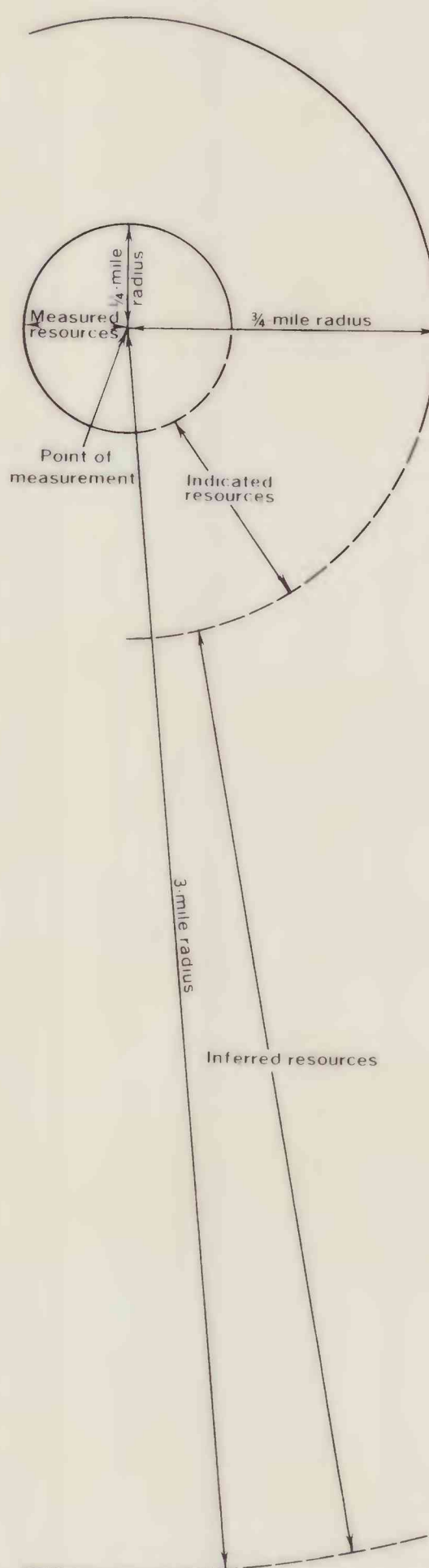

BOUNDARY LINES-Enclosing areas of measured, indicated and inferred coal resources of the coal bed. Dashed where projected from adjacent quadrangles. Hypothetical resources beyond 3 miles.

To convert miles to kilometers, multiply miles by 1.069.

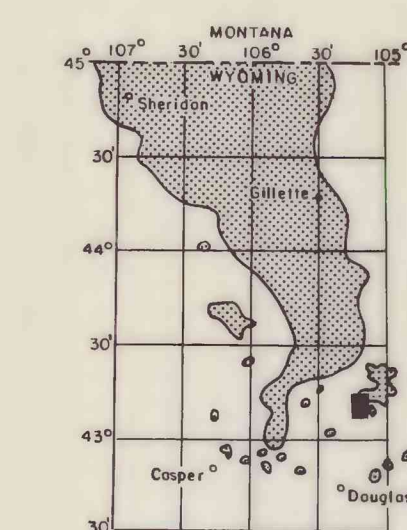

MAP SHOWING LOCATION OF THE BILL 4 NW QUADRANGLE AND THE POWDER RIVER BASIN KNOWN RECOVERABLE COAL RESOURCE AREA (STIPPLED), WYOMING

This report has not been edited for conformity with U.S. Geological Survey editorial standards or stratigraphic nomenclature.

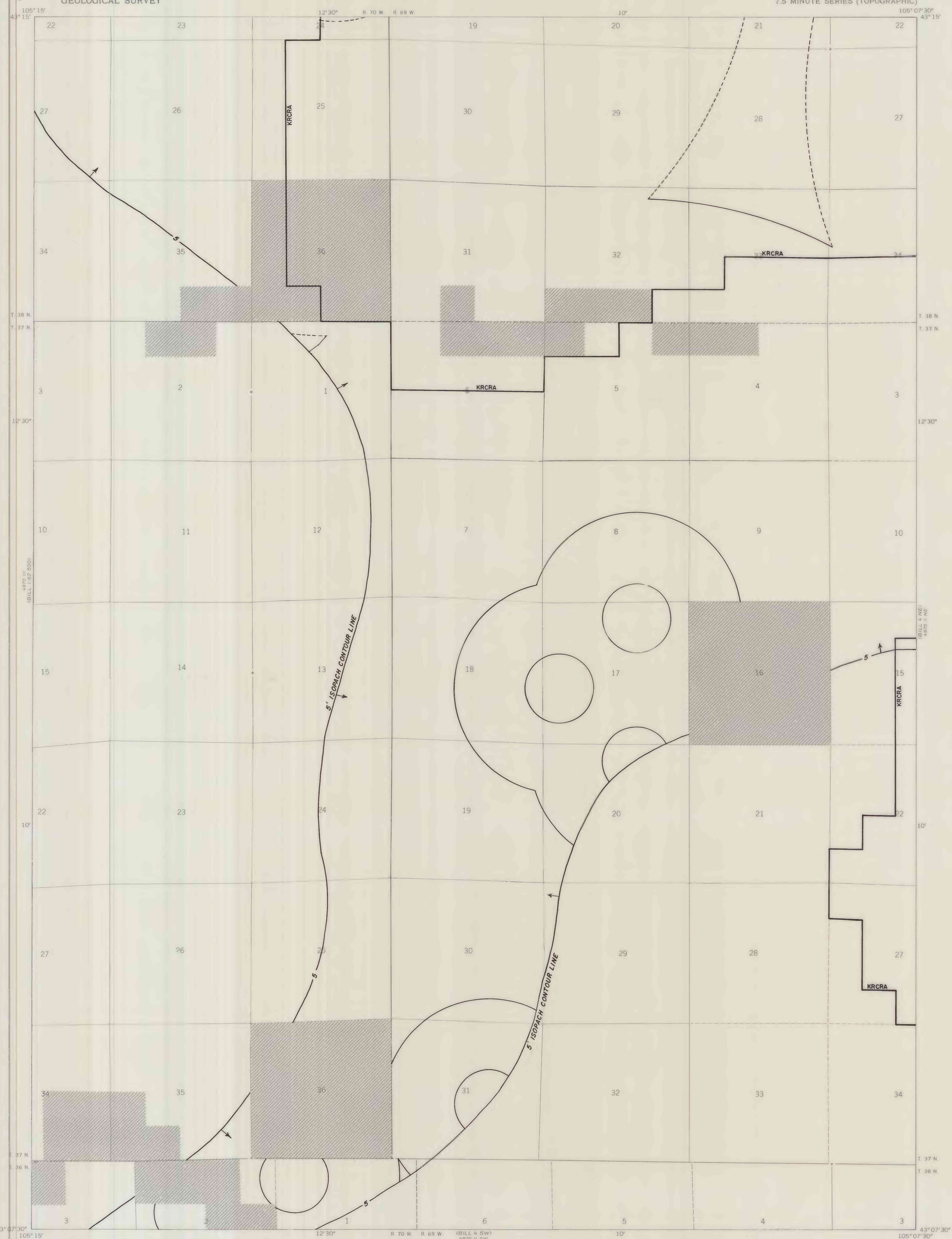

Base from U.S. Geological Survey, 1970

SCALE 1:24,000

Compiled in 1979

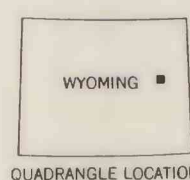
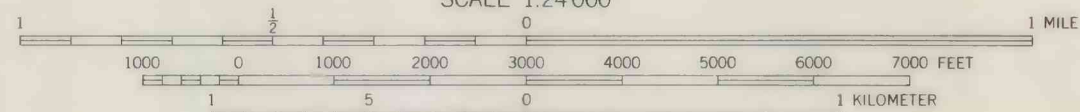
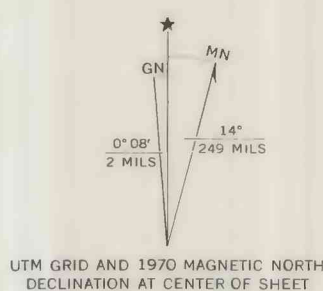

COAL RESOURCE OCCURRENCE MAP OF THE BILL 4 NW
QUADRANGLE, CONVERSE COUNTY, WYOMING

BY
IntraSearch
1979

PLATE 7
AREAL DISTRIBUTION OF
IDENTIFIED RESOURCES OF
LOWER WILDCAT COAL BED