

EXPLANATION

9000

STRUCTURE CONTOURS—Drawn on top of coal bed. Solid where vertical accuracy within 25 feet; long dashed where vertical accuracy possibly not within 25 feet; short dashed where projected above land surface. Contour interval is 50 feet (15.2m). Datum is mean sea level.

8463

POINT OF MEASUREMENT—Showing altitude of top of coal bed, in feet.

3B

TRACE OF COAL BED OUTCROP—Showing symbol of name of coal bed. Arrow points toward coal-bearing area. Dashed where inferred by present authors.

1

FAULT—Dashed where approximately located; bar and ball on downthrown side.

To convert feet to meters, multiply feet by 0.3048.

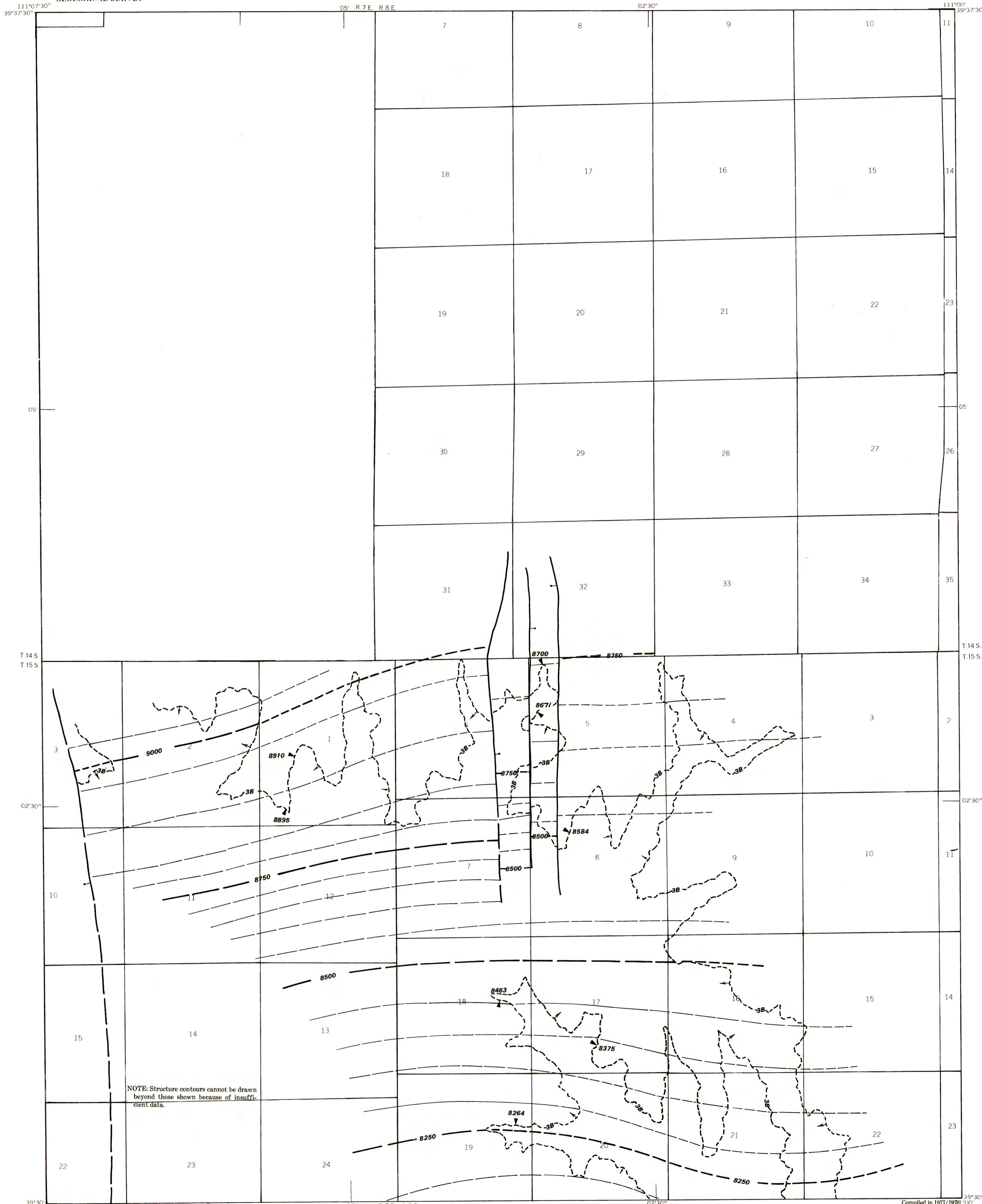

NOTE: Structure contours cannot be drawn beyond those shown because of insufficient data.

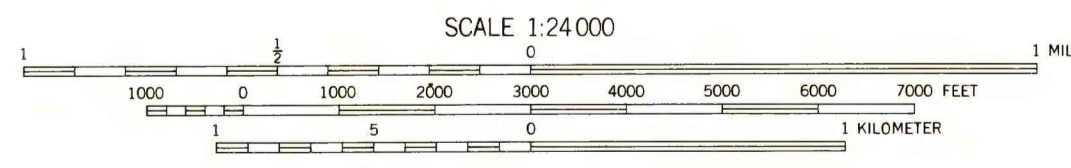

COAL RESOURCE OCCURRENCE MAP OF THE SOUTHEAST QUARTER OF THE SCOFIELD 15 - MINUTE QUADRANGLE, CARBON AND EMERY COUNTIES, UTAH BY AAA ENGINEERING AND DRAFTING, INC. 1979