

KENANSVILLE NE QUADRANGLE, FLORIDA  
1953, PHOTOREVISED 1972,  
7.5-minute series, 1:24000

**INTRODUCTION**

Brevard County is an area of some 1,300 square miles located on the east coast of central Florida. The Kenansville NE quadrangle, in south Brevard, includes part of the St. Johns River valley with extensive areas of relatively low marshlands. The western edge of the quadrangle lies in Osceola County (sheet D).

**PURPOSE AND SCOPE**

The purpose of this report is to present ground-water data in a usable, readily available format for county planning needs. The scope includes a complete inventory of wells, water-level measurements in selected wells, sampling selected wells for water-quality analysis, literature search, and storage of all data in the U.S. Geological Survey computer bank or manual data library. Wells shown on sheet 1 are those used in the preparation of this report.

**Brevard Water Well Survey**

This report was prepared by the U.S. Geological Survey and the Brevard Water Well Survey team in cooperation with the Brevard County Board of County Commissioners. The Brevard Water Well Survey is funded through the Comprehensive Education and Training Act and sponsored by Brevard County through the Development Division, Brevard County Planning Department. Primary supervision of the Brevard Water Well Survey was under the U.S. Geological Survey as principal investigators. The following Brevard Water Well Survey team members were instrumental in the production of this report: Gary Brown, Steven Frazee, Charles Marple,

Wayne Thompson, and Richard Wheelus. The Brevard Water Well Survey consisted of as many as 19 members during the course of the investigation.

**ACKNOWLEDGMENTS**

The authors wish to acknowledge the assistance of the Brevard County Planning Department, County Engineers office, Cartography Department, South Brevard Water Resources Committee, Agricultural Extension Service, the well drillers of Brevard County, and the cooperation of local residents.

**WELL-NUMBERING SYSTEM**

The well-numbering system used in this report is based on latitude and longitude coordinates derived from a grid of 1-minute parallels of latitude and meridians of longitude (sheet D). Wells within these minute grids are assigned numbers that consist of the last digit of the degree and the two digits of the minute of the line of latitude on the south side of the grid, the last digit of the degree and the two digits of the minute of the line of longitude on the east side of the grid, and a sequence number assigned in the order in which the well within the minute grid was inventoried. For example, well number 756-050-001 was the first well inventoried in the 1-minute grid north of latitude 27°56' and west of longitude 80°50'.

In order to conserve space on sheet 1, only the well sequence number is shown. The well number can be reconstructed if necessary by gridting off the maps according to the latitude and longitude tick marks in sheet 1 and observing the methodology in the preceding paragraph.

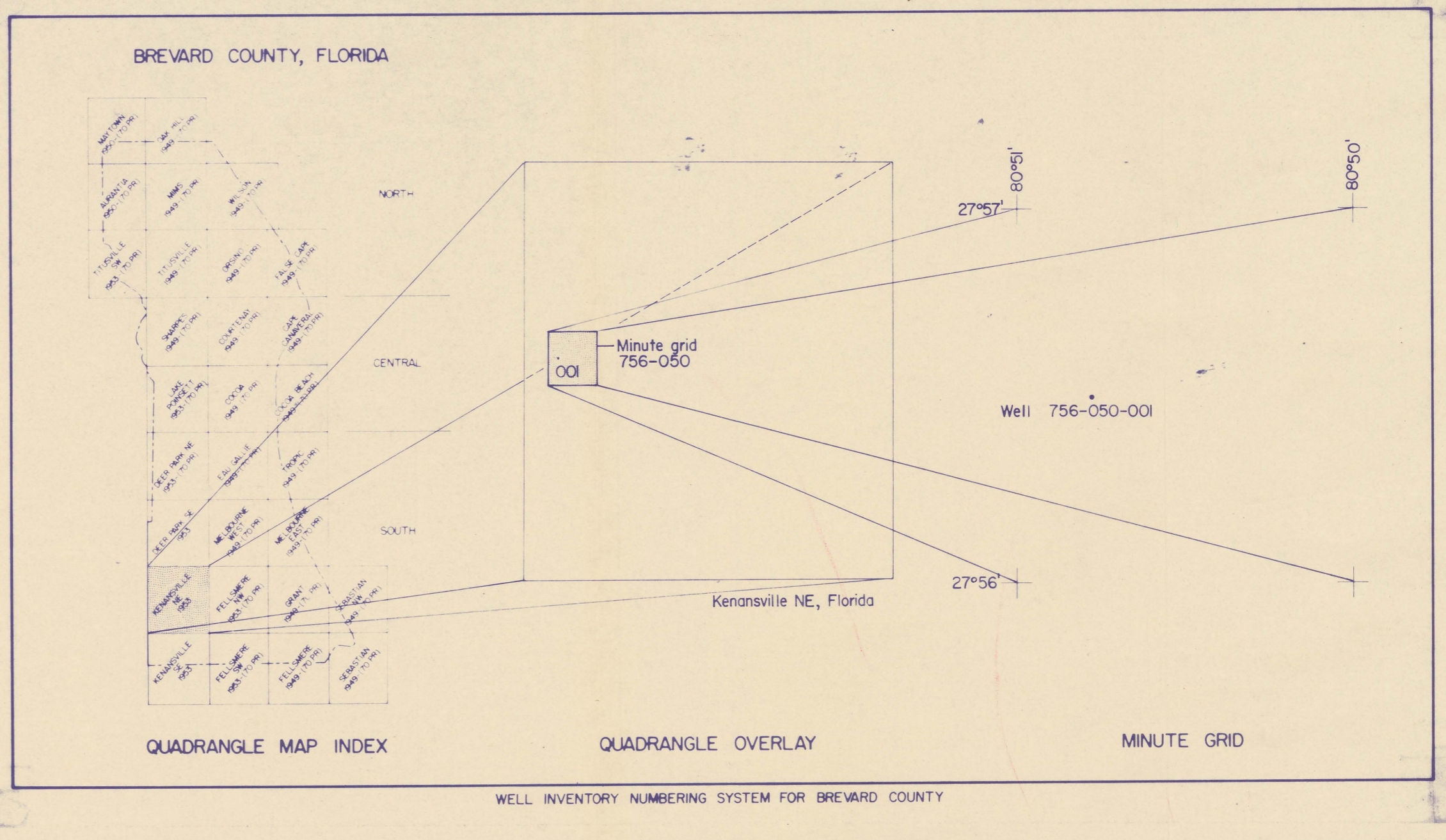

**OVERLAY MAP OF THE KENANSVILLE NE QUADRANGLE, FLORIDA; WELL LOCATIONS AND NUMBERING SYSTEM AND QUADRANGLE MAP INDEX, BREVARD COUNTY**

By  
James M. Frazee, Jr.  
and  
C. P. Laughlin  
1979

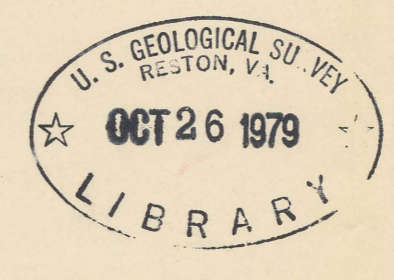

*Handwritten notes:*  
M(200)  
R290  
79-507  
Sheet 1  
C.P.

