

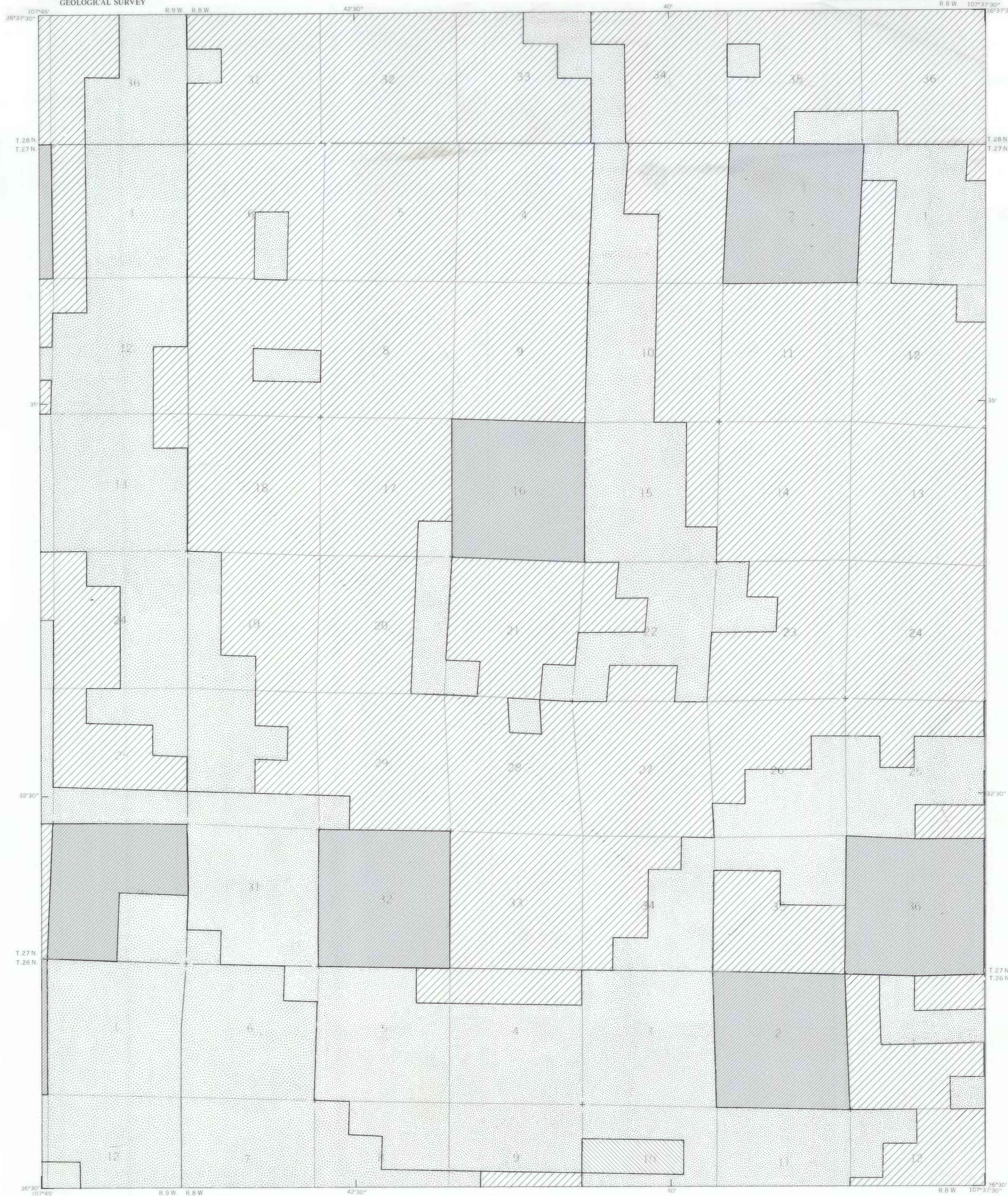

UNITED STATES
DEPARTMENT OF THE INTERIOR
GEOLOGICAL SURVEY

SW¼ OF GOULD PASS 15' QUADRANGLE
NEW MEXICO-SAN JUAN-RIO ARRIBA COS.



EXPLANATION

 NON-FEDERAL COAL LAND - Land for which the Federal Government does not own the coal rights, and for which the coal development potential is not rated.

 AREA OF MODERATE COAL DEVELOPMENT POTENTIAL FOR SUBSURFACE MINING METHODS - Includes areas underlain by coal of the Fruitland 1, Fruitland 2, and Fruitland 3 beds. Area has overburden thickness ranging from 1000 to 2000 feet (305-610 m).

 AREA OF LOW COAL DEVELOPMENT POTENTIAL FOR SUBSURFACE MINING METHODS - Includes areas underlain by coal of the Fruitland 1, Fruitland 2, and Fruitland 3 beds. Area has overburden thickness ranging from 2000 to 3000 feet (610-914 m).

 AREA OF UNKNOWN COAL DEVELOPMENT POTENTIAL FOR SUBSURFACE MINING METHODS - Includes areas with coal thickness less than 3 feet (1.5 m) and areas outside the 3000-foot (914 m) overburden study limit.

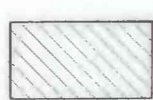
 AREA OF NO COAL DEVELOPMENT POTENTIAL FOR SUBSURFACE MINING METHODS - Includes areas with no Fruitland 1, Fruitland 2 and Fruitland 3 coal.

Base from U.S. Geological Survey, 1959

Compiled in 1979

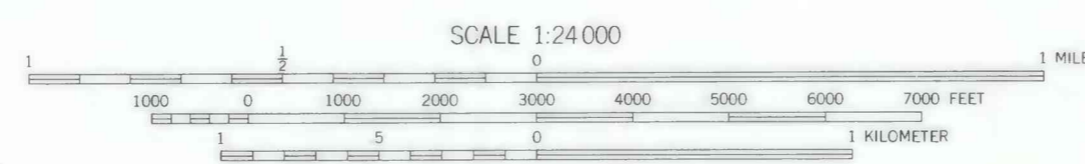

**COAL DEVELOPMENT POTENTIAL MAP OF THE SOUTHWEST QUARTER OF THE
GOULD PASS 15-MINUTE QUADRANGLE, SAN JUAN AND RIO ARRIBA COUNTIES, NEW MEXICO**

**BY
DAMES & MOORE
1979**

**PLATE 16
COAL DEVELOPMENT POTENTIAL
FOR SUBSURFACE MINING METHODS**

This map was prepared under contract to the U.S. Geological Survey and has not been edited for conformity with Geological Survey editorial standards. Opinions and conclusions expressed herein do not necessarily represent those of the Geological Survey.