

MESA DE LOS TOROS  
4451.15E  
1422.113E

UNITED STATES  
DEPARTMENT OF THE INTERIOR  
GEOLOGICAL SURVEY

SAN LUCAS DAM QUADRANGLE  
NEW MEXICO-MCKINNEY CO.  
7.5 MINUTE SERIES (TOPOGRAPHIC)

OPEN FILE REPORT 79-636  
PLATE 2 OF 14

This report has not been edited  
for conformity with Geological  
Survey editorial standards or  
stratigraphic nomenclature.

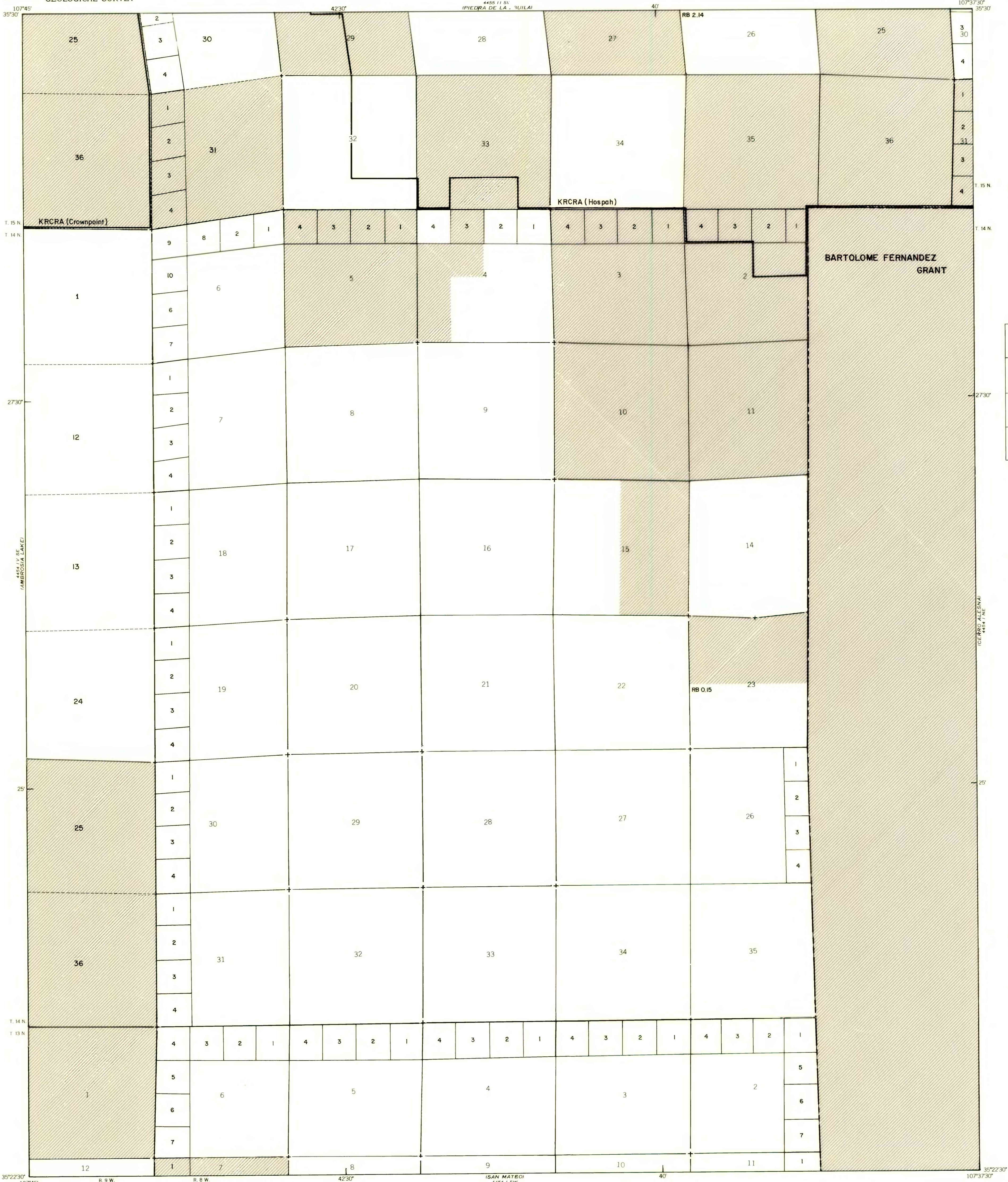

EXPLANATION

NON-FEDERAL COAL LAND—Land for which the Federal Government does not own the coal rights

TOTAL RESERVE BASE (RB) of COAL PER SECTION—In millions of short tons, calculated for each section of Federal land following the guidelines given in U. S. Geol. Survey Bulletin 1450-B. To convert short tons to metric tons, multiply short tons by 0.9072.

4	3	2	1
5	6		
6			
7			

SECTION OF LAND—Showing lots and lot numbers

KRCRA (Crownpoint)—Known Recoverable Coal Resource Area for Crownpoint area.

NOTE: BLM coal ownership data current as of Oct. 26, 1978.

NOTE: Refer to coal resources section of text for departures from U.S. Geological Survey Bulletin 1450-B.

NOTE: All section lines short dashed ----- are projected & shown in approximate locations only. Certified data not available. Refer to B.L.M. MT plats for related information.

Base from U.S. Geological Survey, 1963

Compiled in 1978

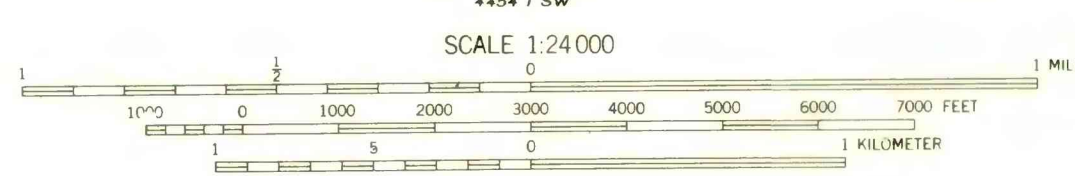
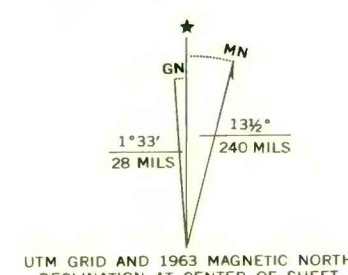

COAL RESOURCE OCCURRENCE MAP OF THE SAN LUCAS DAM  
QUADRANGLE, MCKINNEY COUNTY, NEW MEXICO  
BY  
BERGE EXPLORATION, INC.  
1979

PLATE 2  
BOUNDARY AND COAL  
DATA MAP