

This report has not been edited for conformity with Geological Survey editorial standards or stratigraphic nomenclature.

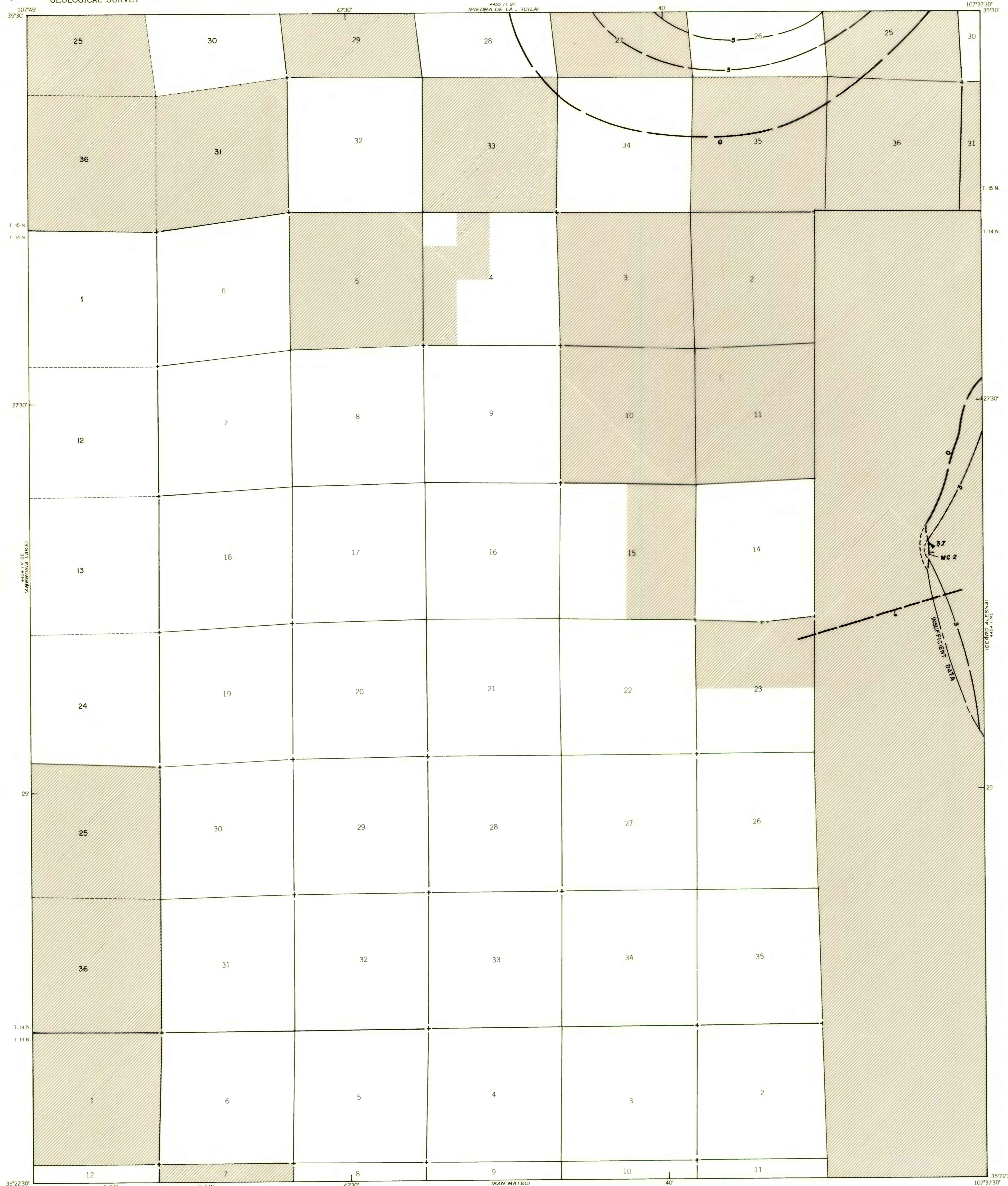

EXPLANATION

ISOPACHS OF THE MENEFEE CLEARY NO. 2 COAL BED—Showing thickness in feet. Isopach interval 5 feet (1.5 meters) with 3 foot (0.9 meter) supplemental isopach added. Isopachs long dashed where inferred and short dashed where projected through non coal-bearing areas.

TRACE OF COAL BED OUTCROP—Showing coal thickness, in feet, measured at triangle. Arrow points toward the coal-bearing area. Dashed line indicates inferred outcrop.

FAULT—Dashed where approximately located; bar and bell on down-thrown side.

To convert feet to meters, multiply feet by 0.3048.

NOTE:
All section lines short dashed ----- are projected & shown in approximate locations only. Certified data not available. Refer to B.L.M. MT plats for related information.

Base from U.S. Geological Survey, 1963

Compiled in 1978

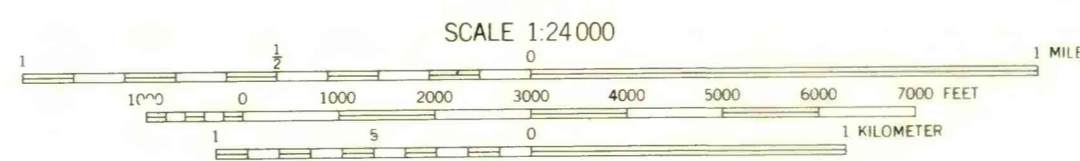
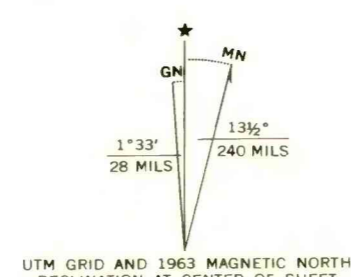

COAL RESOURCE OCCURRENCE MAP OF THE SAN LUCAS DAM
QUADRANGLE, MCKINNEY COUNTY, NEW MEXICO
BY
BERGE EXPLORATION, INC.
1979