

55° 15' W
AND CREEK

UNITED STATES
DEPARTMENT OF THE INTERIOR
GEOLOGICAL SURVEY

BAR V RANCH QUADRANGLE
MONTANA—BIG HORN CO.
7.5 MINUTE SERIES (TOPOGRAPHIC)

OPEN FILE REPORT 79-643
PLATE 7 OF 25

OPEN-FILE REPORT
This report has not been edited for conformity with
U.S. Geological Survey editorial standards or
stratigraphic nomenclature.

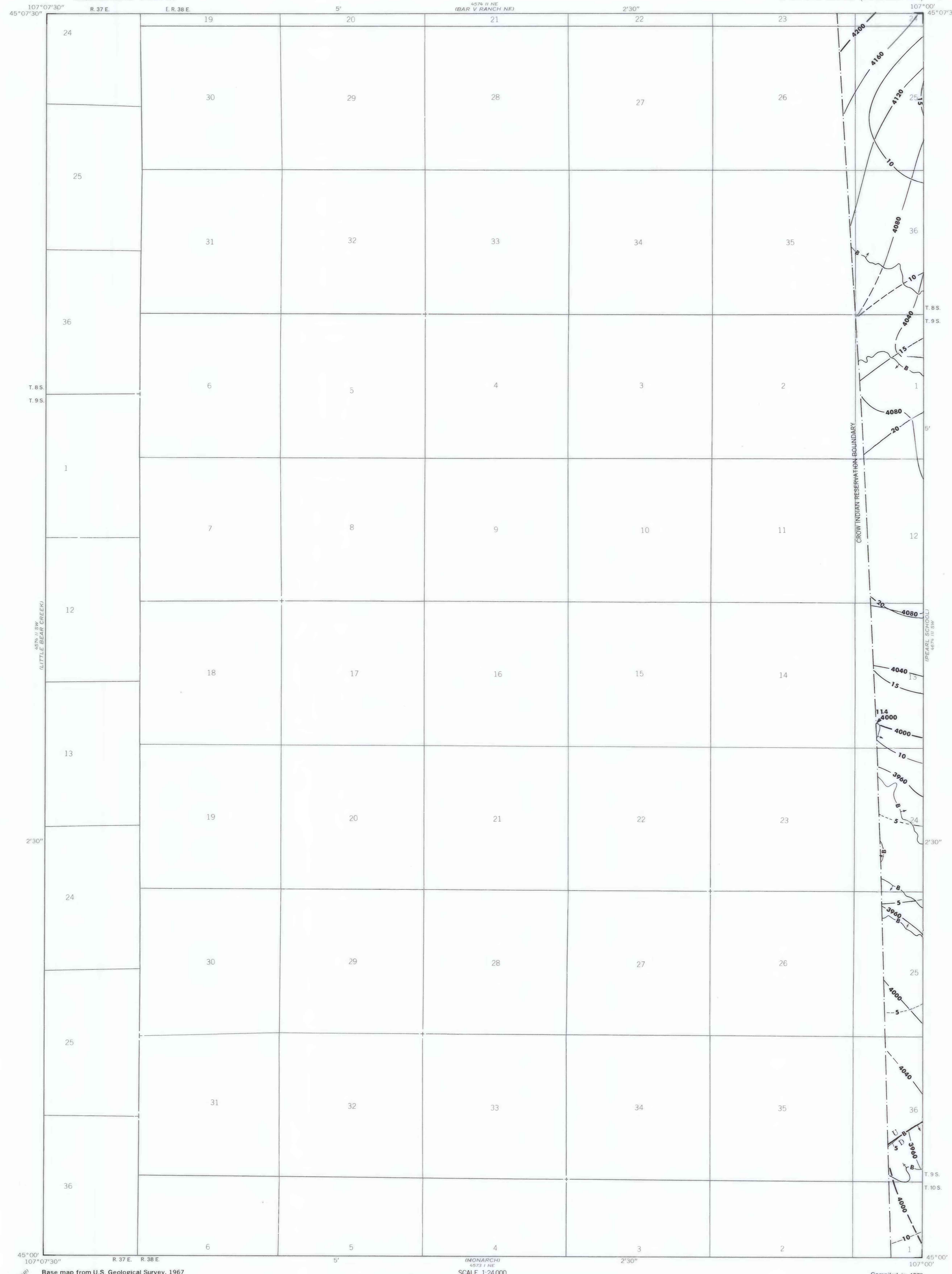

EXPLANATION

— 20 —
— 15 —

ISOPACHS OF THE COAL BED—Showing thickness, in feet. Isopach interval 5 feet.

— 4200 —
— 4160 —

STRUCTURE CONTOURS—Drawn on the top of the coal bed. Dashed where projected beyond boundary of coal. Contour interval 40 feet (12.2 m). Datum is mean sea level.

11.4
4000

BOUNDARY OF COAL DEPOSIT—Drawn along the outcrop of coal bed and/or the contact between burned and unburned coal, and/or the fault boundary of the coal (dashed where inferred by present author beyond the limits of original data). Arrows point toward coal-bearing area. Numbers at triangle are coal bed thickness and altitude at the top of the coal bed, measured in feet.

U
D

FAULT—Dashed where approximately located. U, up-thrown side; D, downthrown side.

To convert feet to meters, multiply feet by 0.3048.

107° 07' 30" W
AND CREEK

Base map from U.S. Geological Survey, 1967

(MONARCH)
6573 1 NE
SCALE 1:24 000

Compiled in 1977

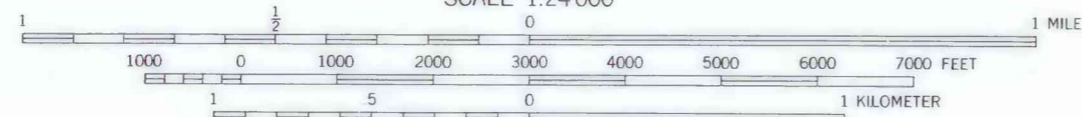
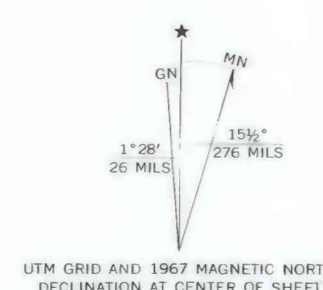

**COAL RESOURCE OCCURRENCE MAP OF THE BAR V RANCH QUADRANGLE,
BIG HORN COUNTY, MONTANA
BY
COLORADO SCHOOL OF MINES RESEARCH INSTITUTE
1979**

PLATE 7
ISOPACH AND STRUCTURE CONTOUR
MAP OF THE SMITH COAL BED