

45° 07' 30" N
107° 07' 30" W
LITTLE BEAR CREEK

UNITED STATES
DEPARTMENT OF THE INTERIOR
GEOLOGICAL SURVEY

BAR V RANCH QUADRANGLE
MONTANA—BIG HORN CO.
7.5 MINUTE SERIES (TOPOGRAPHIC)

OPEN FILE REPORT 79-643
PLATE 11 OF 25

OPEN-FILE REPORT
This report has not been edited for conformity with
U.S. Geological Survey editorial standards or
stratigraphic nomenclature.

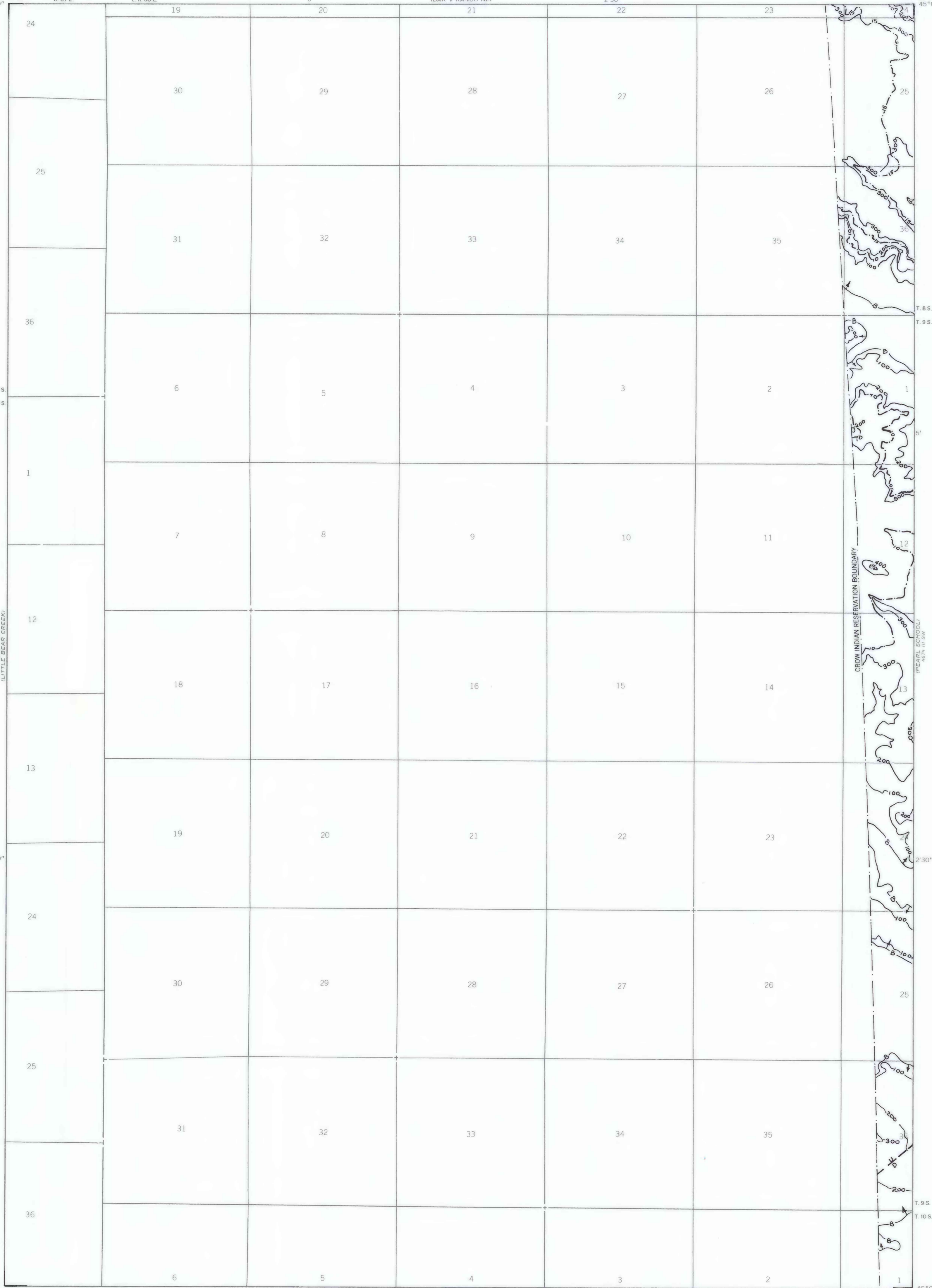

EXPLANATION

200
OVERBURDEN ISOPACH—Showing thickness of overburden, in feet, from the surface to the top of the coal bed. The 100-foot isopach is omitted where it is too close to a mining-ratio contour for map readability. Isopach interval 100 feet (30.5 m).

B
BOUNDARY OF COAL 5 FEET OR MORE THICK—Drawn along the outcrop of coal bed and/or the inferred contact between burned and unburned coal, and/or the 5-foot coal isopach. Arrows point toward area of coal 5 feet or more thick.

U
D
FAULT—Dashed where approximately located. U, up-thrown side; D, downthrown side.

10
MINING-RATIO CONTOUR—Number indicates cubic yards of overburden per ton of recoverable coal by surface-mining methods. Contours shown only in areas suitable for surface mining within the stripping limit.

To convert feet to meters, multiply feet by 0.3048.

To convert yds³/ton to m³/metric ton, multiply yds³/ton by 0.842.

Base map from U.S. Geological Survey, 1967

Compiled in 1977

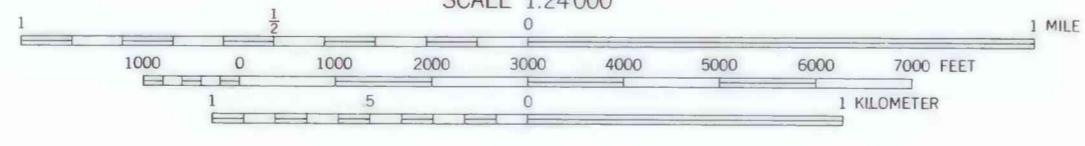
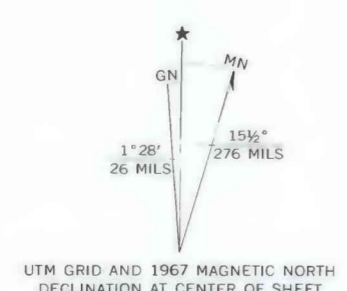

**COAL RESOURCE OCCURRENCE MAP OF THE BAR V RANCH QUADRANGLE,
BIG HORN COUNTY, MONTANA
BY
COLORADO SCHOOL OF MINES RESEARCH INSTITUTE
1979**

PLATE 11
OVERBURDEN ISOPACH AND MINING-RATIO
MAP OF THE ANDERSON (DIETZ 1) COAL BED