

45° 07' 30" N
107° 07' 30" W

UNITED STATES
DEPARTMENT OF THE INTERIOR
GEOLOGICAL SURVEY

BAR V RANCH QUADRANGLE
MONTANA—BIG HORN CO.
7.5 MINUTE SERIES (TOPOGRAPHIC)

OPEN FILE REPORT 79-643
PLATE 22 OF 25

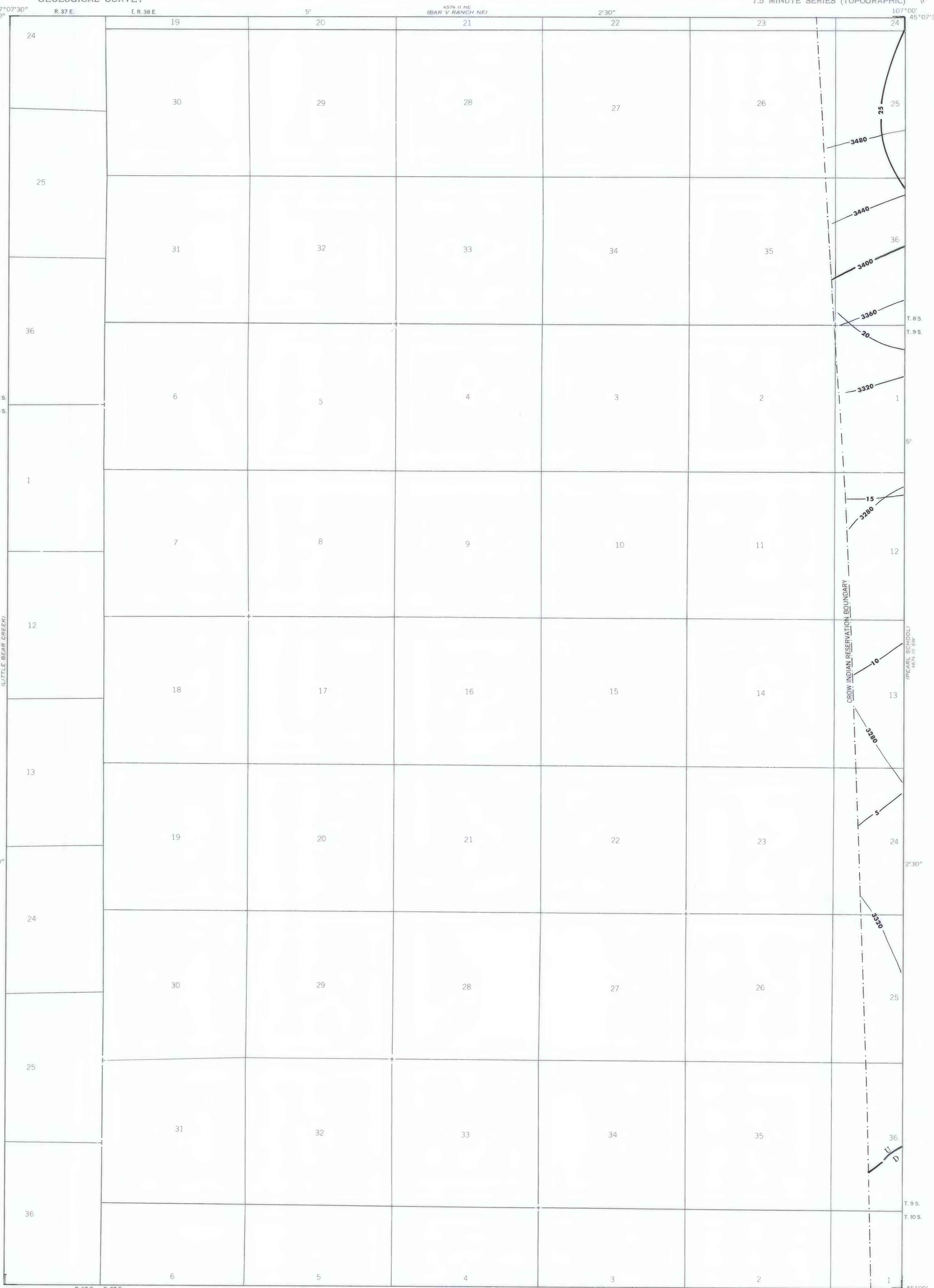

OPEN-FILE REPORT
This report has not been edited for conformity with
U.S. Geological Survey editorial standards or
stratigraphic nomenclature.

EXPLANATION

- 5 —
- 10 —
- ISOPACHS OF THE COAL BED—Showing thickness, in feet. Isopach interval 5 feet.
- 3400 —
- 3360 —
- STRUCTURE CONTOURS—Drawn on the top of the coal bed. Dashed where projected beyond boundary of coal. Contour interval 40 feet (12.2 m). Datum is mean sea level.
- To convert feet to meters, multiply feet by 0.3048.
- U
- D
- FAULT—Dashed where approximately located. U, up-thrown side; D, downthrown side.

45° 00' N
107° 07' 30" W

Base map from U.S. Geological Survey, 1967

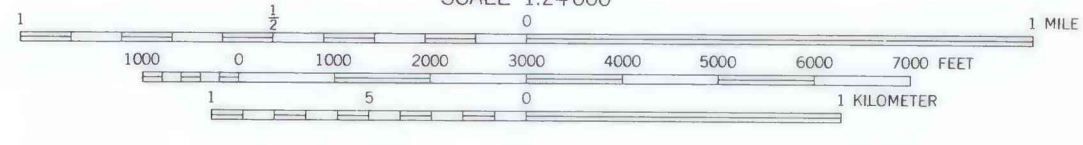
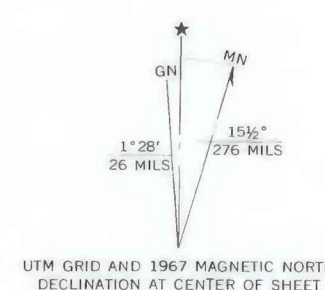

Compiled in 1977

**COAL RESOURCE OCCURRENCE MAP OF THE BAR V RANCH QUADRANGLE,
BIG HORN COUNTY, MONTANA
BY
COLORADO SCHOOL OF MINES RESEARCH INSTITUTE
1979**

PLATE 22
ISOPACH AND STRUCTURE CONTOUR
MAP OF THE WALL COAL BED