

OPEN FILE REPORT
This report has not been edited for conformity with
U.S. Geological Survey editorial standards or
stratigraphic nomenclature.

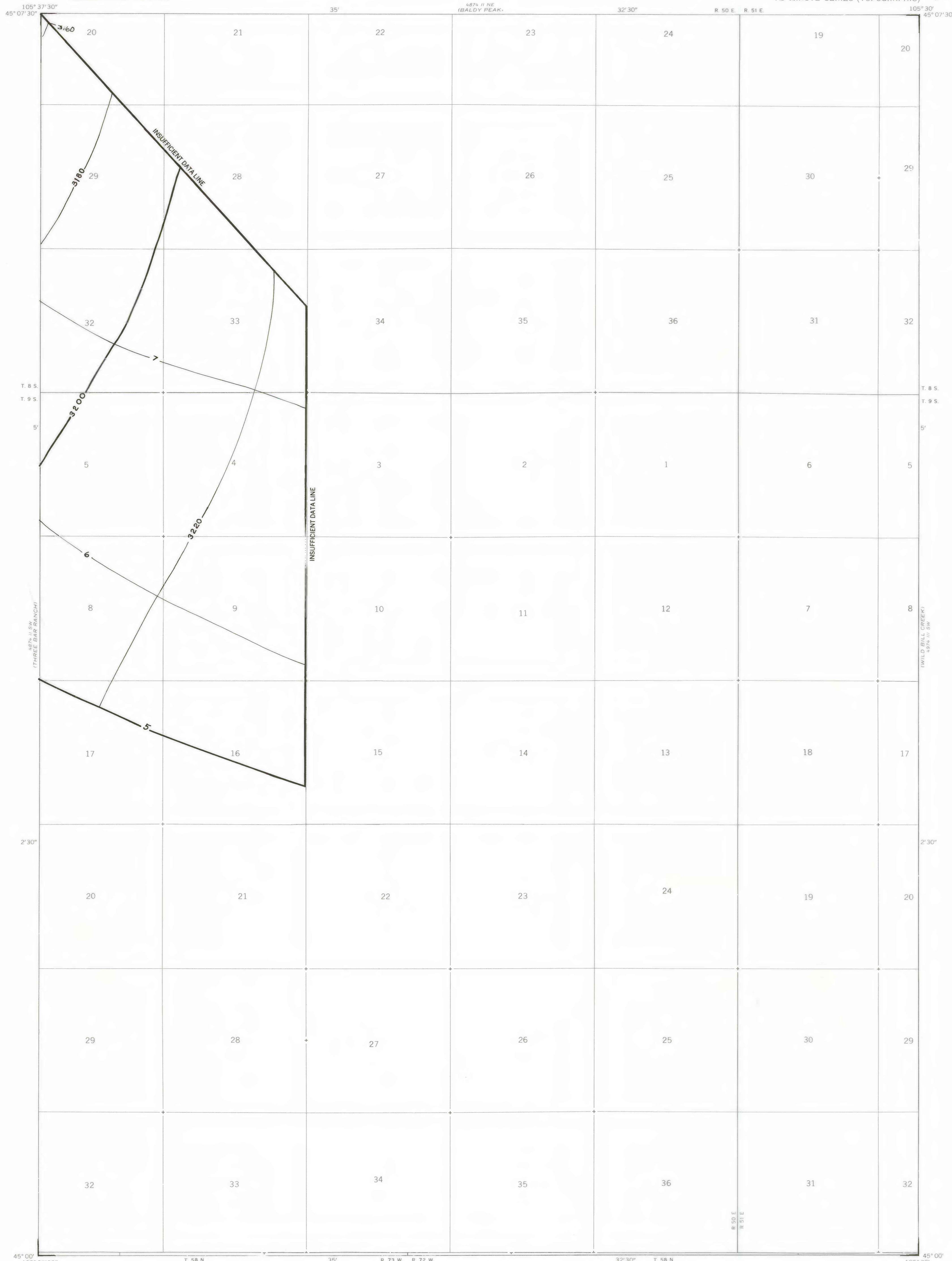

EXPLANATION

- 5 —————
 - 6 —————
- ISOPACHS OF THE COAL BED—Showing thickness, in feet. Isopach interval 1 foot.
- 3200 —————
 - 3180 —————
- STRUCTURE CONTOURS—Drawn on the top of the coal bed. Dashed where projected beyond boundary of coal. Contour interval 20 feet (6.1 m). Datum is mean sea level.
- To convert feet to meters, multiply feet by 0.3048.

Base map from U.S. Geological Survey, 1970

Compiled in 1977

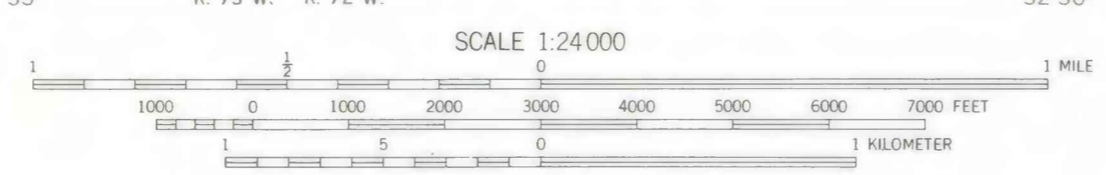
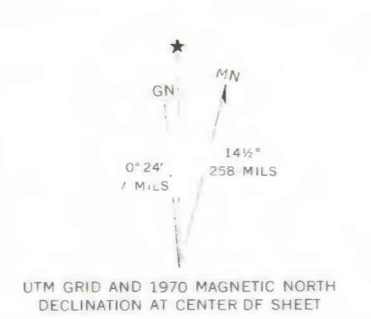

**COAL RESOURCE OCCURRENCE MAP OF THE BAY HORSE QUADRANGLE,
POWDER RIVER COUNTY, MONTANA AND CAMPBELL COUNTY, WYOMING
BY
COLORADO SCHOOL OF MINES RESEARCH INSTITUTE
1979**