

OPEN-FILE REPORT
This report has not been edited for conformity with
U.S. Geological Survey editorial standards or
stratigraphic nomenclature.

EXPLANATION

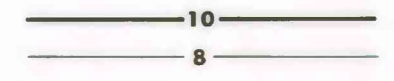

ISOPACHS OF THE COAL BED—Showing thickness, in feet. Isopach interval 2 feet, with an intermediate 5-foot isopach.

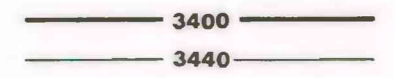

STRUCTURE CONTOURS—Drawn on the top of the coal bed. Contour interval 40 feet (12.2 m). Datum is mean sea level.

10
○ 3383

DRILL HOLE—Showing thickness and altitude at the top of the coal bed, in feet.

To convert feet to meters, multiply feet by 0.3048.

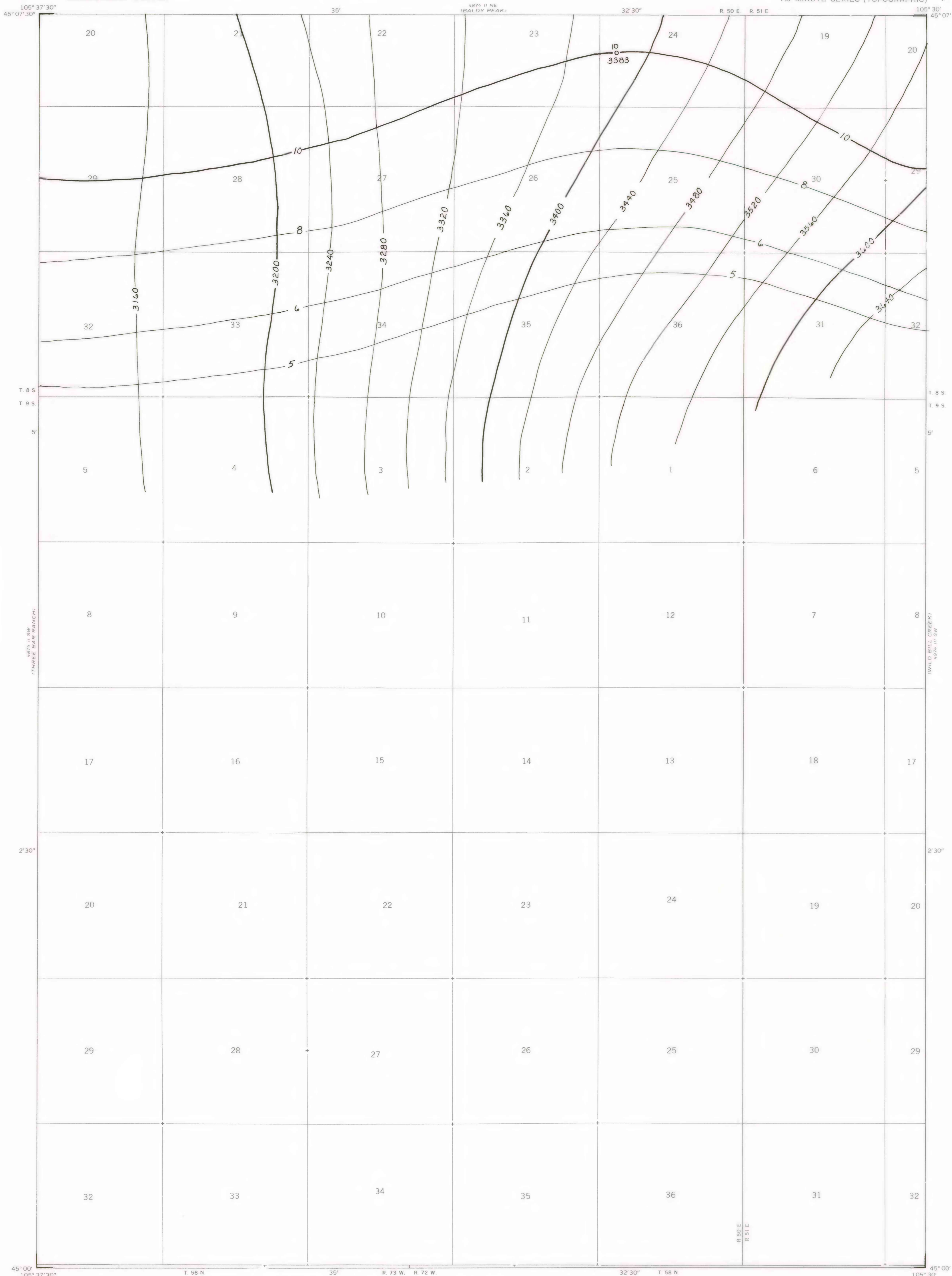

Base map from U.S. Geological Survey, 1970

SCALE 1:24000

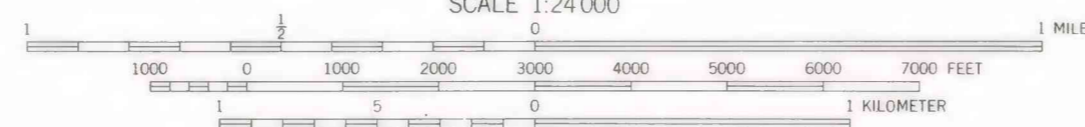

Compiled in 1977

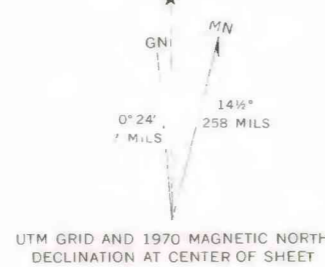

**COAL RESOURCE OCCURRENCE MAP OF THE BAY HORSE QUADRANGLE,
POWDER RIVER COUNTY, MONTANA AND CAMPBELL COUNTY, WYOMING
BY
COLORADO SCHOOL OF MINES RESEARCH INSTITUTE
1979**