

OPEN-FILE REPORT
This report has not been edited for conformity with
U.S. Geological Survey editorial standards or
stratigraphic nomenclature.

EXPLANATION

8
6

ISOPACHS OF THE COAL BED—Showing thickness, in
feet. Isopach interval 2 feet, with an intermediate 5-foot
isopach.

3000
3040

STRUCTURE CONTOURS—Drawn on the top of the coal
bed. Contour interval 40 feet (12.2 m). Datum is mean
sea level.

4
3100

DRILL HOLE—Showing thickness and altitude at the top of
the coal bed, in feet.

To convert feet to meters, multiply feet by 0.3048.

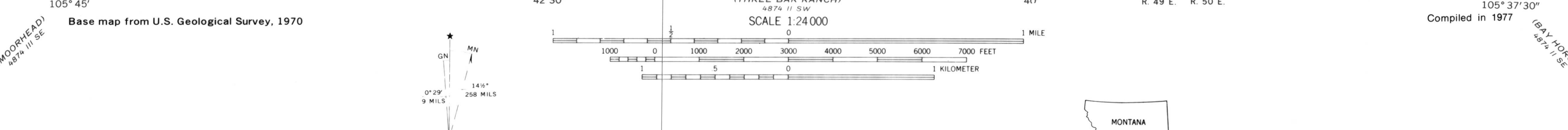
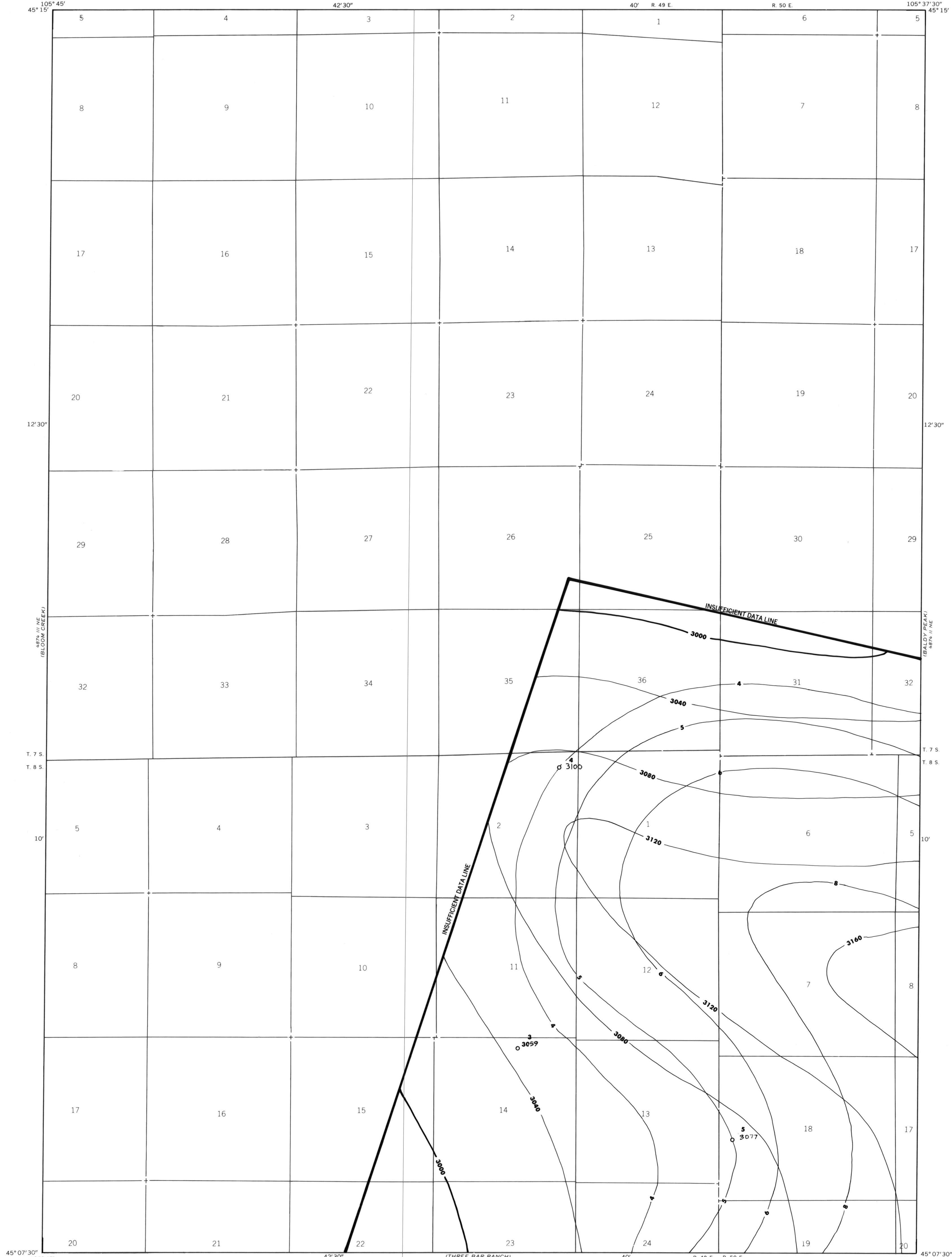

COAL RESOURCE OCCURRENCE MAP OF THE HUCKINS SCHOOL QUADRANGLE,
POWDER RIVER COUNTY, MONTANA
BY
COLORADO SCHOOL OF MINES RESEARCH INSTITUTE
1979