

OPEN-FILE REPORT
This report has not been edited for conformity with
U.S. Geological Survey editorial standards or
stratigraphic nomenclature.

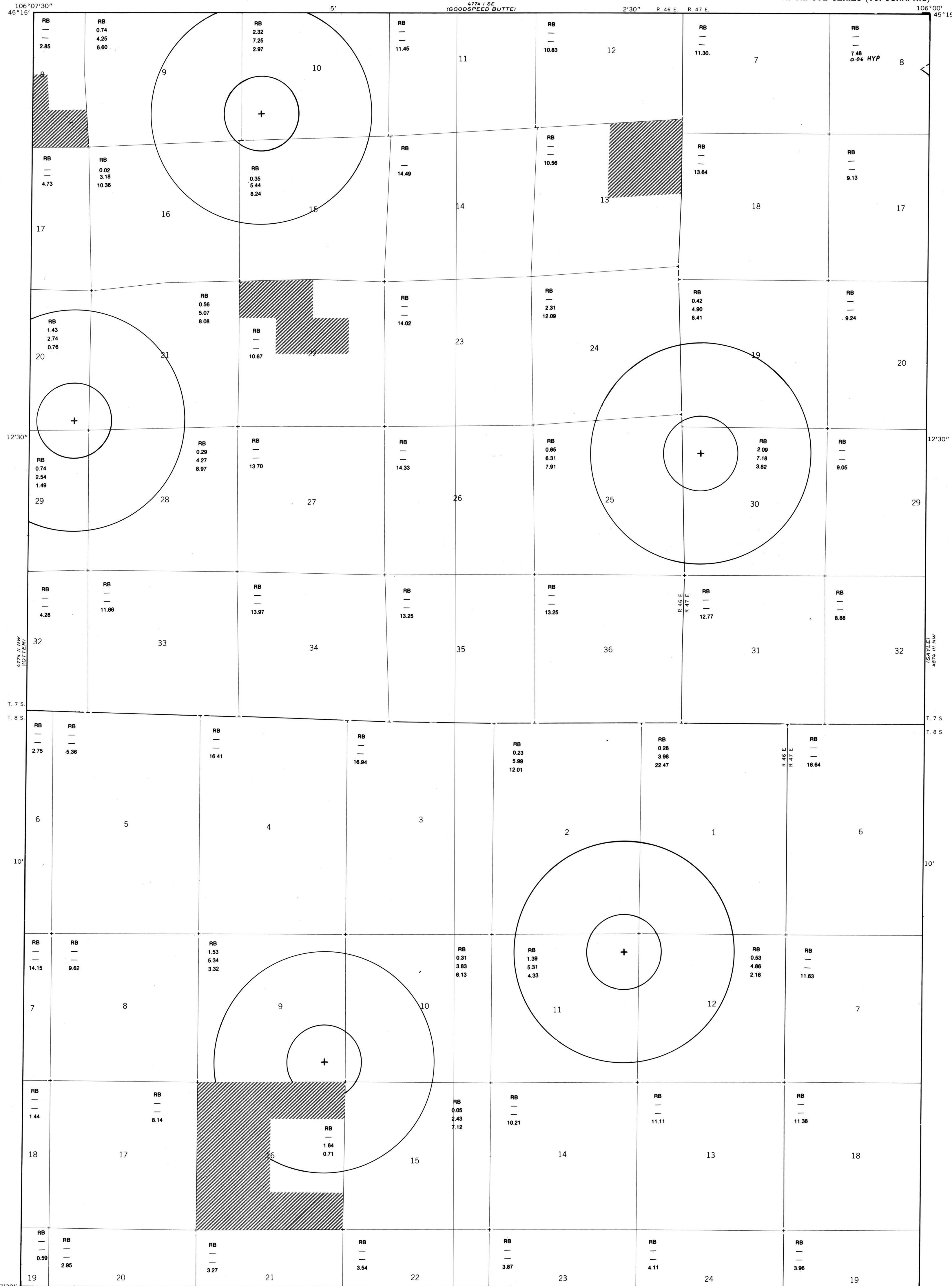

EXPLANATION



NON-FEDERAL COAL LAND— Land for which the
Federal Government does not own the coal rights



POINT OF MEASUREMENT ON COAL BED

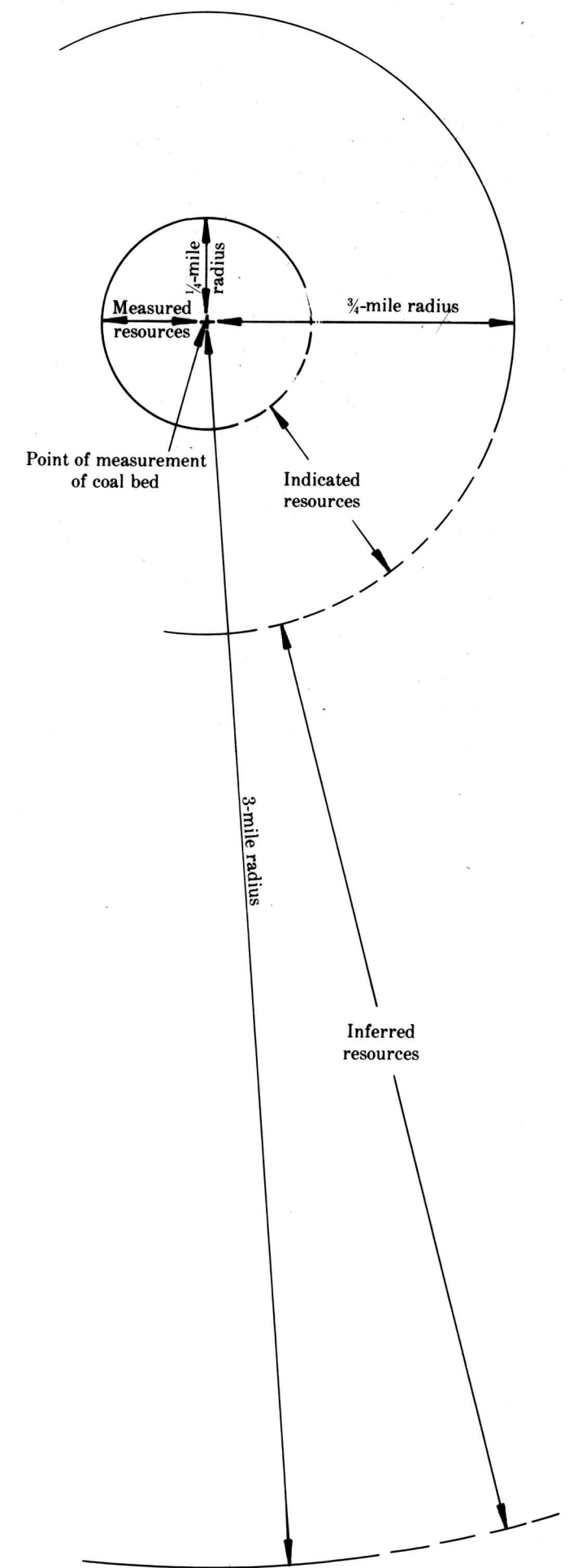

DIAGRAM SHOWING COMPONENT AREAS OF
IDENTIFIED COAL RESOURCES—Shows arcuate
boundary lines enclosing areas of measured, indicated,
and inferred coal resources. Boundaries of areas are
dashed where projected from an adjacent quadrangle.
Areas of measured, indicated, or inferred resources
may be present on this map without their outer
boundaries being shown. Coal resources beyond the
inferred category are hypothetical resources.

RB
— (Measured resources)
— (Indicated resources)
7.48 (Inferred resources)
0.06 HYP (Hypothetical resources)

IDENTIFIED AND HYPOTHETICAL COAL
RESOURCES—Showing totals for Reserve Base (RB)
and Hypothetical (HYP) resources, in millions of short
tons, for each section or part(s) of a section of Federal
coal land outside the stripping-limit line. Dash indicates
no resources in that category.

NOTE: No stripping-limit line is shown because there is
more than 500 feet of overburden above the coal that is
5 feet (1.5 m) or more thick.

To convert short tons to metric tons, multiply short tons by
0.9072.

To convert feet to meters, multiply feet by 0.3048.

To convert miles to kilometers, multiply miles by 1.61.

NOTE: Recovery factors have not been established for
underground development of coal in this quadrangle.
Therefore, Reserves (R) were not calculated for the coal
bed in areas outside the stripping-limit line.

Base map from U.S. Geological Survey, 1972

Compiled in 1977

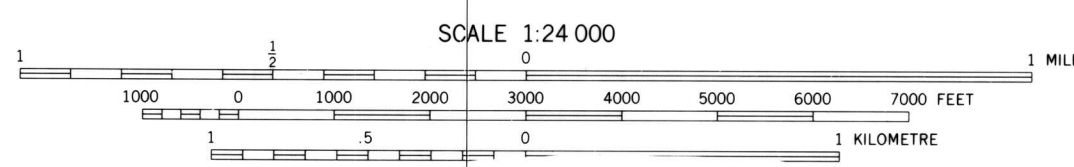
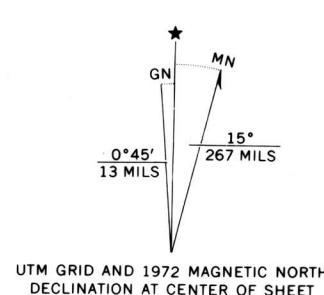

COAL RESOURCE OCCURRENCE MAP OF THE REANUS CONE QUADRANGLE,
POWDER RIVER COUNTY, MONTANA
BY
COLORADO SCHOOL OF MINES RESEARCH INSTITUTE
1979