

TOP

UNITED STATES
DEPARTMENT OF THE INTERIOR
GEOLOGICAL SURVEY

HORN CANYON QUADRANGLE
NEW MEXICO - SAN JUAN CO.
7.5 MINUTE SERIES (TOPOGRAPHIC)

OPEN FILE REPORT 79-797
PLATE 9 OF 11

EXPLANATION

4500
4600

STRUCTURE CONTOURS - Drawn on top of the Fruitland coal zone, which is coincident with the top of the Fruitland Formation. Contour interval 100 feet (30.5 meters). Datum is mean sea level. Contours dashed where projected through noncoal-bearing areas.

DRILL HOLE - Showing altitude at the top of the Fruitland coal zone, in feet.

To convert feet to meters, multiply feet by 0.3048.

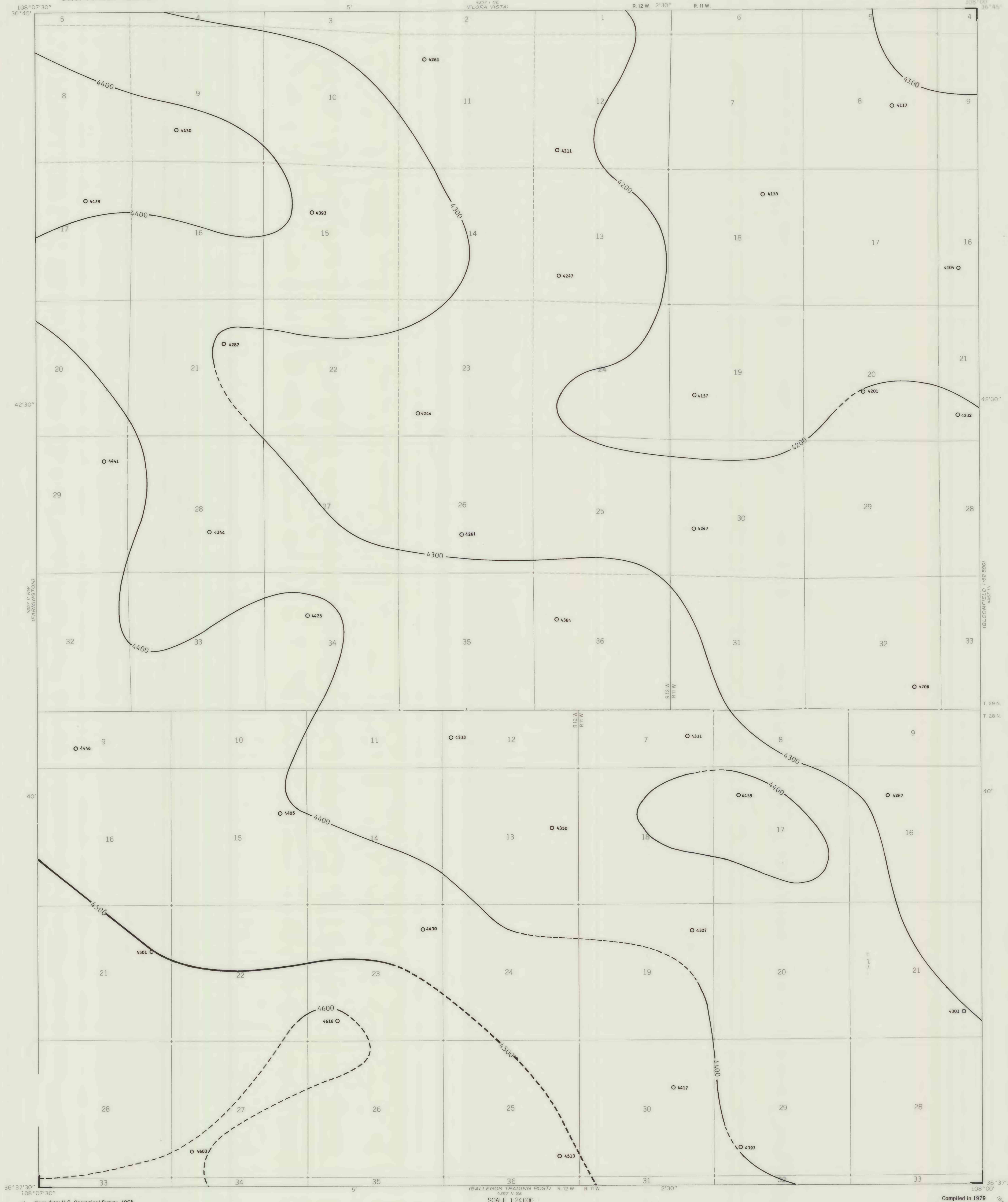

Base from U.S. Geological Survey, 1965

Compiled in 1979

COAL RESOURCE OCCURRENCE MAP OF THE HORN CANYON QUADRANGLE,
SAN JUAN COUNTY, NEW MEXICO

BY
DAMES & MOORE
1979

PLATE 9
STRUCTURE CONTOUR MAP
OF THE FRUITLAND COAL ZONE

This map was prepared under contract to the U.S. Geological Survey and has not been edited for conformity with Geological Survey editorial standards. Opinions and conclusions expressed herein do not necessarily represent those of the Geological Survey.