

EXPLANATION

- 3500 —
- 3600 —
- STRUCTURE CONTOURS - Drawn on top of the Fruitland 4 coal bed. Contour interval 100 feet (30.5 meters). Datum is mean sea level. Contours dashed where projected through noncoal-bearing area.
- 3522
- DRILL HOLE - Showing altitude at the top of the Fruitland 4 coal bed, in feet.
- To convert feet to meters, multiply feet by 0.3048.
- Fruitland coal beds contoured as a single surface on this map are equivalent in stratigraphic position but may not be continuous.

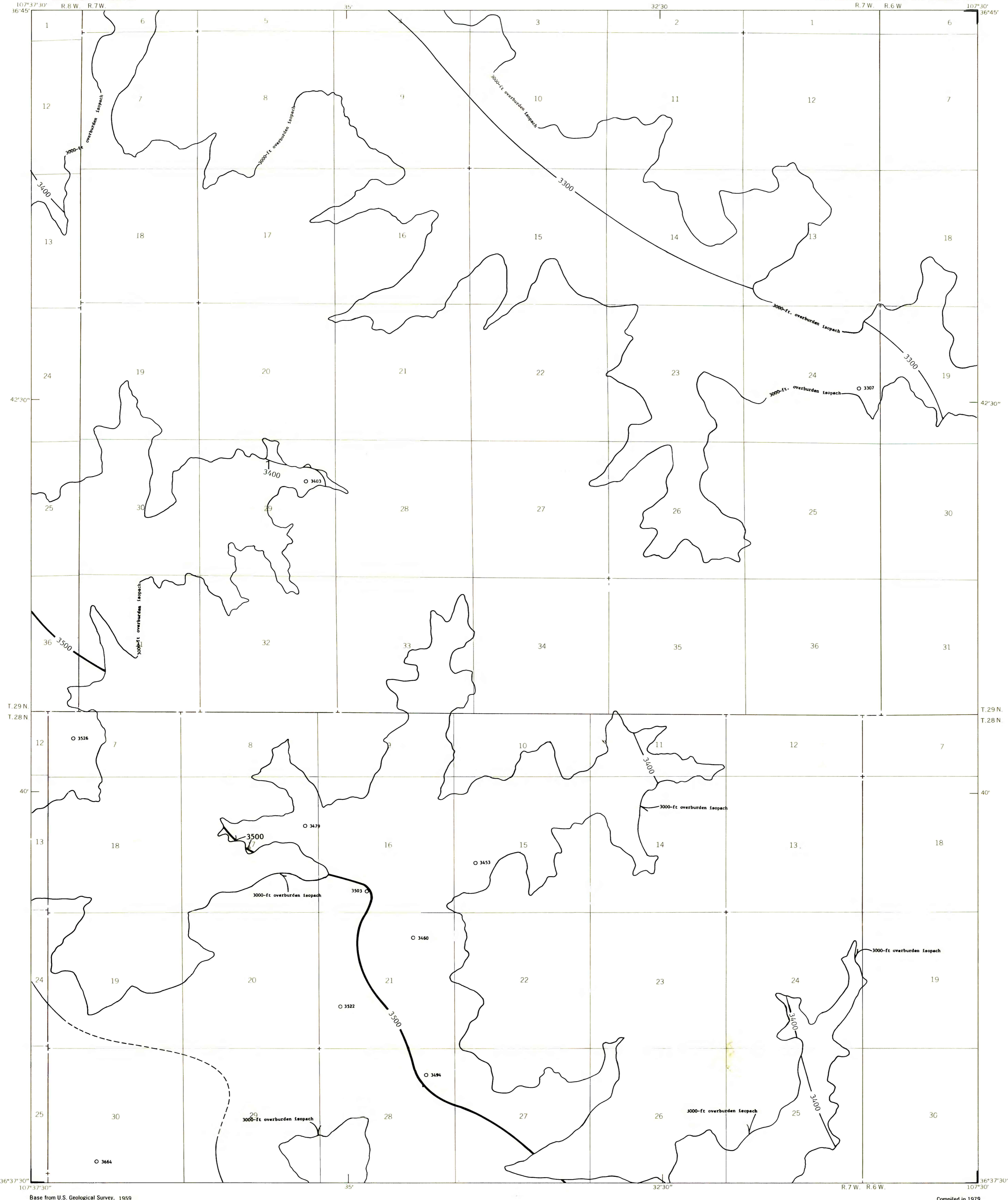

Base from U.S. Geological Survey, 1959

Compiled in 1979

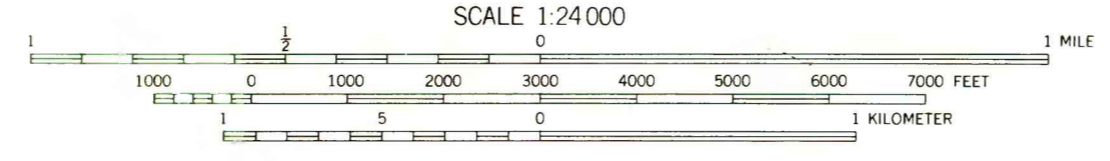

This map was prepared under contract to the U.S. Geological Survey and has not been edited for conformity with Geological Survey editorial standards. Opinions and conclusions expressed herein do not necessarily represent those of the Geological Survey.

**COAL RESOURCE OCCURRENCE MAP OF THE NORTHEAST QUARTER OF
THE GOULD PASS 15-MINUTE QUADRANGLE, RIO ARRIBA AND SAN JUAN COUNTIES, NEW MEXICO**

**BY
DAMES & MOORE
1979**

**PLATE 13
STRUCTURE CONTOUR MAP
OF THE FRUITLAND 4 COAL BED**