

EXPLANATION

- 9
- GL 6558
- R 644
- C 8(Bv)
- R 239
- C 20(E)
- R 9
- Section continues

COAL TEST HOLE - Showing drill-hole data, in feet. Index number refers to hole on plate 3 of CRO map or in table of text. Letters designate name of coal bed(s) as listed below.

- 3
- GL 6733
- NR 310
- R 428
- C 4(Bv)
- R 219
- C 8(E)
- Section continues

OIL AND GAS TEST HOLE - Showing drill-hole data, in feet. Index number refers to hole on plate 3 of CRO map or in table of text. Letters designate name of coal bed(s) as listed below.

3.8/1.2

INTERBEDDED COAL AND ROCK - Showing total coal thickness/total rock thickness.

- GL - Ground level elevation
- NR - No record
- R - Rock interval
- C - Coal interval
- TD - Total depth

TEST HOLE DATA SYMBOLS

- Bv - Blevins
- E - Emerson
- FU - Fort Union, undifferentiated
- La - Lance, undifferentiated
- FH - Fox Hills

COAL BED SYMBOLS AND NAMES - Coal beds identified by bracketed numbers are not formally named, but are numbered for identification purposes in this quadrangle only.

TRACE OF FAULT - Bar and ball on down-thrown side. Dashed where inferred.

To convert feet to meters, multiply feet by 0.3048.

REFERENCES

Bergin, M. J., 1959, Preliminary geologic map of the Maybell-Lay area, Moffat County, Colorado: U.S. Geol. Survey Open-File map, 1:48,000.

Muller, S. C., 1976, Lithologic and geophysical logs of seven holes drilled in 1975 in the Yampa and Danforth Hills coal fields, northwestern Colorado: U.S. Geol. Survey Open-File report 76-383.

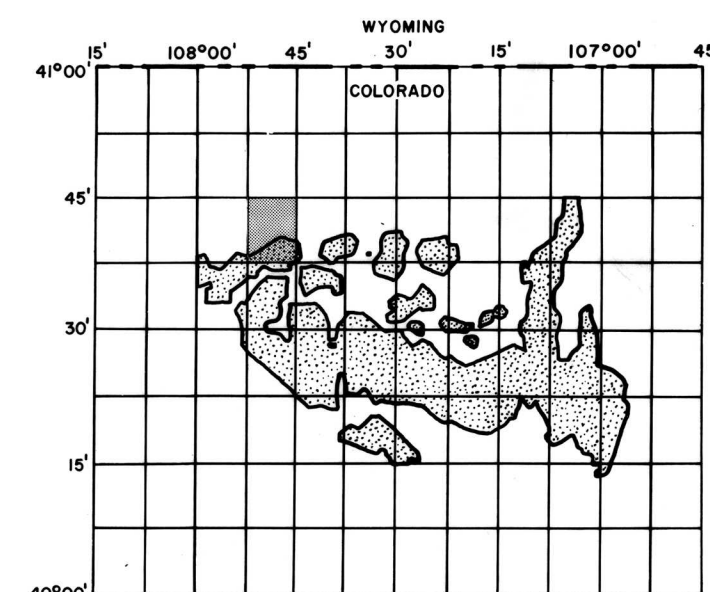
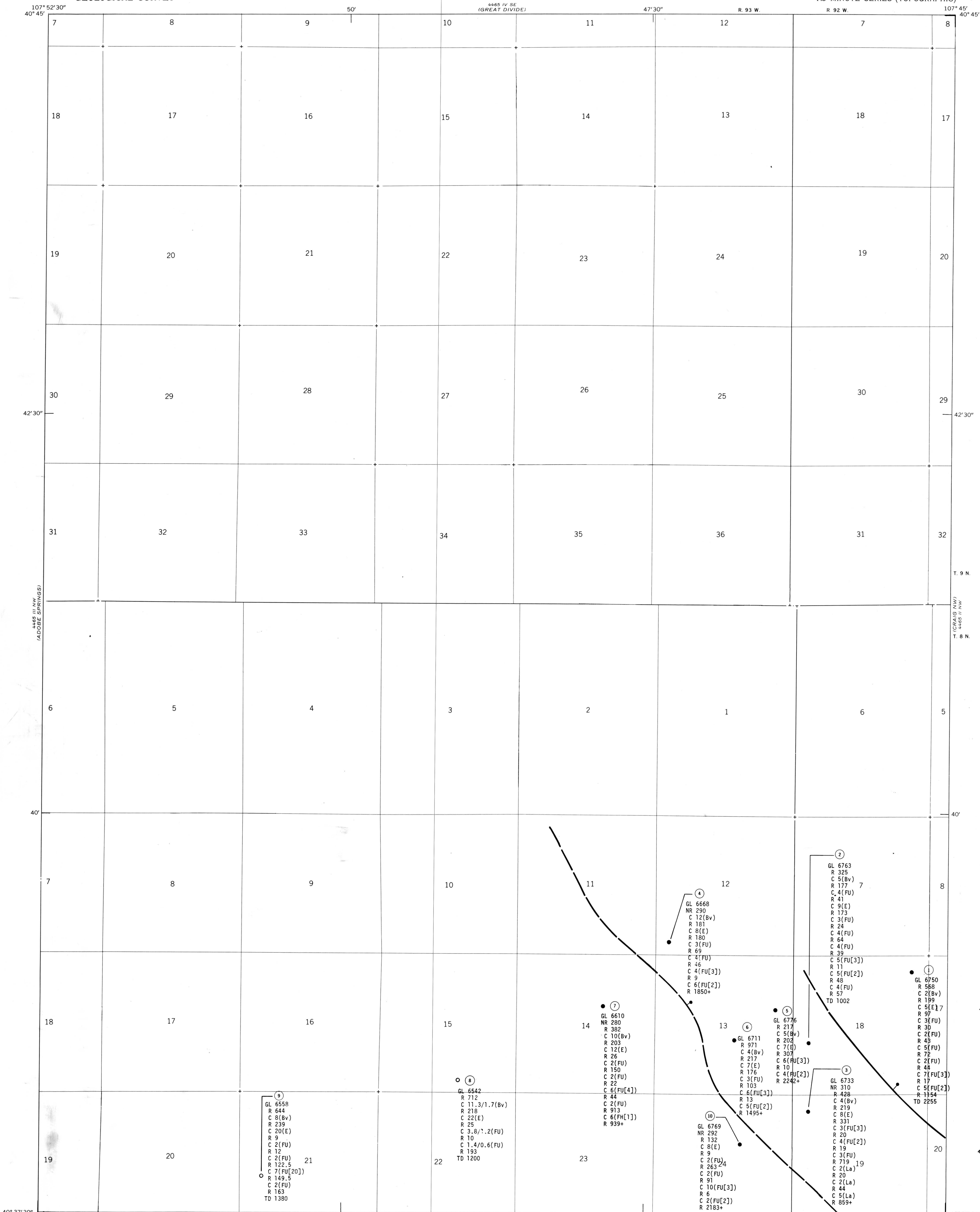

MAP SHOWING LOCATION OF THE IRON SPRINGS QUADRANGLE (SHADED) AND THE YAMPA KNOWN RECOVERABLE COAL RESOURCE AREA (STIPPLED), COLORADO

Base from U.S. Geological Survey, 1969

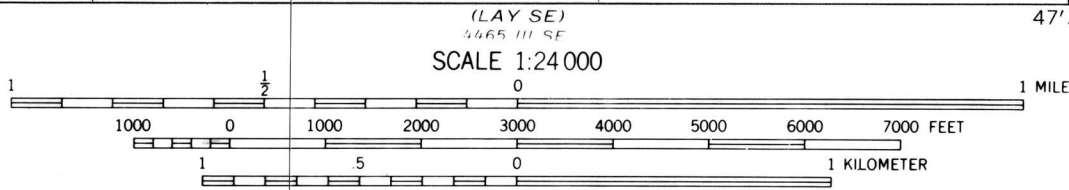

Compiled in 1977/1978

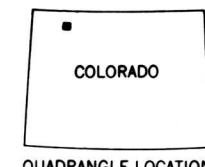
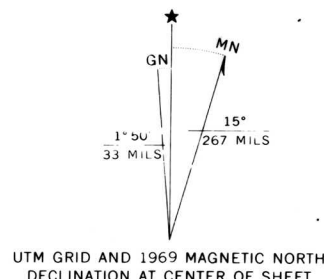

COAL RESOURCE OCCURRENCE MAP OF THE IRON SPRINGS QUADRANGLE, MOFFAT COUNTY, COLORADO

BY
DAMES & MOORE
1979

This report has not been edited for conformity with U.S. Geological Survey editorial standards of stratigraphic nomenclature.