

EXPLANATION

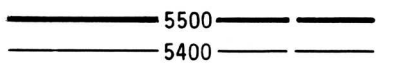

STRUCTURE CONTOURS - Drawn on top of coal bed. Solid where vertical accuracy within 40 feet; long dashed where vertical accuracy possibly not within 40 feet. Contour interval 100 feet (31 m). Datum is mean sea level.

○ 5230

DRILL HOLE - Showing altitude of top of coal bed, in feet.

FU[3] - Fort Union [3]

COAL BED SYMBOL AND NAME - Coal bed identified by bracketed numbers is not formally named, but is numbered for identification purposes in this quadrangle only.

-----▲FU[3]-----

TRACE OF COAL BED OUTCROP - Showing symbol of name of coal bed as listed above. Arrow points toward coal-bearing area. Short dashed where inferred by present authors.

-----▲-15°-----

SUBSURFACE MINING LIMIT - Showing areas where dip of coal bed is greater than 15° and subsurface mining by conventional methods is not considered feasible. Reserve base tonnages are calculated beyond limit; Reserve tonnages are not. Arrow points toward area where dips are greater than 15°.

TRACE OF FAULT - Bar and ball on down-thrown side. Dashed where inferred by present authors.

To convert feet to meters, multiply feet by 0.3048.

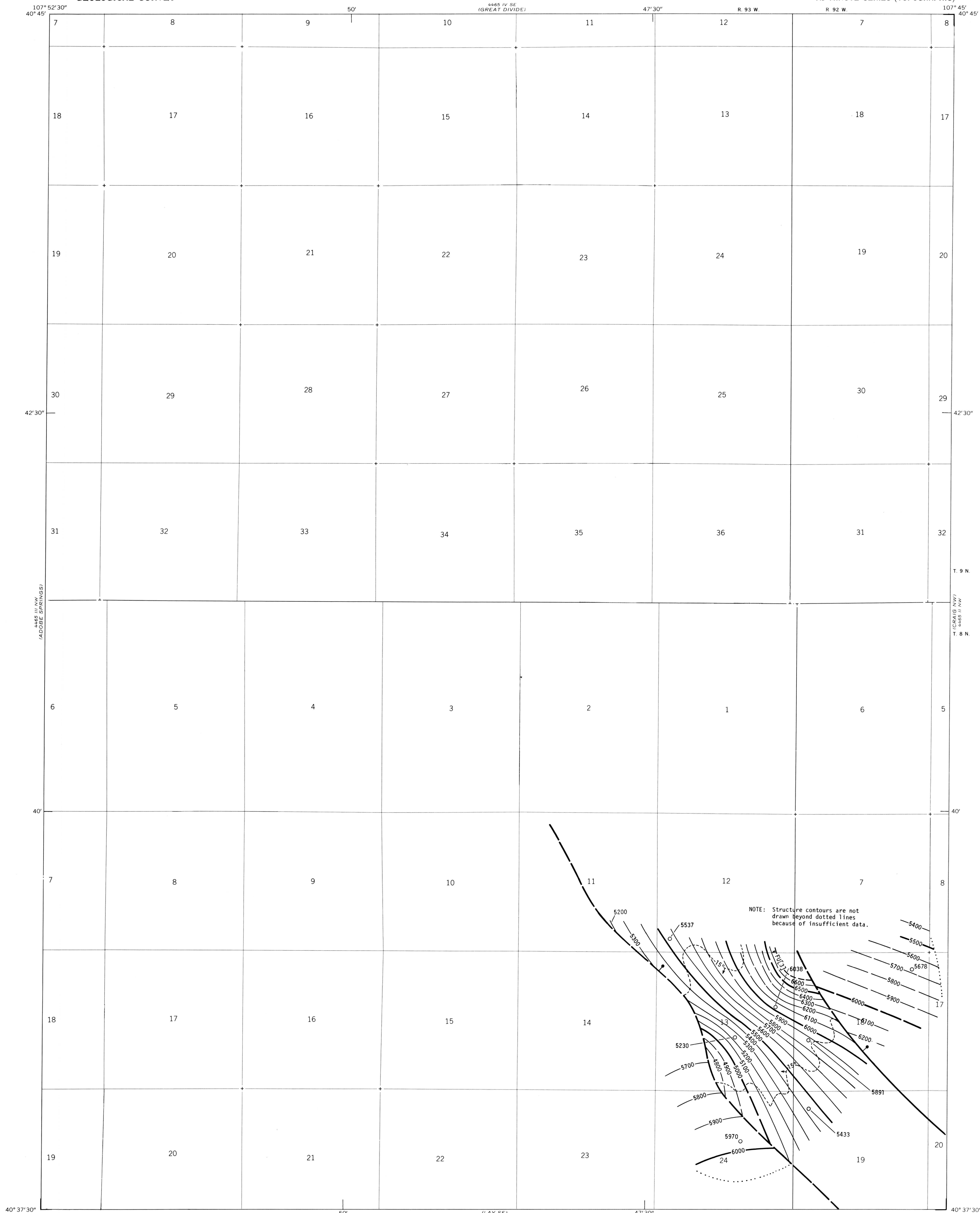

Base from U.S. Geological Survey, 1969. (LAY SE) 4465 11 SE (GREAT DIVIDE) SCALE 1:24000. Compiled in 1977/1978.

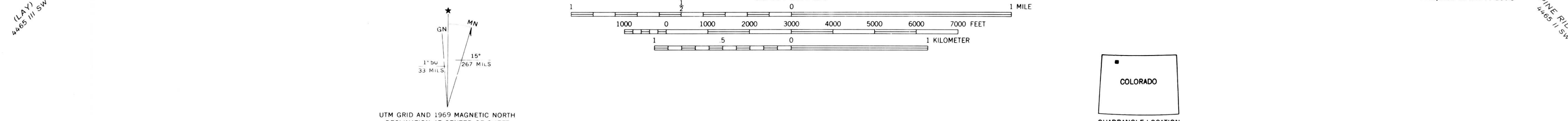

COAL RESOURCE OCCURRENCE MAP OF THE IRON SPRINGS
QUADRANGLE, MOFFAT COUNTY, COLORADO
BY
DAMES & MOORE
1979

This report has not been edited for conformity with U.S. Geological Survey editorial standards of stratigraphic nomenclature.