

EXPLANATION

800  
OVERBURDEN ISOPACHS - Showing thickness of overburden, in feet, from surface to top of coal bed. Dashed where vertical accuracy possibly not within 40 feet. Isopach interval 100 feet (31 m) over strip-pable coal and 200 feet (61 m) beyond the stripping-limit line.

○ 552  
DRILL HOLE - Showing thickness of overburden, in feet, from surface to top of coal bed.

10  
MINING-RATIO CONTOUR - Number indicates cubic yards of overburden per ton of recoverable coal by surface mining methods. Contours shown only in areas underlain by coal of Reserve Base thickness within the stripping-limit (in this quadrangle, the 200-foot-overburden isopach).

E - Emerson  
COAL BED SYMBOL AND NAME

TRACE OF COAL BED OUTCROP - Showing symbol of name of coal bed as listed above. Arrow points toward coal-bearing area. Short dashed where inferred by present authors.

TRACE OF FAULT - Bar and ball on down-thrown side. Dashed where inferred by present authors.

To convert feet to meters, multiply feet by 0.3048.

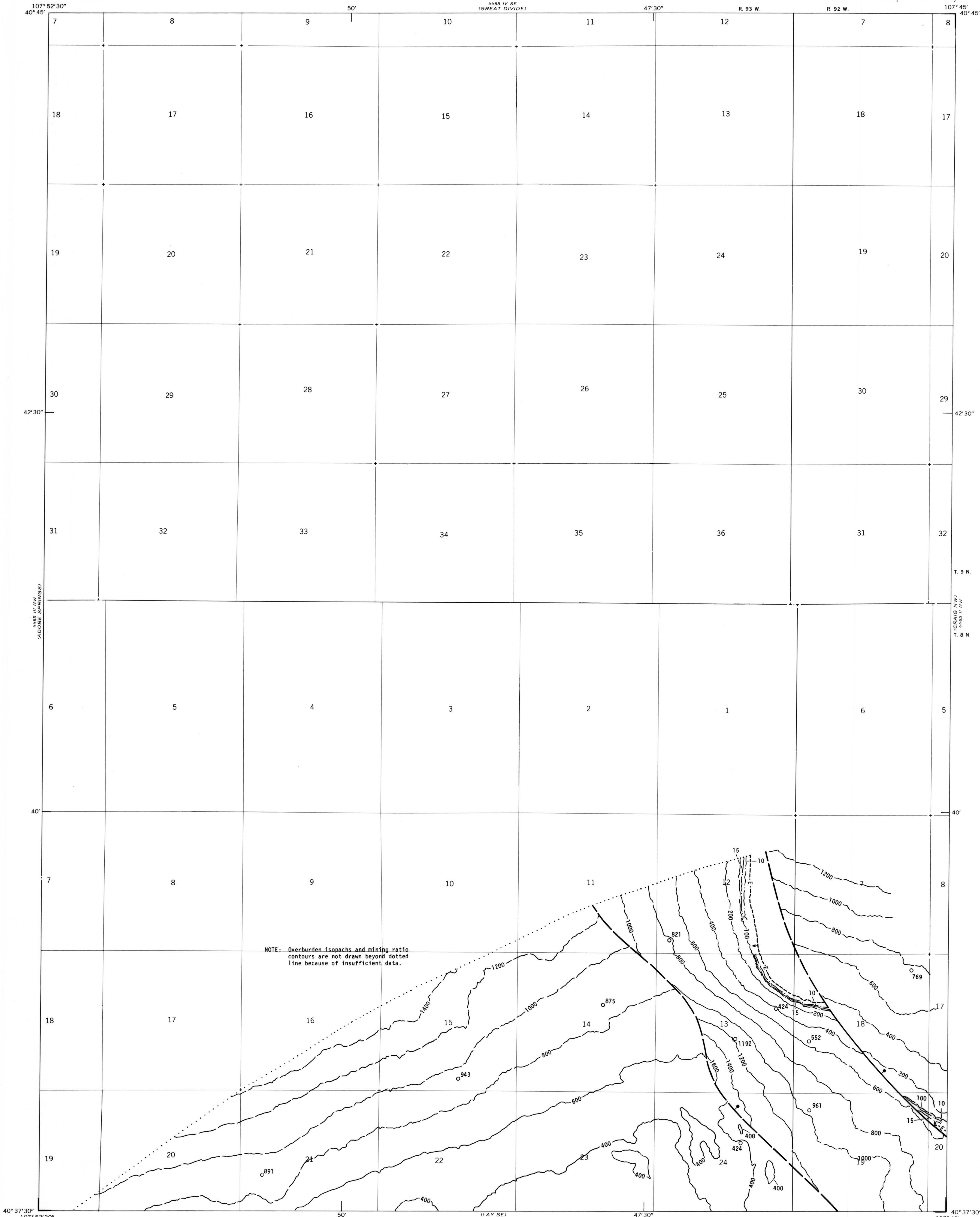

COAL RESOURCE OCCURRENCE MAP OF THE IRON SPRINGS  
QUADRANGLE, MOFFAT COUNTY, COLORADO

BY  
DAMES & MOORE  
1979

This report has not been edited  
for conformity with U.S. Geological  
Survey editorial standards of  
stratigraphic nomenclature.