

EXPLANATION

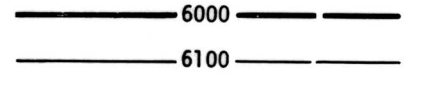

STRUCTURE CONTOURS - Drawn on top of coal bed. Solid where vertical accuracy within 40 feet; long dashed where vertical accuracy possibly not within 40 feet. Contour interval 100 feet (31 m). Datum is mean sea level.

5830

DRILL HOLE - Showing altitude of top of coal bed, in feet.

Bv - Blevins

COAL BED SYMBOL AND NAME

----- Bv -----

TRACE OF COAL BED OUTCROP - Showing symbol of name of coal bed as listed above. Arrow points toward coal-bearing area. Short dashed where inferred by present authors.

----- 15° -----

SUBSURFACE MINING LIMIT - Showing areas where dips of coal beds are greater than 15° and subsurface mining by conventional methods is not considered feasible. Reserve base tonnages are calculated beyond limit; Reserve tonnages are not. Arrow points toward area where dips are greater than 15°.

TRACE OF FAULT - Bar and ball on down-thrown side. Dashed where inferred by present authors.

To convert feet to meters, multiply feet by 0.3048.

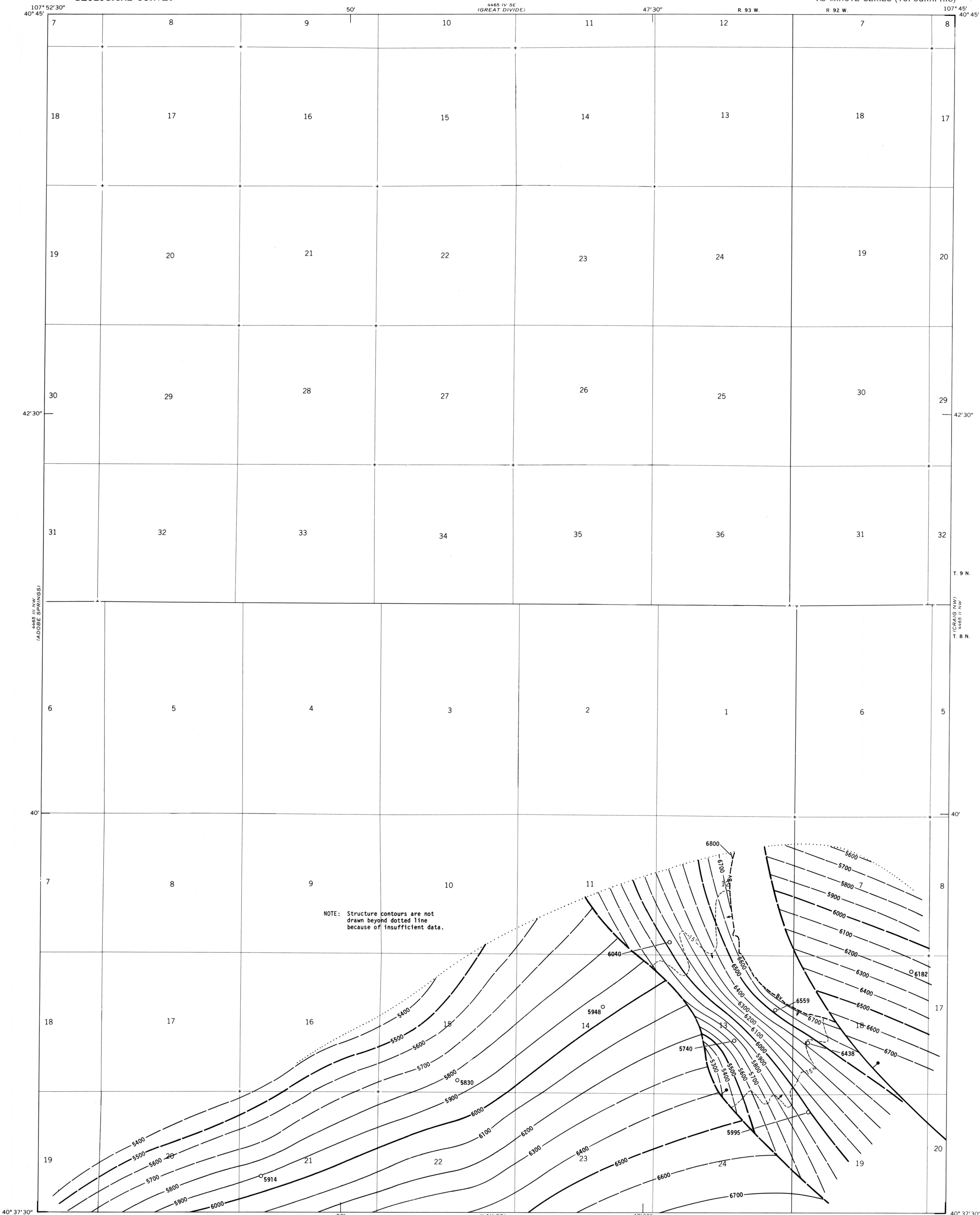

NOTE: Structure contours are not drawn beyond dotted line because of insufficient data.

Base from U.S. Geological Survey, 1969

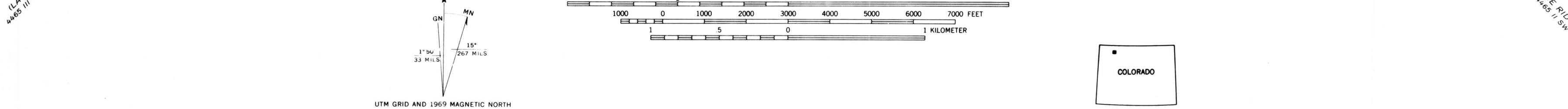

**COAL RESOURCE OCCURRENCE MAP OF THE IRON SPRINGS  
QUADRANGLE, MOFFAT COUNTY, COLORADO**  
BY  
**DAMES & MOORE**  
1979

This report has not been edited for conformity with U.S. Geological Survey editorial standards of stratigraphic nomenclature.