

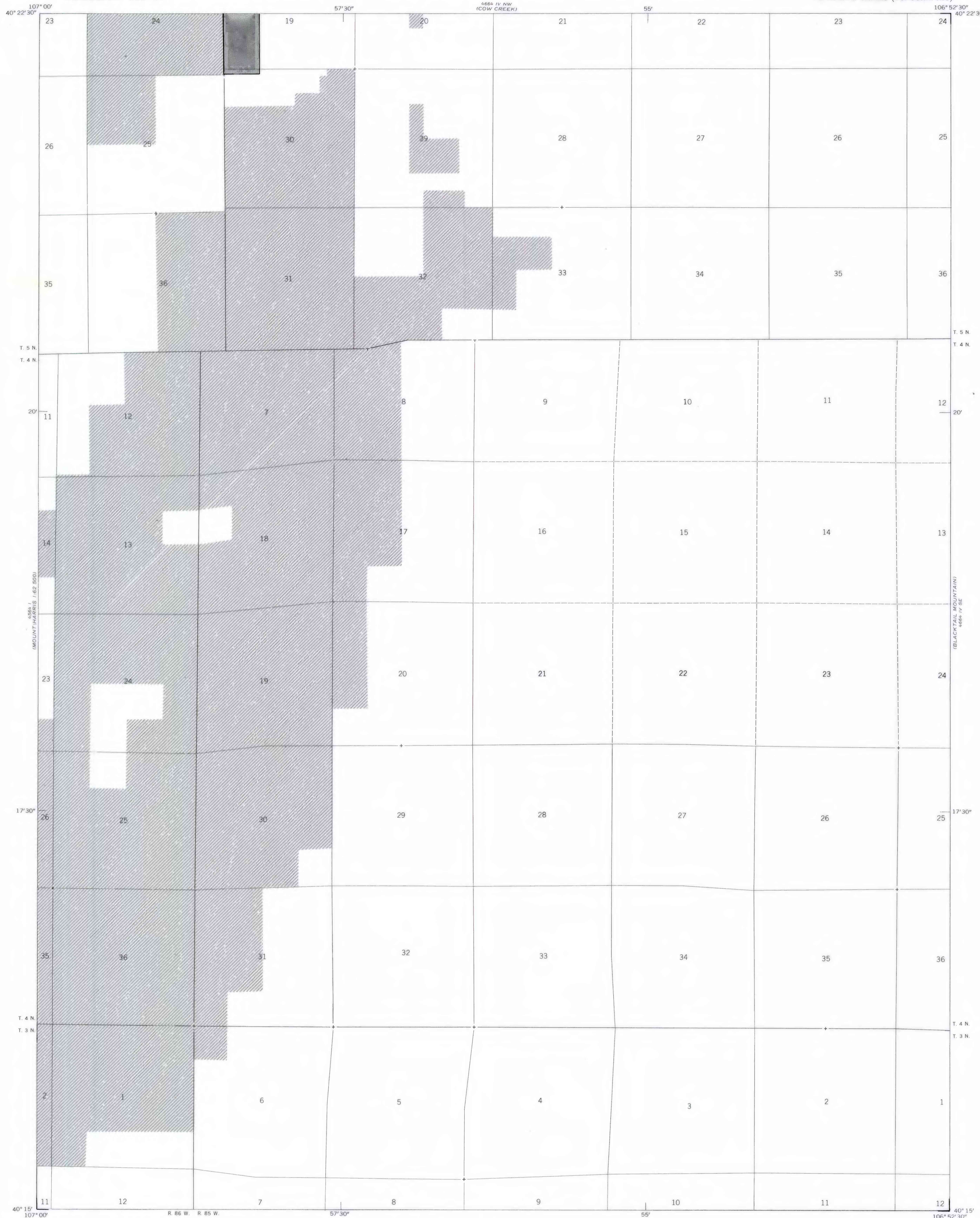

UNITED STATES  
DEPARTMENT OF THE INTERIOR  
GEOLOGICAL SURVEY

OAK CREEK QUADRANGLE  
COLORADO—ROUTT CO.  
7.5 MINUTE SERIES (TOPOGRAPHIC)

PLATE 22 OF 23



EXPLANATION

 NON-FEDERAL COAL LAND - Land for which the Federal Government does not own the coal rights, and for which the coal-development potential is not rated.

 AREA OF HIGH COAL-DEVELOPMENT POTENTIAL - Area has mining-ratio values ranging from 0 to 10.

 AREA OF UNKNOWN COAL-DEVELOPMENT POTENTIAL - Area contains no known coal in beds 5 feet (1.5 m) or more thick within 200 feet (61 m) of the surface, but coal-bearing units are present in the area.

Base from U.S. Geological Survey, 1969

Compiled in 1977/1978

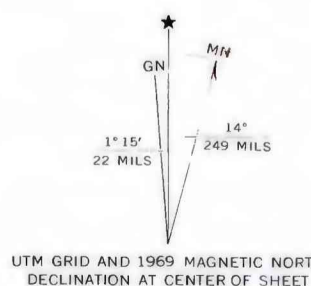

This report has not been edited for conformity with U.S. Geological Survey editorial standards or stratigraphic nomenclature.

**COAL DEVELOPMENT POTENTIAL MAP OF THE OAK CREEK  
QUADRANGLE, ROUTT COUNTY, COLORADO**  
BY  
**DAMES & MOORE**  
1979

PLATE 22  
COAL DEVELOPMENT POTENTIAL  
MAP FOR SURFACE MINING METHODS