

EXPLANATION

KRCRA  
KRCRA BOUNDARY—Label within KRCRA boundary.

NON-FEDERAL COAL LAND—Land within the KRCRA boundary for which the Federal Government does not own the coal rights.

CO86654  
COAL LEASE—Showing lease number.

RB 1.54

TOTAL RESERVE BASE (RB) OF FEDERAL COAL PER SECTION—In millions of short tons, calculated for each section of Federal land following the guidelines given in U.S. Geol. Survey Bulletin 1450-B. To convert short tons to metric tons, multiply short tons by 0.9072.

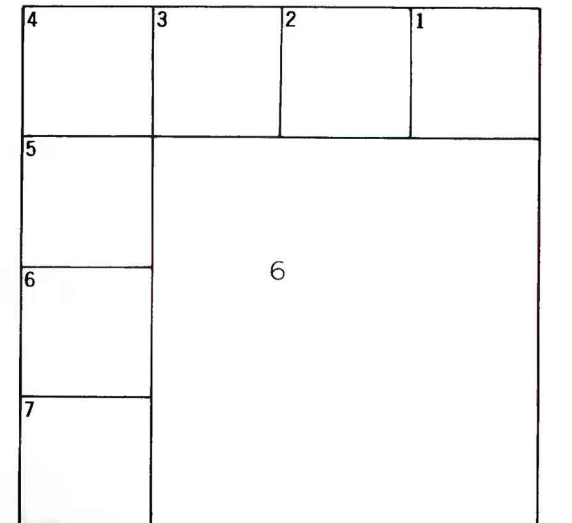

SECTION OF LAND—Showing lots and lot numbers.

NOTE: BLM Coal Ownership Data current as of July 15, 1977.

REFERENCE

U.S. Bureau of Mines and U.S. Geological Survey, 1976, Coal resource classification system of the U.S. Bureau of Mines and U.S. Geological Survey: U.S. Geol. Survey Bull. 1450-B, 7p.

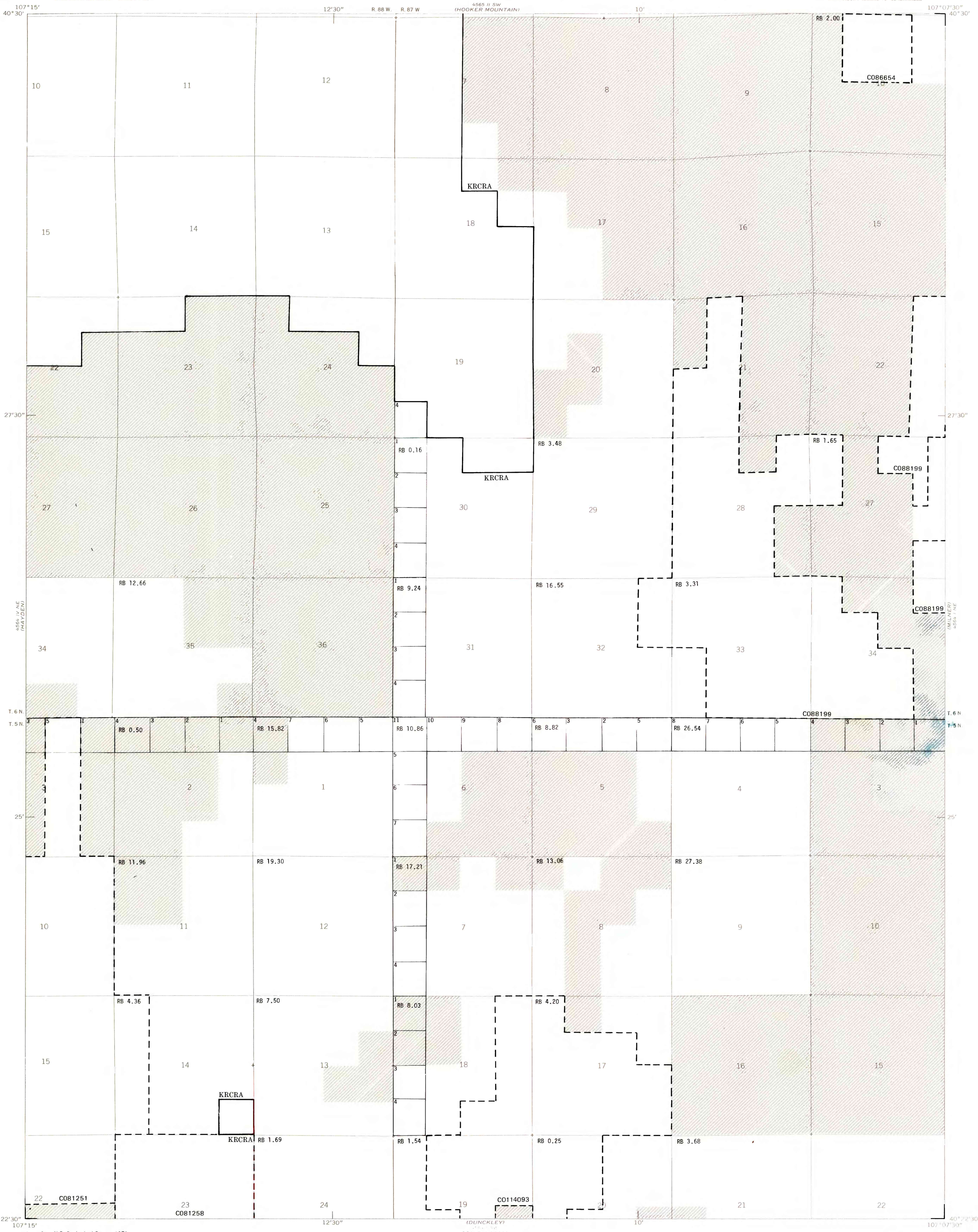

Base from U.S. Geological Survey, 1971

SCALE 1:24,000

Compiled in 1977/1978

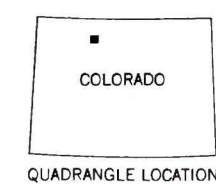
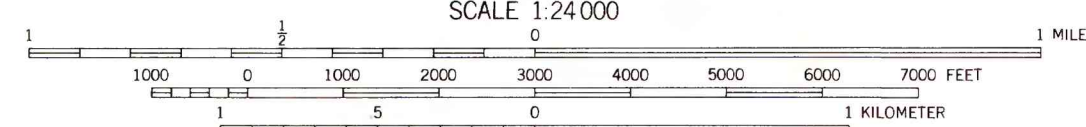
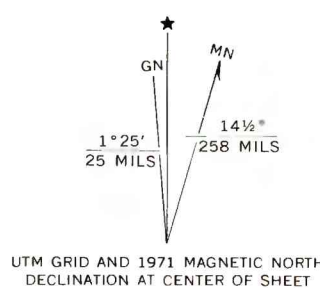

COAL RESOURCE OCCURRENCE MAP OF THE MOUNT HARRIS  
QUADRANGLE, ROUTT COUNTY, COLORADO

BY  
DAMES & MOORE  
1979

This report has not been edited for conformity with U.S. Geological Survey editorial standards or stratigraphic nomenclature.