

EXPLANATION

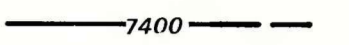

STRUCTURE CONTOURS—Drawn on top of coal bed. Solid where vertical accuracy within 40 feet; long dashed where vertical accuracy possibly not within 40 feet; short dashed where projected above land surface. Contour interval is 80 feet (24.1m).



DRILL HOLE—Showing altitude of top of coal bed, in feet. Drill holes which did not intersect top of coal bed or from which bed altitude could not be determined, are not shown.



POINT OF MEASUREMENT—Showing altitude of top of coal bed, in feet.

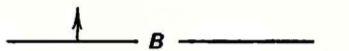

TRACE OF COAL BED OUTCROP—Showing symbol of name of coal bed. Arrow points toward coal-bearing area.

To convert feet to meters, multiply feet by 0.3048

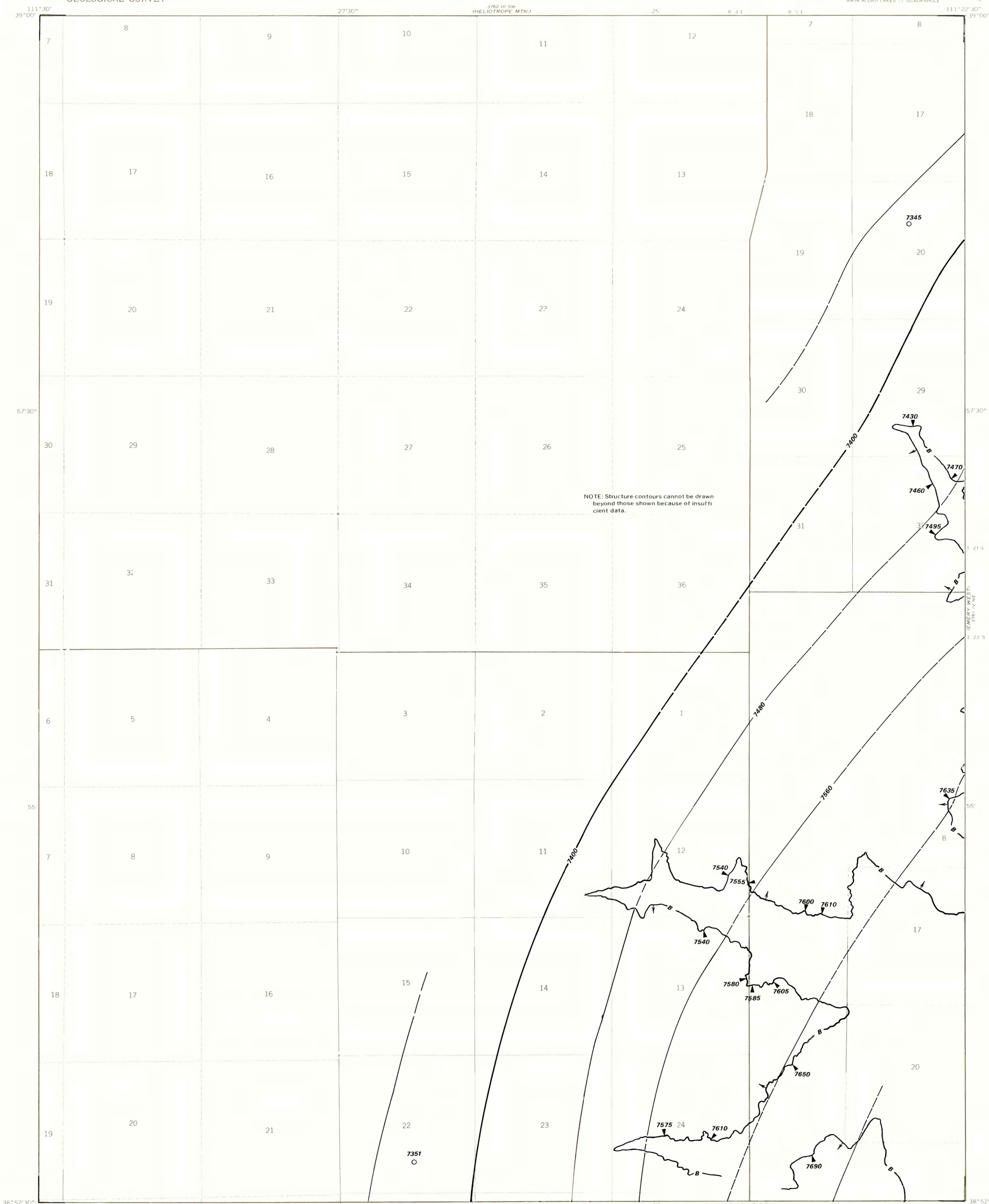

NOTE: Structure contours cannot be drawn beyond those shown because of insufficient data.

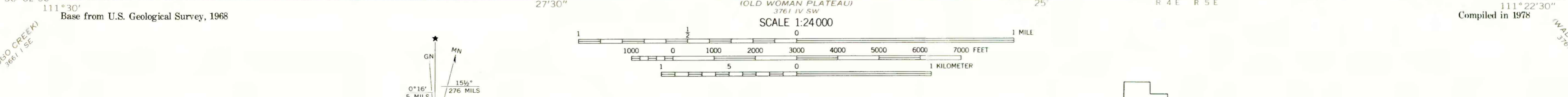

COAL RESOURCE OCCURRENCE MAP OF THE ACORD LAKES QUADRANGLE, SEVIER COUNTY, UTAH
BY
AAA ENGINEERING AND DRAFTING, INC.
1979